

Panasonic®

使用说明书
(家用) 电吹风
型号 EH-NA45

中文 3

English..... 15

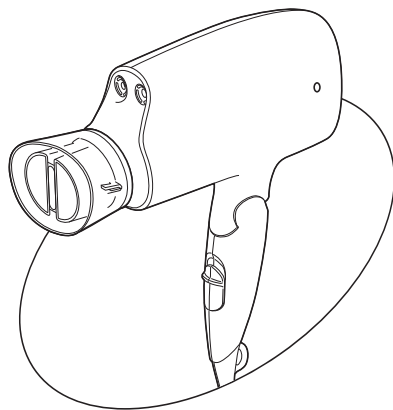

 **nanoe™**
纳米水离子

使用说明书 (家用) 电吹风 型号 EH-NA45

目录

安全注意事项	4	nanoe™ (纳米水离子) 感应板	10
部件名称	8	电吹风的保养	10
如何使用电吹风	9	故障排除	12
Panasonic nanoe™ (纳米水离子) 技术	9	规格	13
Panasonic 铂金负离子技术.....	10		

感谢您购买这款 Panasonic 产品。
在使用本产品前，请仔细阅读本说明书并妥善保管，以备将来参考。

nanoe™（纳米水离子）和 nanoe™（纳米水离子）
标记为松下电器产业株式会社商标。

nanoe™（纳米水离子）是被水包裹着的微粒子离子。

安全注意事项

为减少故障、触电、受伤、火灾、死亡以及设备或财产损坏的危险，请务必遵守以下安全注意事项。

标志说明

以下标志用于对因无视标志说明和使用不当而导致的危险、伤害和财产损失的程度进行分类和描述。



警告

表示可能会导致重伤或死亡的潜在危险。



注意

表示可能会导致轻伤的危险。

以下标志用于对需要遵循的说明的种类进行分类和描述。



此标志用于提醒用户注意禁止采取的操作步骤。



此标志用于提醒用户注意为了安全操作本产品而必须遵循的操作步骤。



警告



请勿存放在儿童和婴幼儿的接触范围之内。请勿让儿童和婴幼儿使用。

- 否则可能导致烫伤、触电或受伤。



请勿擅自改装、拆解或维修。

- 否则可能因运转异常而导致着火或人身伤害。

需要修理时，请咨询购买的销售店或联系 Panasonic 授权的维修中心进行维修。



请勿损坏或改装、或用力弯曲、拉拔或扭曲电源线。另外，请勿在电源线上放置重物或挤压电源线。

- 否则可能因短路而引发触电或火灾。



请勿在使用时缠绕电源线。

- 否则可能导致火灾或触电。

警告

存放时请勿将电源线紧紧缠绕在吹风机主体上。

- 否则可能导致电源线断线，发生触电，或由于短路而引发火灾。

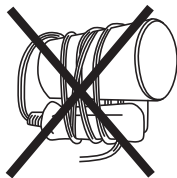

当电源插头或电源线损坏或发烫时，请勿使用。

- 否则可能因短路而引导致触电，受伤或因短路而引发火灾。

当电源插头没有在家用电源插座上插紧时，切勿使用本产品。

- 否则可能因短路而引导致触电，受伤或因短路而引发火灾。

请勿用湿手将电源插头插入家用电源插座，或从电源插座上拔下电源插头。

- 否则可能导致触电或受伤。

请勿用湿手操作本产品。

- 否则可能因短路而引发触电或火灾。

请勿在电源开关开启的情况下离开。

- 否则可能导致火灾。

请勿将本产品存放在浴室或湿度较大的位置。也不要将本产品放置在可能溅到水的位置（如卫生间台面）。

- 否则可能会导致触电或火灾。

请勿堵塞或将发夹或其它异物插入到入风口、出风口、nanoe™（纳米水离子）发射口或铂金负离子发射口。

- 否则可能导致触电、烫伤或火灾。

请勿在易燃物品（如酒精、汽油、稀释剂、喷雾剂、护发产品、指甲油去除剂）附近使用本产品。

- 否则可能引发爆炸或火灾。

请勿将本产品放入水中或往产品上浇水。

请勿在水边使用电吹风。

请勿在浴缸、淋浴间、洗脸盆或其它盛水器皿附近使用电吹风。

- 否则可能会导致触电或火灾。



电吹风上的该标志表示“请勿在水边使用电吹风”。

警告

如果发生异常和故障，请立即停止使用并拔下电源插头。

- 否则可能导致火灾、触电或受伤。

<异常或故障情况>

• 不出风

• 本机运转时断时续

• 内部发红发烫，并且开始冒烟

- 请立即咨询购买的销售店或联系 Panasonic 授权的维修中心进行维修。

请使用单独的家用电源插座：请勿使用电源延长线。

- 否则可能导致火灾或触电。

将电源插头完全插入到插座中。

- 否则可能导致火灾或触电。

请务必确保本产品的工作电压符合其额定电压。

- 否则可能导致火灾、触电或灼伤。

如果在使用热风档位时看到出风口出现火花，请停止使用，并去除出风口和入风口上的线头等物体。

- 否则将可能导致烫伤或火灾。

使用过后，务必关闭电源开关，并从家用电源插座上拔下电源插头。

- 否则可能导致火灾或烫伤。

拔下电源插头时，请捏住插头，不要拉扯电源线。

- 否则可能导致电源线断线，并可能因电源短路而导致灼伤、触电或火灾。

请定期清洁电源插头，防止灰尘积聚。

- 否则可能因潮湿造成绝缘故障，从而引发火灾。
请拔下电源插头，然后用干布擦拭。

在浴室内使用时，使用后拔下插头，因为即使电吹风断电后，接近水仍存在危险。

- 否则可能导致事故或受伤。

为了保障您的安全，建议在浴室供电的电气回路中安装一个额定漏电动作电流不超过 30 mA 的漏电保护装置（RCD）。向 RCD 安装商咨询。

- 否则可能导致事故或受伤。

警告



本产品不宜供肢体、感官或精神上有残疾者、或缺乏经验和知识者（包括儿童）使用，必须有监护者从旁监督并对本产品的使用加以指导，且对使用者的安全能承担责任。

请避免儿童将本产品视为玩具，从而引发危险。
- 否则可能导致事故或受伤。



如果电源线或插头损坏，为避免危险，请立刻停止使用，并联系 Panasonic 授权的维修中心进行更换。

- 否则可能导致事故或受伤。



请妥善处理本产品的包装袋，使其远离婴幼儿。
- 否则可能导致婴幼儿窒息等意外发生。

注意



存放电吹风时，请勿纠结电源线。

- 否则可能导致电源线断线，发生触电，或由于短路而引发火灾。



请勿跌落或受到冲击。

- 否则可能导致触电或着火。



请勿在入风口损坏的情况下使用。

- 否则您的头发可能吸进入风口内，从而损伤头发。



请勿触摸出风口、快干风嘴、集风嘴，因为它们会在使用过程中变得很烫。

- 否则可能导致灼伤。



请勿用于儿童或婴儿。

- 否则可能导致灼伤。

展开或折叠手柄时，请勿接触图中的阴影区域。

- 否则可能导致手指受伤。

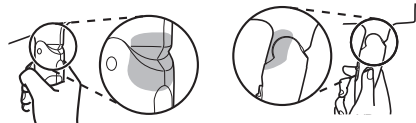

请小心留意吹风机的位置，确保您的头发距离入风口至少 10 cm。

- 否则您的头发可能吸进入风口内，从而损伤头发。



10 cm
以上



注意

出风口和头发之间请保持 3 厘米以上的距离。
- 否则可能会导致头发灼伤。



3 cm
以上



仅可用于吹干或定型人的头发。（不得用于宠物，
或用于吹干衣服、鞋子等。）
- 否则可能导致火灾或烫伤。

注意

- 电吹风配备有自动过热保护装置。电吹风如果过热，会切换到冷风模式。关闭电吹风，并从家用电源插座上拔出电源插头。先等待几分钟，让其冷却下来再使用。再次开机前，请先检查入风口和出风口是否粘有毛发等物。
- 在使用电吹风过程中，您可能会发觉有特殊气味。这是电吹风产生的臭氧引起的，但对人体无害。

部件名称

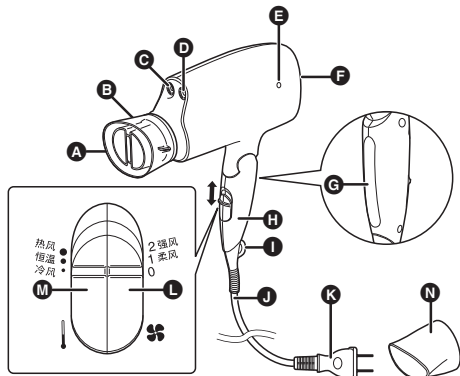

- A** 出风口
- B** 快干风嘴
- C** 铂金负离子发射口
- D** nanoe™ (纳米水离子) 发射口
- E** nanoe™ (纳米水离子) 指示灯
- F** 入风口
- G** nanoe™ (纳米水离子) 感应板
- H** 手柄
- I** 挂环
- J** 电源线
- K** 电源插头
- L** 电源开关 (☼)
2: 强风
1: 柔风
0: 关
- M** 温度选择开关 (|)
●: 热风
●: 恒温
●: 冷风
- N** 集风嘴
(风力更集中，易于吹干并打造发型)

► 快干风嘴

用于快速干发

连接快干风嘴，使出风口处于垂直状态。

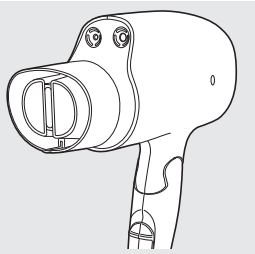

► 集风嘴

用于精确定型

如何使用电吹风

1 用温度选择开关选择气流的温度 (M)。

2 用电源开关选择气流的强度 (L)。

► 注意

- 如果使用冷风吹发时，请将电源开关 (L) 设置在“1”或“2”的位置，并将温度选择开关设置在“●：冷风”位置。
- 电源开关 (L) 切换到“1”或“2”位置时，将产生 nanoe™ (纳米水离子) 和铂金负离子。
- nanoe™ (纳米水离子) 和铂金负离子无法用肉眼看见。
- 请使用集风嘴 (N) 汇聚气流。

- 如果您担心发质受损，请在使用前将开关拨至“1：定型 (柔风)”位置。
- 使用过程中 nanoe™ (纳米水离子) 发射口 (D) 可能会吹出水珠，这不是故障。
- nanoe™ (纳米水离子) 发射口 (D) 可能会发出嗡嗡的响声，这是 nanoe™ (纳米水离子) 排出的声音，并非故障。
- 以下人群可能不易感受到 nanoe™ (纳米水离子) 的效果：小卷发、波浪卷、头发顺滑、短发的人士，或者过去三、四个月内做过矫直烫发的人士。
- 使用电吹风机时请勿在近距离处同时使用头发喷雾剂。头发喷雾剂的成分被吸入电吹风机，可能会影响电吹风机的性能。

Panasonic nanoe™ (纳米水离子) 技术

何谓 nanoe™ (纳米水离子)？

【nanoe™ (纳米水离子) 的产生方法：高压放电】
nanoe™ (纳米水离子) 是通过高电压来分离水分子而产生的带电净水粒子。其直径不到水蒸气的 1/100，肉眼无法看见。由于 nanoe™ (纳米水离子) 是通过收集空气中的水分而产生的，因此在某下情况下，由于环境不同，可能难以产生 nanoe™ (纳米水离子)。
(在寒冷干燥的地方较难收集空气中的水分)

nanoe™ (纳米水离子) 的作用原理

通常，头发本身的质地极易使其产生正电。这些特性强烈吸引带负电的 nanoe™ (纳米水离子) 渗入发丝。此外，nanoe™ (纳米水离子) 还使头发略带酸性、收紧毛鳞片，使头发更具健康光泽。

Panasonic 铂金负离子技术

何谓铂金负离子？

铂金负离子产生方法：高压放电

负离子是空气中带负电荷的氧气和水分结合而成的颗粒。铂金负离子是由铂金电极产生的离子。这些离子是肉眼无法看到的，因为其直径仅相当于蒸汽粒子直径的千分之一。

铂金负离子的作用原理

一般来说，头发很容易带正电荷。如果头发暴露在带有负电荷的铂金负离子中，既可消除头发中的静电，也能提高发质的柔顺性。而且铂金负离子还可渗入每一根每一缕头发中，将头发包裹住，从而保持头发的滋润，同时减低紫外线对发质的损害。

►注意

下述人不容易出现铂金负离子的效果

- 天然卷发的人
- 头发容易卷曲的人
- 发质本身很好，不易凌乱的人
- 负离子烫发未超过 3-4 个月的人
- 短发的人

nanoe™（纳米水离子）感应板

用 nanoe™（纳米水离子）/ 铂金负离子持续吹扫头发时，会使头发带上负电。因此，nanoe™（纳米水离子）/ 铂金负离子会和头发所带的负电荷相互排斥，使 nanoe™（纳米水离子）/ 铂金负离子难以接触到头发。有了 nanoe™（纳米水离子）充电系统，只需握着感应板手柄，即可释放头发上积聚的负电荷。因此，nanoe™（纳米水离子）/ 铂金负离子可以持续渗透到发芯，补充养，从发根滋润到发梢。

电吹风的保养

- 清洁前请确认已关闭电源开关并从家用电源插座上拔下电源插头。（出风口保养时除外）

电吹风的保养

只能用略蘸自来水或肥皂水的软布清洁机壳。

►注意

- 请勿使用稀释剂、汽油、酒精或其他化学制品。
 - 否则可能导致故障、部件破裂、褪色等。
- 放置电吹风时，如果仍有护发品或化妆品粘附在手柄或机身上，可能会使塑料降解，导致褪色或破裂以及故障。

nanoe™ (纳米水离子) 发射口的保养

- 使用市售的棉球。(我们建议您使用婴儿专用的细棉球。)
- 通过此项维护, 可以使电吹风长期保持产生的 nanoe™ (纳米水离子) 的效果。

1. 用自来水沾湿棉球的末端。

2. 针部位于 nanoe™ (纳米水离子) 发射口的深处。用棉球将针部轻柔地擦 5 次左右。



请勿试图去清洁铂金负离子发射口 (⊙)。(发射口禁止插入棉签进行清洁。) 否则会使丧失释放铂金负离子的能力。

入风口的保养

用纸巾清除入风口的毛发或其它异物。

- 请勿用指甲或其他尖锐物体按压或刮擦入风口。否则可能损坏入风口。

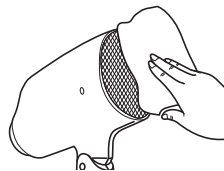

出风口的保养

- 仅在出风口保养时, 电吹风的电源插头应插在家用电源插座中。
- 使用市售的牙刷。
- 用牙刷擦拭时, 将温度选择开关拨到“冷风”, 吹掉灰尘等。
- 维护过程中, 不要用手或类似的东西堵塞入风口。
- 维护后初次使用电吹风时应当小心, 因其可能会吹出灰尘等。



故障排除

故障	可能原因	纠正措施
电吹风在“热风”模式下使用时会频繁切换到冷风模式，或可在电吹内看到火花。 (此类电火花是由防护装置恒温开关引起的，并非功能故障。)	▶ 入风口或出风口有线头积聚。 ▶ 头发或异物堵塞入风口。	▶ 去除积聚的线头。 ▶ 请勿堵塞入风口。
热风异常烫人。	▶	
电源插头异常发烫。	▶ 与家用电源插座的连接松动。	▶ 请使用插接牢靠的家用电源插座。
在 nanoe™ (纳米水离子) 发射口内产生火花。	▶	▶
nanoe™ (纳米水离子) 发射口发出噪音 (噼啪声)。	▶ 电极 (针头部分) 脏污引起的异常。	▶ 进行 nanoe™ (纳米水离子) 发射口维护。 ▶

如果按照以上方法还不能解决，请咨询购买的销售店或联系 Panasonic 授权的维修中心进行维修。

规格

产品名称	电吹风
产品型号	EH-NA45
额定电压	220 V~ 50-60 Hz
额定功率	1600 W
尺寸	226 (宽) × 84 (深) × 235 (高) mm
附件	快干风嘴, 集风嘴
原产地	泰国
生产日期	请见商品上刻印
执行标准	GB4706.1 GB4706.15 GB4343.1 GB17625.1

本产品仅适合家庭使用。

Operating Instructions (Household) Hair Dryer Model No. EH-NA45

Contents

Safety precautions	16	nanoe™ charge panel	23
Parts identification	21	Maintenance of the hair dryer	23
How to use the hair dryer	21	Troubleshooting	25
About nanoe™	22	Specifications	26
About platinum ions	22		

Thank you for purchasing this Panasonic product.

Before operating this unit, please read these instructions completely and save them for future use.

nanoe™ and the nanoe™ mark are trademarks of Panasonic Corporation.

A nanoe™ is a nano-sized ion particle coated with water particles.

Safety precautions

To reduce the risk of injury, loss of life, electric shock, fire, malfunction, and damage to equipment or property, always observe the following safety precautions.

Explanation of symbols

The following symbols are used to classify and describe the level of hazard, injury, and property damage caused when the denotation is disregarded and improper use is performed.



WARNING

Denotes a potential hazard that could result in serious injury or death.



CAUTION

Denotes a hazard that could result in minor injury.

The following symbols are used to classify and describe the type of instructions to be observed.



This symbol is used to alert users to a specific operating procedure that must not be performed.



This symbol is used to alert users to a specific operating procedure that must be followed in order to operate the unit safely.



WARNING

Do not store within the reach of children or infants. Do not let them use it.



- Doing so may cause burn, electric shock, or injury.

Never modify, disassemble, or repair.



- Doing so may cause ignition or injury due to abnormal operation.

Contact the store where you purchased the unit or contact a service center authorized by Panasonic for repair.

Do not damage or modify, or forcefully bend, pull, or twist the cord.



Also, do not place anything heavy on or pinch the cord.

- Doing so may cause electric shock or fire due to a short circuit.

Do not use with the cord bundled.



- Doing so may cause fire or electric shock.



WARNING

Do not wrap the cord tightly around the main body when storing.

- Doing so may cause the wire in the cord to break with the load, and may cause electric shock or fire due to a short circuit.



Do not use when the power plug or cord is damaged or hot.

- Doing so may cause burn, electric shock, or fire due to a short circuit.



Never use the appliance if the power plug fits loosely in a household outlet.

- Doing so may cause burn, electric shock, or fire due to a short circuit.



Do not connect or disconnect the power plug to a household outlet with a wet hand.

- Doing so may cause electric shock or injury.



Do not use the appliance with a wet hand.

- Doing so may cause electric shock or fire due to a short circuit.



Do not leave the area with the main switch left on.

- Doing so may cause fire.



Do not store the appliance in a bathroom or location with high humidity. Also, do not place in a location where water may spill (such as top of a vanity).

- Doing so may cause electric shock or fire.



Do not block, or insert hair pins or other foreign objects into the air inlet, air outlet, nanoe™ outlet, or platinum ion outlet.

- Doing so may cause fire, electric shock, or burn.



Do not use in proximity of flammable materials (such as alcohol, benzine, thinner, spray, hair care product, nail polish remover).

- Doing so may cause an explosion or fire.



Do not immerse the appliance in water.

Do not use this hair dryer near water.

Do not use this hair dryer near bathtubs, showers, basins or other vessels containing water.

- Doing so may cause electric shock or fire.



This symbol on the hair dryer means “Do not use this hair dryer near water”.



WARNING

Immediately stop using and remove the power plug if there is an abnormality or failure.

- Failure to do so may cause fire, electric shock, or injury.

<Abnormality or failure cases>



• **Air is not emitted**

• **Unit stops sporadically**

• **Interior becomes red hot and smoke is emitted**

- Immediately contact the store where you purchased the unit or contact a service center authorized by Panasonic for repair.



Use the household outlet alone: do not use with an extension cord.

- Failure to do so may cause fire or electric shock.



Fully insert the power plug.

- Failure to do so may cause fire or electric shock.



Always ensure the appliance is operated on an electric power source matched to the rated voltage indicated on the appliance.

- Failure to do so may cause fire, electric shock, or burn.



When you see sparks around the air outlet while using the hot air setting, stop use and remove the lint on the air outlet and air inlet.

- Failure to do so may cause burn or fire.



Always turn OFF the main switch and disconnect the power plug from the household outlet after use.

- Failure to do so may cause fire or burn.



Disconnect the power plug by holding onto it instead of pulling on the cord.

- Failure to do so may cause the wire in the cord to break, and may cause burn, electric shock, or fire due to a short circuit.



Regularly clean the power plug to prevent dust from accumulating.

- Failure to do so may cause fire due to insulation failure caused by humidity.
Disconnect the power plug and wipe with a dry cloth.



When the hair dryer is used in a bathroom, unplug it after use since the proximity of water presents a hazard even when the hair dryer is switched off.

- Failure to do so may cause an accident or injury.



For additional protection, the installation of a residual current device (RCD) having a rated residual operating current not exceeding 30 mA is advisable in the electrical circuit supplying the bathroom. Ask your installer for advice.

- Failure to do so may cause an accident or injury.



WARNING

This appliance is not intended for use by persons (including children) with reduced physical, sensory or mental capabilities, or lack of experience and knowledge, unless they have been given supervision or instruction concerning use of the appliance by a person responsible for their safety. Children should be supervised to ensure that they do not play with the appliance.

- Failure to do so may cause an accident or injury.

If the supply cord is damaged, it must be replaced by the manufacturer, its service agent, or similarly qualified persons in order to avoid a hazard.

- Failure to do so may cause an accident or injury.

Properly dispose the package of the appliance, keep the package away from infants.

- Failure to do so may cause suffocation of infants from happening.



CAUTION

Do not store the cord in a twisted state.

- Doing so may cause the wire in the cord to break with the load, and may cause electric shock or fire due to a short circuit.



Do not drop or subject to shock.

- Doing so may cause electric shock or ignition.



Do not use with the air inlet damaged.

- Your hair may get dangled in the air inlet, which could damage the hair.



Do not touch the air outlet, quick-dry nozzle, and set nozzle, which will become very hot.

- Doing so may cause burn.



Do not use on children or infants.

- Doing so may cause burn.

When unfolding or folding the handle, do not touch the shaded area as shown in figures below.

- Doing so may cause finger injury.

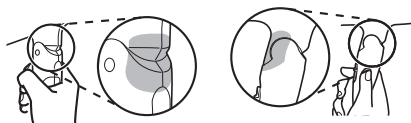



CAUTION

Be careful about where you point the hair dryer, and be sure to keep your hair at least 10 cm away from the air inlet.

- Your hair may get dangled in the air inlet, which could damage the hair.



Over
10 cm



Please keep a distance of over 3 cm between the air outlet and your hair.

- Failure to do so may result in your hair being burned.



Over
3 cm



Only use for drying or styling human hair. (Do not use on pets, or to dry clothing, shoes, etc.)

- Failure to do so may cause fire or burn.

► Notes

- This hair dryer is equipped with an automatic overheating protective device. If the hair dryer overheats, it will switch to cool air mode. Switch off the hair dryer and unplug it from the household outlet. Allow it to cool down for a few minutes before using it again. Check that no fluff, hair etc. is in the air inlets and air outlets before switching it on again.
- You may notice a characteristic odor when using this hair dryer. This is caused by the ozone it generates and is not harmful to the human body.

Parts identification

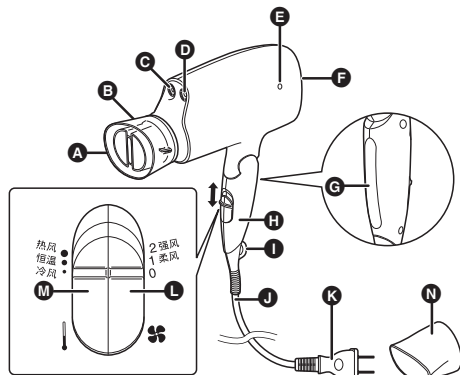

- A** Air outlet
- B** Quick-dry nozzle
- C** Platinum ion outlet
- D** nanoe™ outlet
- E** nanoe™ lamp
- F** Air inlet
- G** nanoe™ charge panel
- H** Handle
- I** Ring for hanging
- J** Cord
- K** Power plug
- L** Main switch ()
 - 2: Dry (Strong airflow)
 - 1: Set (Gentle airflow)
 - 0: Off
- M** Temperature selector ()
 - : Hot (Hot air)
 - : Healthy (Mild air)
 - : Cool (Cool air)
- N** Set nozzle

► Quick-dry nozzle

For drying hair quickly

Attach the quick-dry nozzle so this air outlet is vertical.

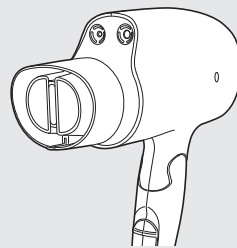

► Set nozzle

For precise styling

How to use the hair dryer

- 1** Select the temperature of the airflow with the temperature selector (**M**).
- 2** Select the intensity of the airflow with the main switch (**L**).

► Notes

- If you use cool air to dry your hair, set the main switch (**L**) to position “1” or “2” and set the temperature selector to the “● : Cool (Cool air)” position.
- nanoe™ and platinum ions are produced when the main switch (**L**) is set to position “1” or “2”.
- nanoe™ and platinum ions are invisible to the naked eye.
- Use set nozzle (**N**) to concentrate the airflow.
- If you are worried about hair damage, set the switch to “1: Set (Gentle airflow)” before use.

- Drops of water may blow out of the nanoe™ outlet (D) during use, but this is not a malfunction.
- A humming noise may come out of the nanoe™ outlet (D), but this is the sound of nanoe™ being discharged and is not a malfunction.
- The effects of nanoe™ might not be felt by the following people. People with crimped hair, strong curly hair, very smooth hair, short hair, or who have had a hair straightening perm in the last three or four months.
- Do not use sprays near the dryer while it is in operation. The contents of the spray may be sucked into the dryer, resulting in deterioration of performance.

About nanoe™

What is nanoe™?

(nanoe™ generation method: High-voltage discharge)
 nanoe™ is charged fine water particles, generated by applying high voltage in order to split water. Its diameter is smaller than 1/100 of steam, and it cannot be seen with the naked eye. Since nanoe™ is generated by collecting water in the air, it may be difficult to generate in certain cases depending on the environment. (It is harder to collect water in the air when it is cold and humidity is low.)

How nanoe™ works

Generally hair has properties which make it easy to become positively charged with electricity. These properties attract strongly negatively charged nanoe™ which penetrates the hair with moisture. Furthermore, they make the hair slightly acidic, tighten cuticles and keep your hair strong, elastic and healthy.

About platinum ions

What are platinum ions?

Platinum Ion Generation method: High-voltage discharge

Ions are particles that combine negatively charged oxygen and moisture in the air. Platinum ions are the ions generated from the platinum electrode. These ions are invisible to the naked eye because their diameter is just 1/1000th that of a particle of steam.

How platinum ions work

In general, hair is easily positively charged. By exposing hair to the negatively charged platinum ions, the hair's static electricity can be neutralized and thus its smoothness can be enhanced.

The platinum ions not only penetrate each and every strand of hair, but also coat the hair, and thus help it maintain the moisture content and alleviate the UV damage.

► Note

The effect of ion does not show up too much on person with features described below.

- Having original curl hair.
- Having hair to be furled easily.
- Having wonderful and tidy hair.
- Having hair straightening perm no more than 3 – 4 months.
- Having short hair.

nanoe™ charge panel

When nanoe™/platinum ions continue to strike hair, hair becomes negatively charged. As a result, the nanoe™/platinum ions and negatively charged hair repel each other, making it difficult for nanoe™/platinum ions to reach hair.

With the nanoe™ Charge System, by just gripping the panel together with the handle, the negative charge accumulated on hair is released.

Because of this, nanoe™/platinum ions continue to penetrate into hair, supplying moisture and thoroughly moistening down to the tips of hair.

Maintenance of the hair dryer

- Make sure to turn OFF the main switch and disconnect the power plug from the household outlet. (Except when performing maintenance on the air outlet)

Maintaining the hair dryer

Clean the housing only with a soft cloth slightly dampened with tap water or soapy tap water.

► Notes

- Do not use thinner, benzine, alcohol or other chemicals.
 - Doing so may cause malfunction, cracking/ discoloration of parts etc.
- Leaving the hair dryer with hair products or makeup still adhered to the handle or body may degrade the plastic, causing discoloration or cracking, and malfunction.

Maintaining the nanoe™ outlet

- Use commercially available cotton swabs. (We recommend the thin cotton swabs made for use with babies.)
- This maintenance allows the hair dryer to sustain the generated level of nanoe™ over a long period.

1. Dampen the end of the cotton swab with tap water.

2. A needle portion is located deep within the nanoe™ outlet. Using the swab, rub this portion gently about 5 times.

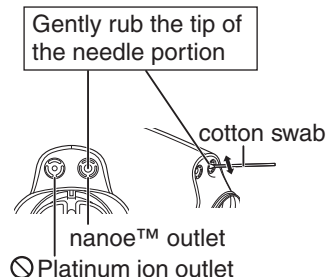

Do not attempt to clean the platinum ion outlet (⊙). (The outlet has a structure which makes it difficult to insert the swab.)
Doing so results in losing its ability to release platinum ions.

Maintaining the air inlet

Wipe to clean lint, hair, or other matter from the air inlet with a tissue.

- Do not press or rub the air inlet with a nail or other sharp object. Doing so may damage the air inlet.

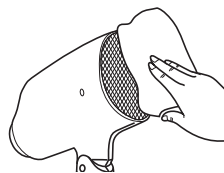

Maintaining the air outlet

- The hair dryer should be plugged into the household outlet only in case of maintenance for the air outlet.
- Use a commercially available toothbrush.
- Switch the temperature selector to “Cool” and blow away the dust etc. as you scrub with the toothbrush.
- During maintenance, do not block the air inlet with your hands etc.
- Be careful when using the hair dryer for the first time after maintenance, since it may blow out dust etc.

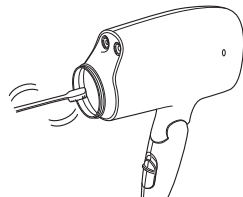

Scrub to remove any dust, hair etc. blocking the mesh.

Troubleshooting

Problem	Possible cause	Action
It switches frequently to cold air while using in "Hot" mode, or sparks can be seen within the body. (These sparks are caused by the thermostat switch, the protective device, and this is not a malfunction.)	▶ Lint has accumulated on the air inlet or air outlet. ▶ Hair or something is blocking the air inlet.	▶ Remove accumulated lint. ▶ Do not block the air inlet.
The hot air is abnormally hot.	▶ The connection to the household outlet is loose.	▶ Use a household outlet that fits securely.
The power plug is abnormally hot.	▶ Abnormality caused by a dirty electrode (needle portion).	▶ Perform maintenance of the nanoe™ outlet.
Sparks are generated inside the nanoe™ outlet.		
The nanoe™ outlet emits a noise (crackling noise).		

If the problems still cannot be solved, contact the store where you purchased the unit or a service center authorised by Panasonic for repair.

Specifications

Product name	Hair Dryer
Product model	EH-NA45
Power source	220 V ~ 50-60 Hz
Power consumption	1600 W
Dimensions	226 (W) x 84 (D) x 235 (H) mm
Accessory	Quick-dry nozzle, set nozzle
Place of origin	Thailand
Date of production	See engraving on the commodity.
Execution standard	GB4706.1 GB4706.15 GB4343.1 GB17625.1

This product is intended for household use only.

Panasonic

保修证

保修条款

有关保修期内 Panasonic 商品的保修（无偿修理），从购入之日起开始实施。

1. 保修期内的商品只可在 Panasonic 认定服务店进行保修；保修时，请出示本保修证及购机发票。

以下两点需特别注意：

- a. 本保修证遗失后不再补发，请妥善保管；
- b. 本保修证仅限于中华人民共和国内有效（香港、澳门、台湾三地区暂不可使用）。

2. 自购入之日起在以下期间内，在正常使用中发生故障的情况下进行保修。

- a. 整机 [除商用产品] 2年内无偿；
- b. 整机 [商用产品] 6个月内无偿；
- c. 附件 [内刀头、外刀网、刀头、辅助装置] 有偿提供。

3. 属下列情况之一者，即使在保修期内，也不能以保修对待，但是可以实行收费修理；

- a. 未按商品使用说明书要求使用、维护、保管而造成损坏的；
- b. 因不正确操作、电源不正常、破损（如：摔落等）而造成损坏的；
- c. 不经 Panasonic 认定服务店维修人员拆卸造成损坏的；
- d. 不能出示本保修证及有效购机发票的；
- e. 保修证上记录的信息与商品实物标识不符或者涂改的；
- f. 因不可抗力因素（如雷电、火灾、水灾等）造成损坏的。

4. 本保修条款只适用于消费者个人为生活消费需要而购买使用的场合，不适用于经营性等使用。

[商品信息]

商品名称: 电吹风 产 地: 泰国
商品型号: EH-NA45 制造编号:

【保修回执】 以下回执是保修的重要依据，请勿自行撕下

商品型号: EH-NA45

制造编号:

保修结算4

商品型号: EH-NA45

制造编号:

保修结算3

商品型号: EH-NA45

制造编号:

保修结算2

商品型号: EH-NA45

制造编号:

保修结算1

商品型号: EH-NA45

制造编号:

促销员留存

保修证管理编码印刷处:

[销售记录] 未完整记录以下信息将无法进行保修

销售日期:

发票号码:

销售店
(盖章)

顾客姓名:

联系电话:

顾客地址:

邮 编:

销售店名称:

销售店电话:

销售店地址:

邮 编:

[维修记录]

维修店名称:

联系电话:

送修日:

维修店地址:

邮 编:

故障内容:

故障原因:

维修内容:

维修员签字:

交验日期:

维修店名称:

联系电话:

送修日:

维修店地址:

邮 编:

故障内容:

故障原因:

维修内容:

维修员签字:

交验日期:

维修店名称:

联系电话:

送修日:

维修店地址:

邮 编:

故障内容:

故障原因:

维修内容:

维修员签字:

交验日期:

Panasonic 客户咨询服务中心:

400-810-0781

Panasonic 官方网站: <http://panasonic.cn>

松下电器(中国)有限公司

This image shows a full page of blank, lined paper. It features approximately 20 evenly spaced horizontal grey lines across its entire width, providing a template for writing or drawing. The margins are consistent on all sides.

[illegible]

[illegible]

制造商：松下电子制造(泰国)株式会社
Navanakorn Industrial Estate, Zone 3 No. 106 Moo 18, Khlong 1,
Khlong Luang, Pathum Thani 12120, Thailand

进口商：松下电器(中国)有限公司
北京市朝阳区景华南街5号 远洋光华中心C座 3层、6层

原产地：泰国