

Panasonic®

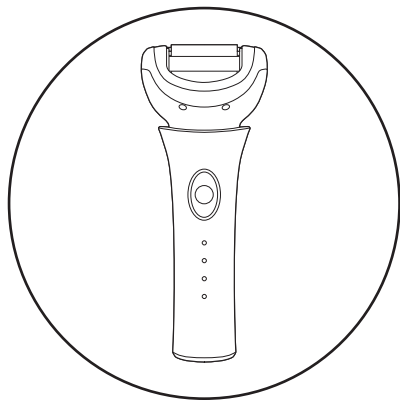

使用说明书

Operating Instructions

(家用) 面部按摩器

(Household) Facial Roller

型号

Model No. EH-SP30

中文	2
English	10

在使用本产品前，请仔细阅读本说明书并妥善保管，以备将来参考。

Before operating this unit, please read these instructions completely and save them for future use.

安全注意事项

为确保您正确使用本产品，请在使用前认真阅读所有安全注意事项。该安全注意事项能帮助您正确安全使用本产品，以免伤及您和他人以及带来财产损失。安全注意事项内容如下。

请谨遵该安全注意事项之相关规定！

⚠警告：

表示可能发生的危险情况，如不及时避免，严重时可能导致严重伤害甚至死亡。

⚠注意：

表示可能发生的危险情况，如不及时避免，严重时可能导致人身伤害或财产损失。

⚠警告：

- 本产品有内置式充电电池。请勿将其投入火中、加热、或者在高温处充电、使用或放置。
 - 否则会导致过热、着火或爆炸。
- 以下人士不宜使用本产品。
 - 有过敏体质或金属过敏等疾患者。
 - 有皮肤病、异位性皮炎或皮肤敏感者
 - 孕期或经期妇女（可能由荷尔蒙失衡而导致皮肤问题）
 - 有出血性疾病或血友病等血压异常者
 - 易生紫癜者
 - 心理能力欠佳者、或有麻痹或感觉异常者
 - 高度近视者（超过 -6D）
 - 有高血压者

- 有眼部疾患或有眼部治疗史的人士
- 如不遵守以上注意事项，可能会引发事故或导致皮肤或身体方面的问题。
- 如果有以下情况，请勿在相应的身体部位使用本产品。
 - 感觉不适时
 - 饮酒或服药后，或非常疲劳时
 - 皮肤或相应的身体部位有伤口、湿疹、脓肿、痤疮或化脓性疾病时
 - 皮肤或相应的身体部位有皮炎或极度晒伤等异常时
 - 同一天进行过脱毛的身体部位
 - 做过整容手术的身体部位
- 如不遵守以上注意事项，可能会引发事故或导致皮肤或身体方面的问题。
- 请勿使用已损坏、变热或与家用电源插座的连接松动的变压器。
- 请勿损毁、改装、用力弯折、拉拽或拧电源线。此外，请勿在电源线上放置重物或夹紧电源线。
 - 否则会导致触电或着火。
- 请勿改装本产品。此外，请勿拆卸或修理本产品。
 - 否则会导致着火、触电、烫伤或受伤。请联络 Panasonic 认定维修点进行维修（例如更换电池）。
- 请勿用湿手在家用电源插座上插拔变压器。
 - 否则会导致触电或短路。
- 请勿将变压器浸没于水中，或用水清洗。
 - 否则会导致触电或短路。
- 请勿在浴室内使用变压器。
 - 否则会导致触电或引起火灾。
- 请勿用于面部美容之外的任何其他用途。
- 只能在脸颊上使用，不得用于脸颊以外的部分。
- 如感觉疼痛或不适，请立即停止使用。

- 每天使用不要超过一次（3 分钟）。
- 对于初次使用者或皮肤敏感者，应缩短本产品的使用时间，密切观察皮肤有无异常变化。
 - 否则可能会造成事故或其他问题。
- 进行维护时，应从家用电源插座上拔出变压器插头。
 - 否则可能导致触电。
- 务必在与本产品的额定电压相符的电源上使用本产品。
 - 否则可能导致触电、烫伤或着火。
- 仅使用专用变压器对本产品充电。
 - 仅使用变压器对专用器具充电。
 - 否则可能会造成事故或其他问题。
- 不得用于额头、眼球、眼皮、耳廓、颈部。
 - 否则有可能损坏皮肤、身体。

⚠注意：

- 避免婴幼儿接触。
 - 否则可能会造成事故或其他问题。
- 如果本产品和变压器因跌落或碰撞等原因受到损坏，请勿使用。
 - 否则会导致受伤或故障。
- 请勿让别针或灰尘粘附到电源线插头上。
 - 否则会导致触电、短路或引发火灾。
- 不使用时，请从家用电源插座上拔出变压器。
 - 否则，可能会因绝缘性能下降而导致触电或电气火灾。
- 拔出变压器时，请务必握住电源插头而非电源线。
 - 否则可能导致触电或短路，引发火灾。
- 使用时应将头发扎到后面，或者用束发带或发夹固定头发。
 - 否则，头发可能会被卷入滚轮。

- 请将本体的正面侧接触皮肤。
 - 否则有可能卷入皮肤。
- 器具使用后应进行清洁，以避免油脂及其它残余物的积聚。

重要事项

► 为本产品充电

- 充电时如果电视机或其他电器受到干扰，请使用其他家用电源插座对本产品充电。
- 推荐的充电温度为 15-35℃。如果环境温度与推荐的充电温度相差很大，充电时间可能会增加到 3 小时左右，或根本无法充电。
 - 尤其是在低温下充电时，充电电池的使用寿命可能会缩短；因此，请在推荐的充电温度对本产品充电。
- 在温度过低的条件下（约 0℃ 或以下）充电时，可能无法充电。
- 购买后，3 个月内未使用本产品，或使用过程中滚轮转动停止时，请务必对本产品充电，直至充电显示 / 完成指示灯开始闪烁。（充电约 1 小时）
- 充电期间机身会略微变热，这并非故障。

► 使用本产品

⚠ 警告

有可能卷入头发，使用时请不要靠近头发。

- 本产品可在湿式状态或干式状态下使用。下图符号表示适合用在洗澡或沐浴中。



- 每天使用不要超过一次（3 分钟）。
 - 使用过多时，可能因压迫过度而产生皮肤问题。
- 请在完全卸妆后使用。
- 皮肤状况可能因身体状况而异。请根据自己的皮肤状况使用。
 - 如感觉皮肤有皮疹、红肿或瘙痒等异常状况，请停止使用并咨询医生。
- 皮肤问题可能由压力、体质、内脏疾病或基础护肤品引起。请咨询医生。
- 如果在开始使用时感觉异常，或感觉皮肤状况异常，可缩短使用时间。
- 如果皮肤表面潮湿，滚轮可能无法顺利滑动，并可能粘到皮肤上。请调整滚轮在皮肤上推进的方式和力度或模式，或者在皮肤干燥后使用。
- 皮肤上有按摩油或面霜时，请勿使用本产品。否则可能削弱滚轮的效果或损坏滚轮。

- 本产品不宜供肢体、感官或精神上有残疾者、缺乏经验和知识者（包括儿童）使用，除非有人对此类人加以监督或者对本产品的使用加以指导，且对使用者的安全能承担责任。
请对儿童进行监督，避免其将本产品视为玩具，引发危险。
- 请不要使用除 RE7-46 变压器以外的任何电源线或变压器进行充电。
- 请妥善处理本产品的包装袋，避免婴幼儿窒息等意外发生；请置于儿童触摸不到的地方。

► 清洁本产品

- 进行清洁之前，请务必从家用电源插座和电源线插头上拔出变压器插头。
- 请勿使用稀释剂、汽油、酒精等擦拭机身。
 - 否则可能造成故障，或导致开裂或褪色。
 - 请使用浸有肥皂水的湿布擦干后擦拭。

► 存放本产品

- 请勿使用吹风机或风扇加热器烘干本机身。
 - 否则可能导致部件变形或故障。
- 请勿放置在高温处。
 - 否则会导致故障。
- 请勿放置在阳光直射处。
 - 否则，机身内部的防水橡胶会劣化，可能因防水性能丧失而导致故障。
- 使用后请存放于低湿度场所。
 - 如果放置在浴室等场所，可能会因机身内部结露或生锈而造成故障。

部件名称

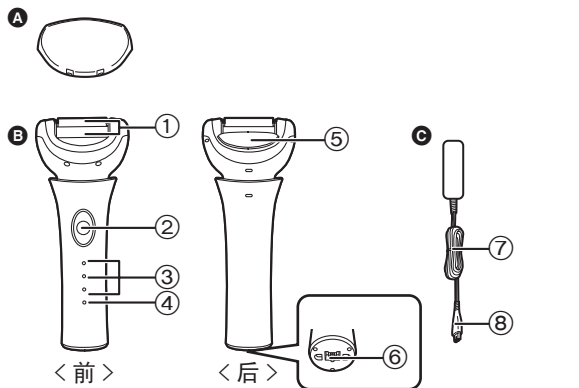

A 保护盖

B 机身

① 滚轮

② [0/1/选择] 按钮

③ 模式显示指示灯（绿色）

显示滚轮的转动速度。

高速 快
中速 标准
低速 慢

④ 充电显示 / 完成指示灯（红色）

⑤ 皮肤防护罩

防止皮肤卷起的安全防护装置。

⑥ 插口（底侧）

C 变压器 (RE7-46)

⑦ 电源线

⑧ 电源线插头

为本产品充电

充电时间：约 1 小时

- 本产品可使用 1 周左右，每天约使用 3 分钟。
- 根据使用方式的不同，使用时间可能会不同。

1 将电源线插头牢固插入机身的插口。

2 将变压器牢固插入家用电源插座。

充电中	⋮	亮
充电完成	⋮ ※	每秒闪烁一次。
充电完成 10 分钟后	⋮ ※	每 2 秒闪烁一次。

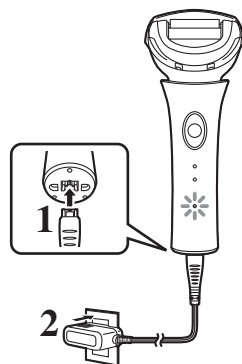

- 如果在操作过程中开始充电，操作将终止并开始充电。

3 充电完成后，从家用电源插座上拔出变压器，并从机身上拔出电源线插头。

电池使用寿命

每周充电一次大约可使用约 3 年。

此外，如果在充满电的情况下使用次数明显减少，则可能是电池使用寿命已尽。（根据使用方式和存放状况的不同，电池使用寿命会有明显改变。）

更换充电电池

更换电池时，请咨询您购买本产品的零售店或 Panasonic 认定维修点进行维修。如果尝试自行更换，可能会因防水功能受损而导致故障。

使用本产品

变压器、家用电源插座和本产品相连时，本产品不工作。充电后，请从机身上拔出变压器后使用本产品。

注意

- 除去所有饰品（项链、耳环等），以免发生饰品卡入本产品的危险。

有卷入头发的危险

- 用束发带或类似物品将头发向后扎起或固定，以免头发卷入滚轮。此外，即使头发较短，也要用发夹或类似物品固定头发。
- 即使在浴室中使用，也要将头发扎到后面。
- 请特别注意耳朵前面的头发，因为这些头发容易被卷入。



如果头发被卷入

- 请关闭电源，慢慢地拉出头发。

1 取下保护盖，按一次 [0/1/ 选择] 按钮。

- “低速”亮起

2 按 [0/1/ 选择] 按钮选择模式。

- 从“低速”模式开始。
- 每次按 [0/1/ 选择] 按钮，模式切换如下：
“中速”→“高速”→“关闭”→“低速”。

检查皮肤状况的同时，使用自己喜欢的模式。

- 即便在操作过程中选择模式，本产品也会在 3 分钟后自动停止。

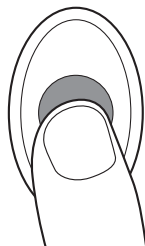

3 使 [0/1/ 选择] 按钮朝向自己握住机身，慢慢地滑过皮肤，不要施加过大的压力。

- 关于正确的使用方法，请参阅第 7 页。
- 如果压力过强，滚轮的转动可能会自动停止，电源也可能自动关闭，但这并非故障。请略微减小压力。



4 使用后，按 [0/1/ 选择] 按钮关闭电源。

- 使用美容液时，请根据皮肤状况使用自己常用的美容液。

- 连续使用 3 分钟后，操作将自动停止。

正确的使用方法

1 对皮肤略施加压力，按照箭头方向滑动。

按照①→②→③的顺序，从下颚骨向上滑动到颧骨底部各滑动3秒。

从嘴角到耳侧按④的方向慢慢地滑动3秒。

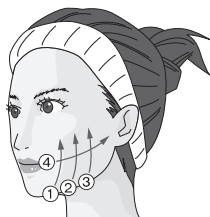

2 对另一侧脸颊进行相同的操作。

按照①→②→③的顺序，从下颚骨向上滑动到颧骨底部各滑动3秒。

从嘴角到耳侧按④的方向慢慢地滑动3秒。

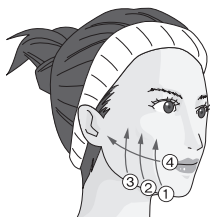

3 交替重复执行步骤1到2。

滚轮的使用方向

- 使[0/1/选择]按钮朝向自己握住机身。
- 成45度角贴到皮肤上，以免机身站立过度。



与皮肤接触不充分，效果减弱

滚轮的压力

- 以轻柔地滑过皮肤的方式使用。理想的力度是让滚轮平滑转动且皮肤轻微颤动。
- 如果力度过大，滚轮可能停止转动或主体会发出杂音。滚轮将不会顺畅地滑行，效果也会降低。
- 第一次使用本产品时，应施加特别轻柔的压力，然后再根据情况调整压力和模式。
- 调整压力，使滚轮不会咬入皮肤，或使机身不会振动过度。
- 为保护皮肤，下颚骨或颧骨周围应施加较低的压力（图中阴影部分）。
- 压力过强时，滚轮的转动可能会停止并会听到马达噪声。



清洁本产品

每次用完后都要清洗或擦净机身。

► 如何清洗机身

1 停止滚轮转动。

- 按几次 [0/1/ 选择] 按钮，直至模式显示指示灯熄灭。

2 清洗滚轮。

- 请勿使用热水（超过 70℃）或清洁剂。
- 如果滚轮上污垢过多，可使用牙刷进行清洁，或使用浸有肥皂水的湿布拧干后擦拭。

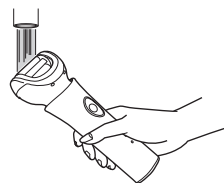

3 摇晃几下机身，甩出内部的水。

- 水可能会从滚轮周围的间隙流出，但这并非故障。

4 用卫生纸或棉签小心地擦掉机身或滚轮上的水，然后放在通风良好处晾干。

5 完全干燥后装上保护盖存放。

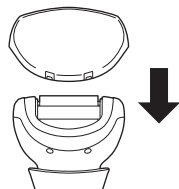

► 如何擦掉机身和变压器上的污垢

使用浸有肥皂水的湿布拧干后擦掉污垢。

取出内置充电电池

本产品内藏有可充电的电池，在消费者决定废弃本产品前，一定要事先将电池从本产品中取出。

- 分解本产品，取出电池前，一定要断开电源。
- 鼓励消费者在决定废弃本产品前，事前征求经销商或 Panasonic 认定维修点的意见，尽量延长本产品的使用寿命。
- 当消费者决定废弃本产品又不想自行分解本产品取出电池时，鼓励消费者将本产品送往 Panasonic 认定维修点，由 Panasonic 认定维修点对电池进行分解和回收。
- 电池务必废弃于政府规定的地方或回收处理单位。
- 请按下图所示的 ①～⑥ 顺序拆开本产品，卸下电池。
- 拆卸前应从本产品上拔出变压器插头。
- 按 [0/1/ 选择] 按钮打开电源，保持电源开启，直至电池完全放电。
- 请注意不要使电池短路。

- ① 卸下底盖上的 2 颗螺钉。
- ② 拆下底盖。
- ③ 卸下机壳的 2 颗螺钉。
- ④ 拆下机壳。
- ⑤ 取下电池垫。
- ⑥ 取出锂离子电池。

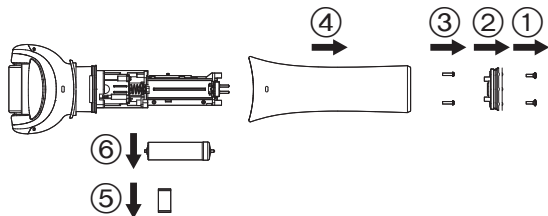

关于环境保护的重要通告

内置锂离子充电电池含有可能危害环境的物质。丢弃本产品之前，请取出电池。

为了环境保护和原材料的回收

本产品含有锂离子电池。

如果贵国有官方指定的电池处理场所，请务必到指定场所处理电池。

规格

产品名称	面部按摩器	
产品型号	EH-SP30	
变压器额定输入	100-240V~ 50-60Hz 180mA (自动电压转换)	
变压器额定输出	5.4V--- 1.2A	
本体工作电压	3.6V---	
额定功率	约 5W (充电时)	
充电时间	约 1 小时	
原产地	中国	
生产日期	请见商品上刻印	
执行标准	中国国家标准	GB4706.1 附录 B GB4706.10

本产品仅适合家庭使用。

Safety precautions

To ensure proper operation of this appliance, please read carefully all the safety precautions before use. The safety precautions are provided to help you with the correct and safe operation of this appliance so that you may avoid injuries to yourself and others as well as damage to property. The safety precautions are defined as follows.

ALWAYS FOLLOW THESE IMPORTANT SAFETY PRECAUTIONS!

WARNING:

This message indicates potentially hazardous actions and situations, which, if not avoided, could result in death or serious injury.

CAUTION:

This message indicates potentially hazardous actions and situations, which, if not avoided, could result in personal injury or property damage.

WARNING:

- This appliance has a built-in rechargeable battery. Do not throw into a fire, heat, or charge, use, or leave in a hot location.
 - Doing so could result in overheating, fire, or explosion.
- The following persons should not use this appliance.
 - Persons with allergic diathesis or metal allergies etc.

- Persons with skin diseases, atopic dermatitis, or sensitive skin
- Women who are pregnant or currently in a menstrual period (may cause skin trouble due to hormone imbalance)
- Persons with dysarteriotony such as hemorrhagic disease or hemophilia
- Persons that are prone to developing purpura
- Persons with reduced mental capabilities, or persons with paralysis or paresthesia
- Persons with strong myopia (over -6D)
- Persons with high blood pressure
- Persons with eye disorders or who have a history of eye treatment
- Failure to observe the above could result in accidents or problems with the skin or body.
- Do not use this appliance with the according body part or when you have the following conditions.
 - When you do not feel well
 - After drinking alcohol or taking medicine, or when you are very tired
 - When a wound, eczema, a gathering, acne, or a suppurative disease is present on the skin, or the according body part
 - When there are abnormalities on the skin such as dermatitis or extreme sunburn, or the according body part
 - Body parts where epilation was performed on the same day
 - Body parts where cosmetic surgery has been performed

- Failure to observe the above could result in accidents or problems with the skin or body.
- Do not use the adaptor when it is damaged, it becomes hot or the connection to the power outlet is loose.
- Do not damage, destroy, modify, forcefully bend, pull, or twist the power cord. Also, do not place heavy objects on or clamp the power cord.
 - Doing so could result in electric shock or fire.
- Never alter the appliance. Also, do not disassemble or repair it.
 - Doing so could result in fire, electric shock, burns, or injury. Contact the store where you purchased the appliance or Panasonic customer center for repair (such as battery change).
- Do not insert or pull the adaptor from the power outlet with wet hands.
 - Doing so could result in electric shock or short circuit.
- Do not immerse the adaptor in water, or wash with water.
 - Doing so could result in electric shock or shorting.
- Do not use the adaptor in the bath or shower room.
 - Doing so could result in electric shock or cause a fire.
- Do not use for any purpose other than facial beauty.
- Do not use on parts other than cheeks.
- Immediately stop using if pain or discomfort is experienced.
- Do not use more than once (3 minutes) per day.

- For first time users or people with sensitive skin, use the appliance for a shorter period of time and watch closely for any unusual changes in skin condition.
 - Failure to do so could result in accidents or other problems.
- Remove the adaptor from the power outlet when performing maintenance.
 - Failure to do so could result in electric shock.
- Always ensure the appliance is operated on an electric power source matched to its rated voltage.
 - Failure to do so could result in electric shock, burns or fire.
- Charge the appliance only with the dedicated adaptor. Use the adaptor only for charging the dedicated appliance
 - Failure to do so could result in accidents or other problems.
- Do not use on forehead, eyes, eyelids, ears or neck.
 - Failure to do so could result in accidents or other problems.

⚠ CAUTION:

- Keep out of the reach of toddlers and infants.
 - Failure to do so could result in accidents or other problems.
- Do not use the appliance and the adaptor if they have been damaged by being dropped or hit etc.
 - Doing so could result in injury or malfunction.
- Do not allow pins or dust to adhere to the appliance plug.

- Doing so could result in electric shock, or shorting, or cause a fire.
- Remove the plug of the adaptor from the power outlet when performing maintenance.
 - Failure to do so could result in electric shock or electrical fire due to insulation degradation.
- Always hold the power plug instead of the power cord when removing the adaptor.
 - Failure to do so could result in electric shock or shorting, resulting in fire.
- Tie back your hair when using. Or, fix it with a hair band or a clip.
 - Failure to do so could result in hair getting entangled with the rollers.
- Please let the obverse side of this appliance touch the skin.
 - Failure to do so could result in skin getting entangled with the rollers.
- This appliance should be cleaned after use to avoid accumulation of grease and other residues.

Important

► Charging the appliance

- If there is any noise on the TV or other appliances during charging, charge this appliance from another power outlet.

- Recommended charging temperature is 15 - 35 °C. If the ambient temperature is way off from the recommended charging temperature, the charging time may increase to approximately 3 hours, or it may not charge at all.
The life of the rechargeable battery might shorten, especially when it is charged at low temperatures, so charge the appliance at the recommended charging temperature.
- It may not charge at all when charged at extreme low temperatures (approximately 0 °C or lower).
- Be sure to charge the appliance until charging display/complete lamp starts flashing immediately after purchase, or after not having used the appliance for 3 months, or if operation stopped during use.
(Charging time: approx. 1 hour)
- The main unit will become slightly warm while charging, but this is not a malfunction.

► Using the appliance

Warning

**Do not bring the appliance closer to your hair.
Doing so may result in hair entanglement.**

- The appliance can be used for wet or dry condition.
The following mark means suitable for use in a bath or shower.



- Do not use more than once (3 minutes) per day.
 - It may cause trouble on your skin due to excessive stress when used too much.
- Use with all make-up taken off.
- Condition of the skin may differ depending on your physical condition. Use it in accordance with the condition of your skin.
 - Stop using the appliance and contact a physician when you feel any abnormality such as a rash, red flare, or itching on your skin.
- The skin trouble may be due to stress, constitution, visceral disease, or basic skin care products. Contact your physician.
- If you feel any different at the start of use or with your skin condition, shorten the usage time.
- The rollers will not slide well, and may get stuck on the skin if the surface of the skin is wet. Adjust the way and how hard it is pushed against the skin or the mode, or use after the skin has dried.
- Do not use the appliance with massage oil or cream on your skin. Effect of the rollers may be diminished, or the rollers may be damaged.
- This appliance is not intended for use by persons (including children) with reduced physical, sensory or mental capabilities, or lack of experience and knowledge, unless they have been given supervision or instruction concerning use of the appliance by a person responsible for their safety. Children should be supervised to ensure that they do not play with the appliance.

- Use the RE7-46 adaptor only for this appliance; it cannot be used with other products or for other purposes.
- Properly dispose the plastic bag of the appliance, keep the plastic bag away from infants to prevent suffocation of infants from happening.

► **Cleaning the appliance**

- Always unplug the charger from a household outlet and from the appliance plug before cleaning.
- Do not wipe the main body with thinner, benzene, alcohol, etc.
 - Doing so may result in malfunction or cause cracks or discoloration.
 - Wipe off with a cloth tightly wrung after soaking in water containing dissolved soap.

► **Storing the appliance**

- Do not dry the main body using a dryer or fan heater.
 - Doing so could result in deforming of the parts or malfunction.
- Do not leave under high temperature.
 - Doing so could result in malfunction.
- Do not leave in direct sunlight.
 - Waterproof rubber inside the main body will degrade, which may cause malfunction due to loss of waterproofing.
- Store in a place with low humidity after use.
 - Condensation or rusting inside the main body may cause malfunction if left in a bathroom etc.

Parts identification

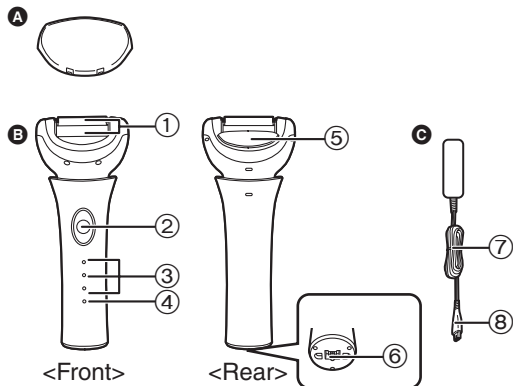

A Cap

B Main body

① Rollers

② “0/1/选择” (Off/On/Select) button

③ Mode display lamps (Green)

Displays the rotating speed of the rollers.

“高速”Fast
“中速” ... Normal
“低速”Slow

④ Charging display/complete lamp (Red)

⑤ Skin guard

This is a safety guard that prevents the skin being spooled up.

⑥ Socket (bottom side)

C Adaptor (RE7-46)

⑦ Power cord

⑧ Appliance plug

Charging the appliance

Charging time = Approx. 1 hour

- This appliance can be used for approximately 1 week at 3 minutes per day.
- Using time may become longer depending on usage.

1 Insert the appliance plug securely into the socket of the main body.

2 Insert the adaptor securely into the power outlet.

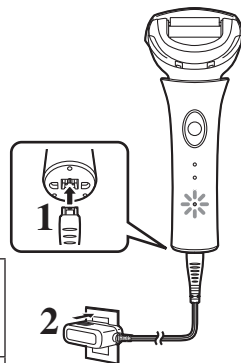

Charging	• • •	Glows
Charging complete	• • ✱	Blinks once every second.
10 minutes after charging is completed	• • ✱	Blinks once every 2 seconds.

- If charging is started while operating, operation will terminate and charging will start.

3 Disconnect the adaptor from the power outlet, and the appliance plug from the main body after the charging is completed.

Battery life

The battery can be used about 3 years if charged once a week.

Also, it is possible that the battery has worn out if the number of usages decreases drastically with a full charge. (Life of the battery will change drastically depending on the usage and condition of storage)

Replacement of the rechargeable battery

Contact the retailer where you purchased the product or the Repair Center at the Panasonic Customer Support for replacement of the battery. It may cause malfunction due to breakage in the waterproof function if you try to replace it yourself.

Using the appliance

This appliance will not operate with the adaptor, power outlet, and main body connected.

Use the appliance with the adaptor disconnected from the main body after charging.

Caution

- Remove any accessories (necklaces, earrings, etc.) so there is no danger of them becoming caught in the appliance.

Danger of hair entanglement

- Tie back your hair or fix it with a hair band or similar so the hair will not get entangled in the rollers. Also, fix the hair with a clip or similar even if it is short.
- Tie back your hair even when you are using in a bath.
- Take extra caution for the hair in front of the ears, since it will easily get entangled.



If the hair gets entangled

- Turn the power off and pull the hair out slowly.

- 1 Remove the cap, and press the “0/1/选择” (Off/On/Select) button once.
 - “低速” Glows

- 2 Press the “0/1/选择” (Off/On/Select) button to select the mode.

- Start from the SLOW mode.

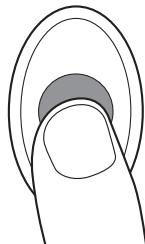

- Every time the “0/1/选择” (Off/On/Select) button is pressed, the mode will switch as follows: “中速” → “高速” → “OFF” → “低速”.
- Use with your preferred mode while checking the skin condition.
- Even though you select the mode while operating, the appliance will stop automatically in 3 minutes.

3 Hold the main body so the “0/1/选择” (Off/On/Select) button is facing you, and slide it over your skin slowly not applying too much pressure.



- Refer to “Correct method of usage” on this page.
- The rotation of the rollers may stop momentarily or the power may turn off automatically when the pressure is too strong, but this is not a malfunction. Decrease the pressure a little.

4 Press the “0/1/选择” (Off/On/Select) button to turn off the power after use.

- When using a cosmetic liquid, use one you normally use in accordance with the condition of the skin.

- Operation will stop automatically after using for 3 minutes continuously.

Correct method of usage

1 Slide it in the direction of the arrows applying light pressure to the skin.

Slightly above the bone of your face line to the bottom of your cheekbone in the order of ① → ② → ③ for 3 seconds each.

From corner of your mouth to side of your ear ④, slowly for 3 seconds.

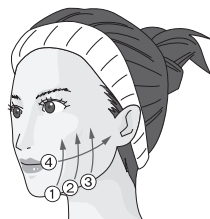

2 Do the same for the other cheek.

Slightly above the bone of your face line to the bottom of your cheekbone in the order of ① → ② → ③ for 3 seconds each.

From corner of your mouth to side of your ear ④, slowly for 3 seconds.

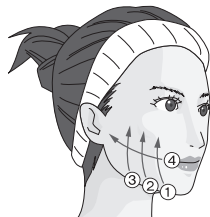

3 Repeat the step 1 to 2 alternately.

Direction in which to apply the rollers

- Hold the main body so the “0/1/选择” (Off/On/Select) button faces you.
- Apply to the skin at an angle of 45 degrees, so the main body will not stand up too much.

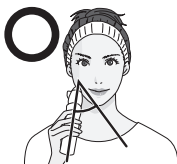

Not sufficiently in contact with the skin, diminishing the effect

Pressure on the rollers

- Apply in such a way that it will gently brush the skin. An ideal level of pressure is when the roller rotates smoothly, and the skin vibrates slightly.
- The roller may get stuck or the main body may rattle when the pressure is too strong. It will not glide smoothly, diminishing the effect.
- When using this appliance for the first time, apply with especially light pressure, and adjust the pressure and the mode depending on the condition.
- Adjust the pressure so the rollers will not bite into the skin, or so the main body will not rattle too much.
- To protect the skin, apply lower pressure around the jawbone or cheekbone (shaded area in the illustration).
- The rotation of the rollers may stop and the motor noise is heard when the pressure is too strong.



Cleaning the appliance

Wash or wipe clean the main body every time after use.

► How to wash the main body

1 Stop the rotation of the rollers.

- Press the “0/1/选择” (Off/On/Select) button several times until the mode display lamp turns off.

2 Wash the rollers.

- Do not use hot water (over 70 °C) or detergent.
- For excessive dirt on the rollers, clean with a toothbrush or wipe with a cloth tightly wrung after soaking in water containing dissolved soap.

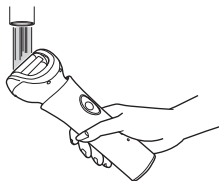

3 Shake off water inside by shaking the main body a few times.

- Water may come out from the gap around the rollers, but this is not a malfunction.

4 Carefully wipe off the water from the main body and rollers using a tissue or cotton swab, and dry in a well ventilated area.

5 Place the cap on after it is completely dry and store.

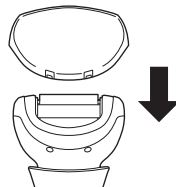

► How to wipe off the dirt on the main body and the adaptor

Wipe off the dirt with a cloth tightly wrung after soaking in water containing dissolved soap.

Removing the built-in rechargeable battery

Remove the built-in battery when disposing of the appliance. Perform steps ① to ⑥ to disassemble the appliance using a screwdriver.

- Unplug the charger from the appliance before disassembling it.
- Press the “0/1/选择” (Off/On/Select) switch to turn on the power and then keep the power on until the battery is completely discharged.

• Please take care not to short-circuit the battery.

- ① Remove the 2 screws on the bottom cover.
- ② Detach the bottom cover.
- ③ Remove the 2 screws of the housing.
- ④ Detach the housing.
- ⑤ Remove the battery cushion.
- ⑥ Remove the Li-ion battery.

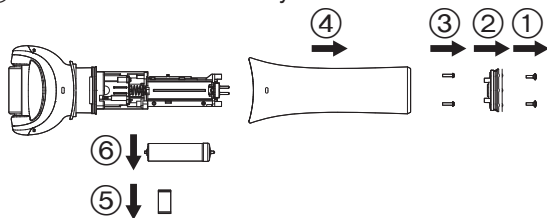

Important notice regarding environmental protection

The built-in rechargeable Li-ion battery contains substances that may be environmentally harmful. Please remove the battery before discarding the appliance.

For environmental protection and recycling materials

This appliance contains a Li-ion battery.

Please make sure that the battery is disposed of at an officially assigned location, if there is one in your country.

Specifications

Product name	Facial Roller	
Product model	EH-SP30	
Rated input	100 - 240V ~ 50-60Hz 180mA (Automatic voltage conversion)	
Rated output	5.4V --- 1.2A	
Nominal voltage	3.6V ---	
Power consumption	Approx. 5W (while charging)	
Charging time	Approx. 1 hour	
Place of origin	China	
Date of production	See engraving on the commodity.	
Execution standard	Chinese standard	GB4706.1 appendix B GB4706.10

This product is intended for household use only.

This image shows a single sheet of white paper with horizontal ruling lines. The lines are evenly spaced and run across the width of the page. There are no margins, text, or other markings on the paper.

Panasonic

保修证

保修条款

有关保修期内Panasonic商品的保修（无偿修理），从购入之日起开始实施。

1.保修期内的商品只可在Panasonic认定维修店进行保修；保修时，请出示本保修证及购机发票。
以下两点需特别注意：

- a.本保修证遗失后不再补发，请妥善保管。
 - b.本保修证仅限于中华人民共和国内有效(香港、澳门、台湾三地区暂不可使用)。
- 2.自购入之日起在以下期间内，在正常使用中发生故障的情况下进行保修。

- 整机（除商用产品）.....2年内无偿
- 整机（商用产品）.....6个月
- 内刀头、外刀网、刀头、辅助装置、附件.....有偿提供

3.属下列情况之一者，即使在保修期内，也不能以保修对待，但是可以实行收费修理：

- a.未按商品使用说明要求使用、维护、保管而造成损坏的；
 - b.因不正确操作、电源不正常、破损（如：摔落等）而造成损坏的；
 - c.不经Panasonic认定维修店维修人员拆卸造成损坏的；
 - d.不能出示本保修证及有效购机发票的；
 - e.保修证上记录的信息与商品实物标识不符或者涂改的；
 - f.因不可抗力因素（如雷电、地震、火灾、水灾等）造成损坏的。
- 4.本保修条款只适用于消费者个人为生活消费需要而购买使用的场合，不适用于经营性等使用。

【商品信息】

商品名称:.....

面部长摩器

产地:.....

中国・广州

商品型号:.....

EH-SP30

制造编号:.....

【保修回执】 以下回执是保修的重要依据，请勿自行撕下

商品型号:	EH-SP30	制造编号:	保修结算 4
商品型号:	EH-SP30	制造编号:	保修结算 3
商品型号:	EH-SP30	制造编号:	保修结算 2
商品型号:	EH-SP30	制造编号:	保修结算 1
商品型号:	EH-SP30	制造编号:	促销员留存

保修证管理编码印刷处：

本保修证内容如有变更恕不另行通知

【销售记录】 未完整记录以下信息将无法进行保修

销售日期: _____ 发票号码: _____

安装调试日期: _____

销售店
(盖章)

顾客姓名: _____ 联系电话: _____

顾客地址: _____ 邮 编: _____

销售店名称: _____ 销售店电话: _____

销售店地址: _____ 邮 编: _____

【维修记录】

维修店名称: _____ 联系电话: _____ 送修日: _____

维修店地址: _____ 邮 编: _____

故障内容: _____ 故障原因: _____

维修内容: _____

维修员签字: _____ 交验日期: _____

维修店名称: _____ 联系电话: _____ 送修日: _____

维修店地址: _____ 邮 编: _____

故障内容: _____ 故障原因: _____

维修内容: _____

维修员签字: _____ 交验日期: _____

维修店名称: _____ 联系电话: _____ 送修日: _____

维修店地址: _____ 邮 编: _____

故障内容: _____ 故障原因: _____

维修内容: _____

维修员签字: _____ 交验日期: _____

Panasonic 客户服务中心:

400-810-0781; 800-810-0781 (固定电话)

Panasonic 官方网站: <http://panasonic.cn>

松下电器 (中国) 有限公司

This image shows a single sheet of white paper with horizontal ruling lines. The lines are evenly spaced and run across the width of the page. There are no margins, text, or other markings on the paper.

松下电工・万宝电器（广州）有限公司 (PEWWBG)
Panasonic Electric Works Wanbao (Guangzhou) Co., Ltd.

工厂地址: 广州市番禺区市广路万宝基地
(Address): Wanbao Base, Shiguang Road, Panyu District, Guangzhou
电话 (Tel): (020)84770333
传真 (Fax): (020)84773033
邮政编码 (Post Code): 511495
原产地: 中国