

Panasonic®

Facial Ionic Steamer

离子蒸汽美容器

Model No. EH2424

型号 EH2424

Operating Instructions

使用说明书

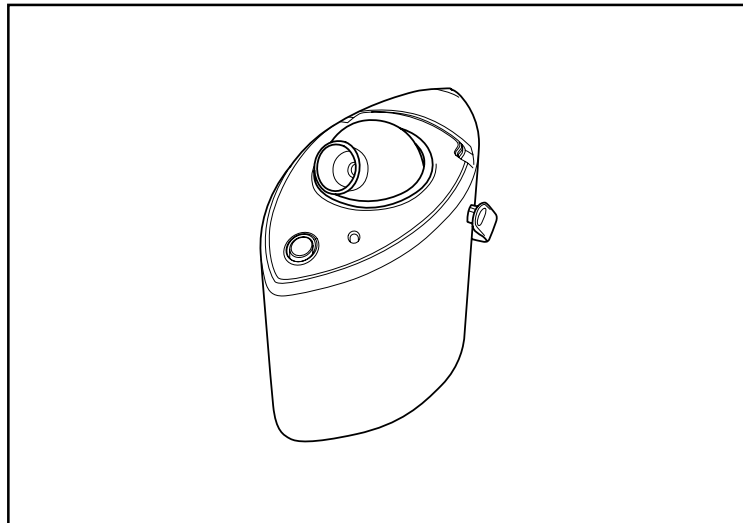

Before operating this unit, please read these instructions completely.
Thank you for purchasing the Panasonic Facial Ionic Steamer Model No.EH2424.

在使用前, 请仔细阅读此说明书。

承蒙选购Panasonic EH2424型离子蒸汽美容器, 在此谨致谢意。

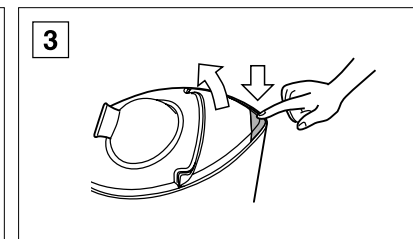
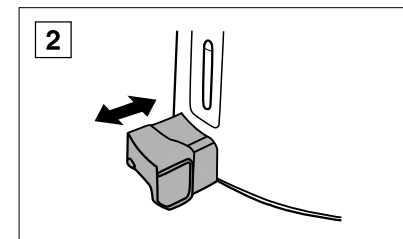
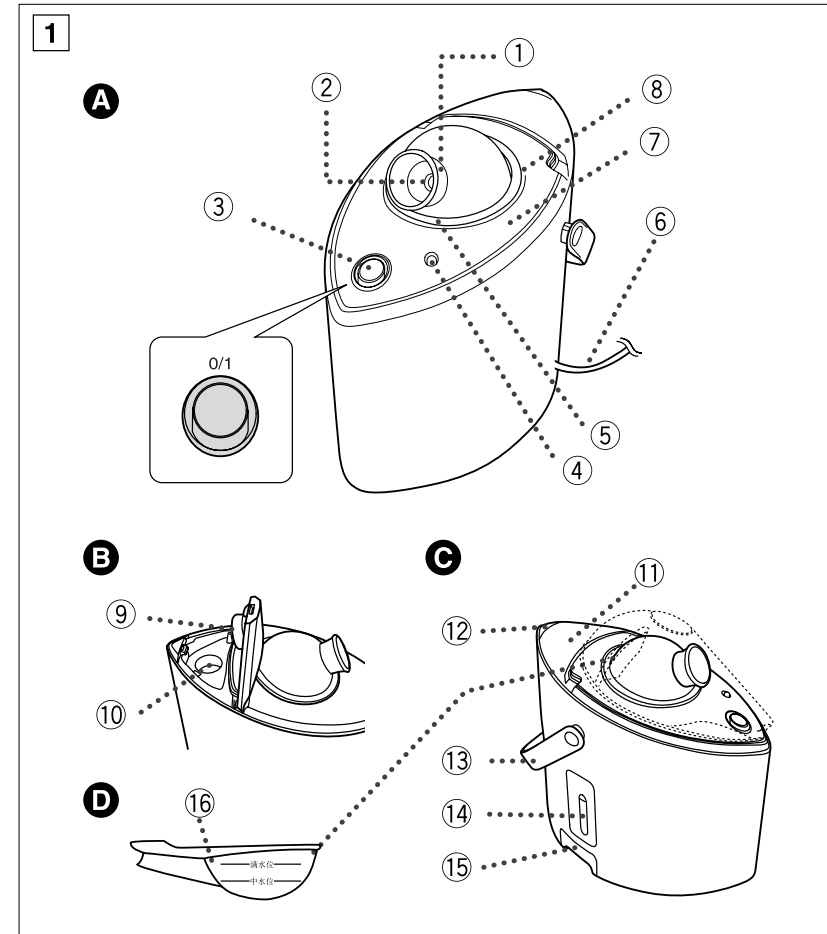

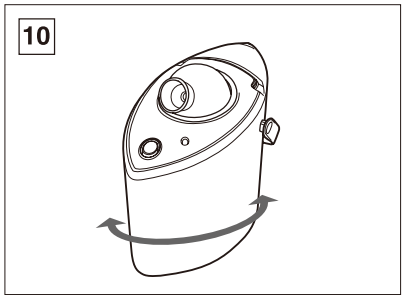
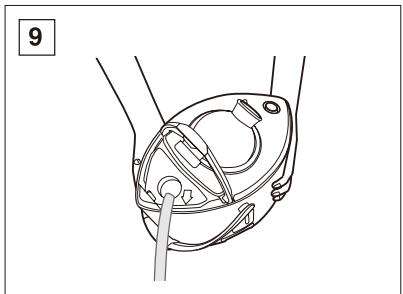
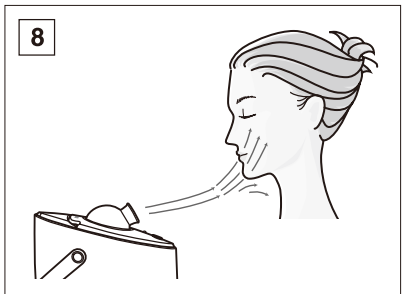
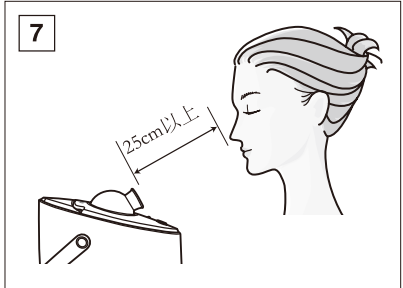
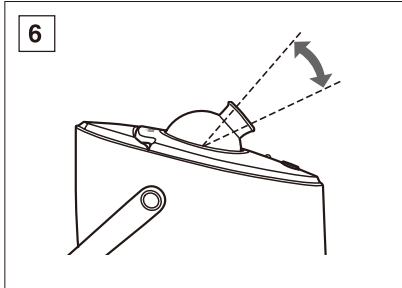
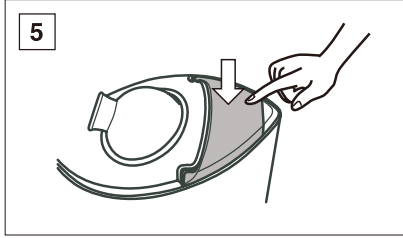
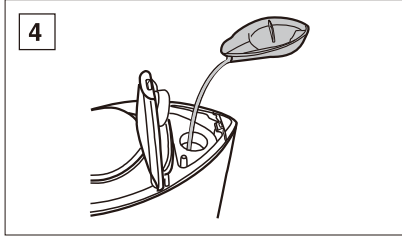

INDEX

中文 4
 ENGLISH 9

安全注意事项

为确保本器具的正确操作，使用前请仔细阅读所有安全注意事项。列出这些安全注意事项的目的，是为了能让您正确和安全地使用本器具，以免您和他人受到伤害以及财产损失。安全注意事项的详细说明如下。请妥善保管本使用说明书，并将其置于使用者可看得见的地方，以备随时参考。

1. 下列人员使用前应该咨询医师：
 - 患有急性病、恶性肿瘤或已妊娠的人
 - 有过敏反应或皮肤过敏的人
 - 有皮肤问题，如皮炎、严重晒伤等的人
 - 有皮肤受伤、湿疹、肿胀的人
 - 否则，可能会导致皮肤问题。
2. 小心蒸汽的高温。
 - 请将本器具置于平坦的表面上使用。勿拿在手上使用。
 - 在使用中或使用后10分钟之内，请勿倾斜、摇晃或移动本器具。（否则，可能会导致蒸汽出口的大量蒸汽释放或热水溅出。）
 - 使用中(或在开关关闭后的30秒钟之内)，请勿触摸或窥视蒸汽出口。
 - 请勿让您的脸部或手指直接与离出口20厘米以内的蒸汽接触。
 - 加水或使用中，一定要将排水盒安放在本器具之上。
 - 否则，可能会导致灼伤或烫伤。
3. 在使用中或使用后10分钟之内，请勿打开加水盖。
 - 否则，可能会导致灼伤或烫伤。
4. 要确保所使用的电压与本器具所标明的额定电压相符合。
 - 否则，可能会导致火灾、触电、灼伤或烫伤。
5. 使用后或使用中遇到停电时，请务必从电源插座上拔出电源插头，拔插头时，请捏住插头。
 - 否则，可能会导致触电、烫伤或火灾。
6. 请勿在下列状况下使用本器具：
 - 当电源线或插头损坏或变热时。
 - 当电源插座上的插头出现松动时。
 - 否则，可能会导致火灾、触电、短路、灼伤或烫伤。
7. 请勿切断、损坏、改造、勉强弯曲、拉扯或扭曲电源线。
 - 也勿将重物置于电源线之上或挤压电源线。
 - 当电源线损坏或变热时，为避免危险，请立即停止使用，并将本器具送到您附近的Panasonic维修店，由专门人员进行更换。由于进行任何检测、调整或维修都需要特殊工具，所以绝对不要擅自修理本器具。
 - 否则，可能会引起火灾而导致人员伤亡。
8. 存放时，请勿将电源线缠绕在本器具上。
 - 否则，可能会导致电源线变形和功能失常。
9. 请勿让已丧失热感觉的人或儿童使用(除非在成年人的监护之下)。本器具应存放在儿童、洗澡或淋浴的人接触不到的地方。
 - 否则，可能会导致灼伤、烫伤、触电或人员伤亡。
10. 如果感到疼痛或不适，请立即停止使用。
 - 若继续使用，可能会导致皮肤或健康问题。
11. 请勿在可燃性物质(酒精、稀释剂、汽油、指甲油去除剂、气溶胶喷射剂等)附近使用本器具。
 - 否则，可能会导致爆炸或起火。
12. 请勿将本器具存放或放置在浴室及其它湿度较高或可能会变湿的地方(如靠近浴缸等地方)。
 - 否则，可能会因绝缘性降低，而导致触电或火灾。
13. 如果器具内装有水，请勿摇晃。
14. 请勿从蒸汽出口排水。(参见“使用后”)

 - 若热水滴聚集在蒸汽出口，且电

源处于打开状态，热水滴可能会溅出，从而导致灼伤或烫伤。

- 切勿将本器具浸入水中。
- 当给器具加水时，应小心勿让水与喷嘴、装饰环、主面板或开关接触。
 - 否则，可能会导致火灾、触电、短路、灼伤或烫伤。
- 切勿用湿手来操作本器具。
 - 否则，可能会导致触电或短路。

警告：不要在盛水的浴缸、洗脸盆或其他器皿附近使用本器具。

- 尽量避免在浴室使用本器具。若要在浴室使用，使用后务必拔下插头，因为即使器具断电后，接近水仍存在危险，为了保障您的安全，建议在浴室供电的电气回路中安装一个额定漏电动作电流不超过30mA的漏电保护装置(RCD)。为确保安全，请向RCD安装商咨询。
- 如果因摔落或碰撞等使本器具受损时，切勿再使用。
 - 否则，可能会导致触电或火灾。
- 本器具只能用于您的面部。
 - 否则，可能会导致灼伤、烫伤、触电或人员伤害。
- 只能用加水杯给本器具加水。切勿在使用中加水。
- 加水时，请勿超过本器具或加水杯的“满水位”标记。(参见“准备”)
 - 否则，可能会导致灼伤或烫伤。
- 请将加水盖关紧。(参见“准备”)
 - 否则，可能会导致火灾、灼伤或烫伤。
- 请遵守下列本器具所用水的有关事项。
 - 只能使用蒸馏水或纯净水。

注意：

- 由于水质不同，可能会缩短本器具的使用寿命，所以建议您使用蒸馏水。
- 请勿在蒸馏水或纯净水中混入添加物(如香油等)。
 - 使用后，务必将剩余的水倒掉。

- 清洗本器具时，请勿使用清洁剂。
- 本器具只供家庭使用。
 - 使用后应清洁以避免油脂及其它残余物的积累。

部件名称(图1)

- ① 喷嘴
- ② 蒸汽出口
将释放出毫微(纳米)尺寸的离子蒸汽。
- ③ 电源开关
- ④ 测试开关
测试开关用于检查蒸汽的离子化(雾化)状况。只有在按住测试开关期间，离子化灯才会熄灭，并释放非离子化蒸汽。
- ⑤ 离子化灯
电源打开时，该灯将点亮。按住测试开关期间，该灯将熄灭。
- ⑥ 电源线
- ⑦ 主面板
- ⑧ 装饰环
- ⑨ 进水口垫圈
- ⑩ 进水口
- ⑪ 加水盖
- ⑫ 开盖按钮
- ⑬ 把手
- ⑭ 水位显示窗
当加水至“满水位”标记时，本器具可使用约12分钟。
- ⑮ 排水盒
如果添加了过多的水，多余的水将聚集在排水盒中。
- ⑯ 加水杯
当注水至“满水位”标记(杯内顶线)时，本器具可使用约12分钟。

使用前

使用本器具之前，请彻底阅读下列事项。

- 使用过度可能会损伤皮肤。
 - 开始时，建议您每周使用本器具2、3次。之后，一边观察自己的皮肤状况，一边调整使用的频率和每次使用的时间。

如有任何皮肤问题，请立即停止使用。

- 建议使用频率为每天1次。
- 您的皮肤状况可能会因您的健康状况而不同。
(尤其是在脱皮的期间，皮肤尤为敏感。)
 - 请一边观察您的皮肤状况，一边使用本器具。
 - 如果您感到任何皮肤不适，如皮疹、充血、搔痒等等，请停止使用并就医。
 - 皮肤问题也许是由生活压力、健康或化妆品所引起。
在此情况下，请咨询专家。

使用前的准备

(将器具置于平坦的表面，如桌子等即使被水滴所覆盖也不会产生任何问题的物品之上。)

- 检查排水盒是否已安装在器具之上。(图2)
- 按下开盖按钮，使加水盖向上打开。(图3)
- 用加水杯，给器具加满水。(图4)
 - 请勿直接用水龙头加水。
 - 只能使用蒸馏水或纯净水。
 - 注意：由于水质不同，可能会缩短本器具的使用寿命，所以建议您使用蒸馏水。
 - 小心勿让水与喷嘴、装饰环、主面板和开关接触。
 - 请倒掉加水杯中任何剩余的水。(如果将加水杯放在桌子或其它表面，加水杯可能会倾斜，从而导致里面的水洒出。)

警告

- 加水时，请勿超过加水标上的“满水位”标记，或切勿在本器具内残留有水时加水。(检查水位，然后只有在器具内无残留水的情况下才能加水。)
 - 否则，将会导致热水从蒸汽出口喷出，从而可能造成灼伤或烫伤。

4. 关闭加水盖。(图5)

- 用力关紧，直至听见“咔嚓”一声为止。

本器具的使用方法

- 将电源插头插入电源插座，按下电源开关，直至听见“咔嚓”一声为止。
 - 离子灯将点亮。
 - 约30秒钟后，将释放出离子化蒸汽。
 - 在蒸汽流的开头释放出热水滴，属于正常现象。
 - 可能会听见嘘嘘声。这是放电声，属正常现象。
 - 请勿在加水杯放于喷嘴上的情况下操作本器具。
- 调节喷嘴的角度(上/下)。(图6)
 - 调节喷嘴时，请小心勿直接接触蒸汽。

警告：小心蒸汽的高温

- 使用中(或在开关关闭后的30秒钟之内)，请勿触摸或窥视蒸汽出口。
- 请勿让您的脸部或手指直接与离出口20厘米以内的蒸汽接触。
 - 否则，可能会导致灼伤或烫伤。

蒸汽的使用方法

- 向左或右，稍微移动您的面部，使蒸汽均匀散布于面部。
 - 将蒸汽用于您的鼻子时，有效区域为“T”字部位。
- 使您的面部与蒸汽出口至少保持25厘米以上的距离。(图7)
 - 使蒸汽出口朝向您的面部，稍微高于下巴。(图8)
 - 使用后，将面部的水擦净(如用餐巾纸等)。然后还要抹一些洗面乳，将面部清洗干净，并用一些化妆水来补充皮肤水分。

警告

- 使用中或刚刚使用后，请勿加水。
加水之前，请确保本器具已充分冷却。

- 否则, 可能会导致灼伤或烫伤。

本器具的使用举例

除了可在裸露的皮肤上使用本器具之外, 还可与面部治疗结合使用。

- 清洗前
 1. 使用本器具约3分钟。(这将清除皮肤上的污垢。)
 2. 进行清洗
- 抹一些按摩膏, 然后一边按摩您的皮肤, 一边使用蒸汽。
- 抹上一些乳液和化妆水, 然后使用本器具。

使用后

(每次使用后, 请务必倒掉器具中剩余的水。)

1. 按电源开关, 直至听见"咔嚓"一声关闭电源为止, 然后从电源插座上拔出电源插头。
 - 指示灯(离子化灯)将关闭。
 - 按开关时, 小心勿接触蒸汽。
 - 否则, 可能会导致灼伤或烫伤。
 - 在未装水的情况下, 切勿操作本器具。使用后, 请及时关闭电源开关。
 - 否则, 将会加快水垢的积累, 从而可能导致蒸汽释放不良。
2. 令本器具单独冷却至少10分钟以上。
3. 取出排水盒, 倒掉其中的水。(图2)
4. 按箭头所示方向, 倒掉器具中的水。
 - 如果未按箭头所示方向倒水, 可能会弄湿开关, 因而导致功能失常。
 - 为了防止倒水时的灼伤或烫伤危险, 请握住器具底部。(图9)注意: 倒水时, 小心勿将水溅洒到电源插头和电源线上。
5. 擦净器具上的水。
 - 请勿将电源线缠绕在器具上。
 - 否则, 可能会损坏电源线。
 - 如果存放时将加水杯倒过来放在器具上, 首先应该擦净杯中的水。
 - 否则, 可能会将开关弄湿, 从

而导致功能失常。

清洁

请勿在水中洗刷或浸泡本器具。

清洁进水口和水位显示窗周边。(每月1次)

- 为了清除和防止水垢沉淀, 使用后, 应该让器具冷却至少10分钟以上, 然后依下列步骤进行清洁。

在上述"使用后"步骤4的操作后, 将排水盒重新放入器具中。
- 1. 打开加水盖, 用加水杯加水。
 - 加水至器具上的"满水位"标记为止。
- 2. 关闭加水盖, 水平摇动器具3~4次。
 - 请轻轻摇动, 切勿将其倾斜。(图10)
- 3. 打开加水盖, 依箭头所示方向, 倒掉器具中的水。
 - 为了防止倒水时的灼伤或烫伤危险, 请握住该器具底部。(图9)注意: 为了使清洁更有效, 请重复上述步骤2、3次。
- 4. 擦净器具上的水。
 - 即使进水口或水位显示窗附近有水垢沉淀, 也不会影响蒸汽的释放。

清洁本器具。(请勿在水中洗刷或浸泡该器具)

- 用浸有肥皂水的抹布, 擦拭本器具。绝对勿使用酒精、稀释剂、汽油、指甲油去除剂等。
 - 否则, 可能会导致功能失常或部件破裂或褪色。
- 即使排水之后, 器具中也仍会有残留水。
 - 这不会带来卫生问题, 因为下次使用时, 水将被煮沸。
 - 根据水质不同, 水中可能含有因蒸发残渣所造成的白色微粒或杂质。其中主要含有碳酸钙。这属正常现象。

故障预防

1. 只能使用蒸馏水或纯净水。
 - 否则, 可能会导致功能失常。
2. 在使用中或使用后10分钟之内, 请勿打开加水盖。
 - 否则, 可能会导致灼伤或烫伤。
3. 在使用中或使用后10分钟之内, 请勿倾斜、摇晃或移动本器具。
 - 否则, 可能会导致灼伤或烫伤。
4. 使用中, 请勿触摸或窥视蒸汽出口。
5. 按开关时, 切勿接触蒸汽。
 - 否则, 可能会导致灼伤或烫伤。
6. 请勿将电源线缠绕在器具上。
 - 否则, 可能会损坏电源线。
7. 在加水或倒水之前, 应关闭电源, 从电源插座上拔出电源插头, 然后让器具充分冷却。
 - 否则, 可能会导致灼伤或烫伤。

什么是毫微(纳米)尺寸的离子蒸汽?

- 离子蒸汽是普通蒸汽离子化(雾化)的结果, 且已在美容院中得到应用。
- 毫微(纳米)尺寸的离子蒸汽属于离子蒸汽的一种, 是离子蒸汽得到进一步雾化的效果。

应该使用何种水?

- 应使用蒸馏水或纯净水。
- 使用矿泉水或地下水, 可能会导致器具内碳酸钙的累积或水垢沉淀。注意: 由于水质不同, 可能会缩短本器具的使用寿命, 所以建议您使用蒸馏水。

紧急处理方法

发生异常时(有烧焦味等)须立即停止使用并拔下电源插头。

- 若在异常状态下继续使用, 会因发热等情形, 造成火灾及触电的发生。
- 请速与特约维修店或经销商洽询。
- 电源线损坏时, 需由特约维修店的专业人员更换以避免危险。

型号规格

产品名称: 离子蒸汽美容器
产品型号: EH2424
额定电压: a.c.220V~50Hz
额定功率: 290W
蒸汽释放率: 约6ml/min
蒸汽温度: 约40℃
(离蒸汽出口约25cm的距离)
原产地: 中国
生产日期: 见商品上刻印
执行标准: GB4706.1 GB4706.15
GB4343.1 GB17625.1
Q/(GZ)PEWWBG 7

松下电工·万宝电器(广州)有限公司
广州市番禺区市广路万宝基地
邮政编码: 511495
电话: 020-84770333 (总机)

注: 以上规格若有变更, 恕不另行通知。

售后服务

在保证本产品品质优良的同时, 您将享有我公司的免费服务保证。从购买之日起二年内, 若发生任何因制造工艺或原器件造成之损坏, 我们将为您提供免费的门市维修服务, 请填好保修证并向购买店索取发票或有效购买凭证, 以备万一发生之用, 而不造成您的经济损失(详情见保修证), 无论在保修期内或保修期后, 您皆可在服务中心或特约维修店获得优质的维修服务。如有任何问题, 请与我们联系。

Safety Precautions

To ensure proper operation of this appliance, please read carefully all the safety precautions before use.

These safety precautions are provided to instruct you with the correct and safe operation of this appliance so that you may avoid injuries to yourself and others as well as damage to property. The safety precautions are defined as follows.

After reading these safety precautions, store the manual where it is accessible to the user(s).

1. The following persons should consult a physician before use.
 - Persons with acute illnesses or malignant tumors, persons who are pregnant
 - Persons who have allergies and sensitive skin
 - Persons with skin problems, such as dermatitis, severe sunburn, etc.
 - Persons with skin injuries, eczema, swelling, etc.- Failure to do so may result in skin problems.
2. Be careful of the steam's high temperature.
 - Use on a flat surface. Not for handheld use.
 - Do not tilt, shake, or carry the appliance during use or within 10 minutes after use.(Doing so may cause a large amount of steam to discharge or hot water to spill from the outlet.)
 - Do not touch or look into the steam outlet during use (or within 30 seconds after the switch has been turned off).
 - Do not allow your face or hand to come into direct contact with the steam within 20 cm of the outlet.
 - Be sure the drain cup is installed in the unit when filling with water or during use.- Failure to do so may result in burns or scalding.
3. Do not open the water supply cover while using the steamer or within 10 minutes after use.
 - Doing so may result in burns or scalding.
4. Always ensure the appliance is operated on an electric power source matched to its rated voltage.
 - Failure to do so may result in fire, electric shock, burns, or scalding.
5. After use or power cut, be sure to remove the plug from the power outlet. When removing the power cord from the power outlet, hold it by the plug.
 - Failure to do so may result in fire, electric shock or scalding.
6. Do not use the appliance under the following conditions.
 - When the cord or plug is damaged or becomes hot.
 - When the plug is loose in the power outlet.- Doing so may result in fire, electric shock, short circuit, burns, or scalding.
7. Do not cut, damage, modify, unreasonably bend, pull, or twist the cord. Also do not place heavy objects on the cord or squeeze the cord.

If the cord is damaged or gets heated up, discontinue use immediately and return the appliance to your nearest authorized Panasonic service dealer for repair or replacement. As special tools are required for any examination, adjustment or repair, never repair the appliance by yourself.

 - Failure to do so may result in fire or personal injury.
8. Do not wind the cord around the appliance during storage.
 - Doing so may strain the cord and result in malfunction.
9. Not for use by persons who are unable to feel heat or by children (unless supervised by an adult). Store the appliance safely out of reach of children or a person using a bath or shower.
 - Doing so may result in burns, scalding,

- electric shock, or personal injury.
10. Immediately stop use if pain or discomfort is experienced.
 - Continued use may result in skin or health problems.
 11. Do not use the appliance near flammable substances (alcohol, thinner, benzene, enamel remover, aerosol sprays, etc.).
 - Doing so may result in explosion or fire.
 12. Do not store the appliance in bathroom or in other rooms with high humidity. Do not place the appliance where it may get wet (such as next to a wash basin).
 - Doing so may result in electric shock or fire due to insulation deterioration.
 13. Do not shake the appliance if it contains water.
 14. Do not drain the water from the outlet. (refer to "After use".)
 - If water droplets collect at the steam outlet and the power is turned on, hot water droplets may spatter causing burns or scalding.
 15. Do not immerse the appliance into water.
 16. When filling the appliance with water, be careful not to let water come in contact with the nozzle, cosmetic ring, main panel, or switch.
 - Doing so may result in fire, electric shock, short circuit, burns, or scalding.
 17. Do not use with wet hands!
 - Doing so may result in electric shock or short circuit.

Do not use this appliance near water contained in bath-tubs, basins or other vessels.
 18. The appliance is not recommended to use in bathroom. When used in a bathroom, unplug the appliance after use since the proximity of water presents a risk even when the appliance is switched off.

For additional protection, we advise you to install a residual current device (RCD) with a rated residual operating current not exceeding 30mA in the electrical circuit supplying the bathroom. Ask your installer for advice.
 19. Do not use the appliance if it has been damaged by being dropped or hit etc.
 - Doing so may result in electric shock or fire.
 20. Use the appliance only for your face.
 - Failure to do so may result in burns, scalding, electric shock, or personal injury.
 21. Fill the appliance with water using only the water supply cup. Do not add water during use.
 22. Do not add water beyond the full mark on the appliance or water supply cup. (refer to "Preparation".)
 - Doing so may result in burns or scalding.
 23. Securely close the water supply cover. (refer to "Preparation".)
 - Failure to do so may result in fire, burns, or scalding.
 24. Observe the followings for the water to be used for the appliance.
 - Use only distilled water or purified water.

Notes:

 1. Since the service life of the appliance may shorten depending on water quality, the use of distilled water is recommended.
 2. Do not mix additives (aroma oils, etc.) into the distilled water or purified water.
 - Be sure to drain the water after use.
 - Do not use detergents to clean the appliance.
 25. This appliance is designed only for household use.
 26. Clean the appliance after use to prevent accumulation of grease or other residuals.

Part names (Fig. 1)

- Ⓐ
- ① Nozzle
 - ② Steam outlet
Nano-sized ion steam is discharged.
 - ③ Power switch
 - ④ Test switch
The test switch is used to check the ionization (atomization) of the steam. The ionize lamp turns off and non-ionized steam is discharged only while the test switch is pressed.
 - ⑤ Ionize lamp
The lamp turns on when the power is

turned on. The lamp turns off while the test switch is pressed.

- ⑥ Cord
- ⑦ Main panel
- ⑧ Cosmetic ring
- ⑨ Water inlet gasket
- ⑩ Water inlet
- ⑪ Water supply cover
- ⑫ Water supply cover open button
- ⑬ Handle
- ⑭ Water level
When water is filled to the "满水位(full)" mark, the appliance can be used for approximately 12 minutes.
- ⑮ Drain cup
Water collects in the drain cup if too much water is added.
- ⑯ Water supply cup
When water is filled to the "满水位(full)" mark (top level inside the cup), the appliance can be used for approximately 12 minutes.

Before use

Thoroughly read the following before using the appliance.

1. Excessive use is detrimental to the skin.
 - It is recommended that you start by using the appliance two to three times a week.
 - Thereafter, adjust the frequency and duration of use while observing the condition of your skin.
 - If any skin trouble develops, stop use immediately.
 - Recommended usage is once a day.
2. Your skin condition also may differ according to your health.
(Skin is particularly sensitive on days when peeling is performed.)
 - Use the appliance while observing the condition of your skin.
3. If you feel any skin discomfort, such as rash, redness, itching, and so forth, stop use and consult a physician.
4. Skin problems may be caused by stress, health, organic disorder or cosmetics.
In such instances, consult a specialist.

Preparation

(Place the appliance on a flat level surface, such as on a desk, which would not cause a problem if covered with water droplets.)

1. Check that the drain cup is installed in the appliance.(Fig.2)
2. Press the water supply cover open button to lift up the water supply cover. (Fig. 3)
3. Use the water supply cup to fill the appliance with water.(Fig.4)
 - Do not fill directly from a water faucet.
 - Use only distilled water or purified water.
 - Note: Since the service life of the appliance may shorten depending on water quality, the use of distilled water is recommended.
 - Be careful not to let water come in contact with the nozzle, cosmetic ring, main panel, and switch.
 - Dispose any leftover water in the water supply cup. (If the water supply cup is placed on a table or other surface, it may tilt causing the water inside to spill out.)

WARNING!

- Do not add water past the "满水位(full)" mark on the water supply cup or if water remains in the appliance.(Check the water level and add water only when there is no remaining water in the appliance.)
 - Failure to observe this will result in the spattering of hot water droplets from the steam outlet and may cause burns or scalding.
4. Close the water supply cover.(Fig.5)
 - Firmly close until a click is heard.

Using the facial ionic steamer

1. Insert the plug into a power outlet and press the power switch until a click is heard.
 - Ionize lamp turns on.
 - Ionized steam is released after about 30 seconds.
 - It is normal for hot water droplets to be discharged at the beginning of the steam flow.
 - A whizzing may be heard. This is the sound of electric discharge which is normal.
 - Do not operate the appliance with the water supply cup placed on the nozzle.
2. Adjust the angle (up/down) of the nozzle. (Fig. 6)
 - Adjust the nozzle while taking care not to directly touch the steam.

WARNING:Be careful of the steam's high temperature

- Do not touch or look into the steam outlet during use (or within 30 seconds after the switch has been turned off).
- Do not allow your face or hand to come into direct contact with the steam within 20 cm of the outlet.
- Doing so may result in burns or scalding.

How to use the steam

- Move your face slightly to the left and right so that the steam spreads evenly.
 - Using the steam on your nose is effective on the T-zone.
1. Keep your face at least 25 cm away from the steam outlet. (Fig. 7)
 2. Position the steam outlet towards your face slightly above your chin. (Fig. 8)
 3. After use, wipe off the water (such as with a tissue), then also apply a lotion to prepare your face and apply an emulsion to supplement skin oil.

WARNING!

- Do not add water during use or immediately after use. Wait until the appliance has cooled sufficiently before adding water.
 - Doing so may result in burns or scalding.

Examples of the uses of the facial ionic steamer

In addition to using the appliance on bare skin, it can also be used in combination with facial treatments.

- Before cleansing
 1. Use the appliance for about 3 minutes. (This lifts dirt from the skin.)
 2. Perform cleansing.
- Apply massaging cream and use the steam while massaging your skin.
- Use the appliance after applying lotions and face liquids.

After use

(Be sure to discard the water in the tank every time after use.)

1. Press the power switch until a click is heard to turn off the power and then remove the plug from the power outlet.
 - The lamp turns off.
 - Be careful not to touch the steam when pressing the switch.
 - Failure to do so may result in burns or scalding.
 - Do not operate the appliance if it contains no water.
 - Doing so will quicken the accumulation of water scale, which may result in poor steam discharge.
2. Leave the appliance alone to cool for at least 10 minutes.
3. Discard the water in the drain cup.(Fig.2)
4. Pour out the water from the appliance in the direction of the arrow as shown.
 - Emptying the water in a direction other than that indicated by the arrow may

get the switch wet, which may cause a malfunction.

- To prevent risk of burns or scalding when discarding the water, hold the bottom of the appliance. (Fig. 9)

Note: When discarding the water, be careful not to get water on the power plug and cord.

5. Wipe off any water from the appliance.

- Do not wind the cord around the appliance.
 - Doing so may damage the wires.
- If the water supply cup is to be placed upside down on the appliance for storage, first wipe off any water from the cup.
 - Failure to do so may get the switch wet and result in malfunction.

Cleaning

Do not wash or soak the appliance in water.

Cleaning around the water inlet and water level. (Clean once a month)

- To remove and prevent water scale deposits, let the appliance cool for at least 10 minutes after use and then clean according to the following steps. After the operation in step 4 on "After use" of the Instruction Manual, replace the drain cup into the appliance.
1. Open the water supply cover and add water using the water supply cup.
 - Add water until the "满水位(full)" mark on the appliance.
 2. Close the water supply cover and shake the appliance horizontally 3-4 times.
 - Shake the appliance gently without tilting it. (Fig. 10)
 3. Open the water supply cover and pour out the water from the appliance in the direction of the arrow as shown.
 - To prevent risk of burns or scalding when discarding the water, hold the bottom of the appliance. (Fig. 9)
- Note: Repeat the above steps 2-3 times for effective cleaning.
4. Wipe off any water from the appliance.
 - Even if there are water scale deposits

near the water inlet or water level, the discharged steam is not affected.

Cleaning the appliance. (Do not wash or soak the appliance in water.)

- Wipe the appliance with a cloth moistened with soapy water. Never use alcohol, thinner, benzene, enamel remover, etc.
 - Doing so may result in malfunction or part cracks or discoloration.
- Even after draining the water, some water remains in the appliance.
 - This does not cause any sanitary problems since the water is boiled when used the next time.
 - Depending on the tap water, the discarded water may contain white particles or impurities as a result from evaporation residue. It contains mainly calcium carbonate. This is normal.

Trouble prevention

1. Use only distilled water or purified water.
 - Failure to do so may result in burns, scalding, or malfunction.
2. Do not open the water supply cover during use or within 10 minutes after use.
 - Doing so may result in burns or scalding.
3. Do not tilt, shake, or carry the appliance during use or within 10 minutes after use.
 - Doing so may result in burns or scalding.
4. Do not touch or look into the steam outlet during use.
5. Do not touch the steam when pressing the switch.
 - Doing so may result in burns or scalding.
6. Do not wind the cord around the appliance.
 - Doing so may damage the wires.
7. Turn off the power, remove the plug from the outlet, and let the appliance cool sufficiently before adding or discarding water.
 - Failure to do so may result in burns or scalding.

What is nano-sized ion steam?

- Ion steam is the result of ionizing (atomizing) ordinary steam and is used in esthetic salons.
- Nano-sized ion steam is a type of ion steam in which the ion steam is further atomized.

What type of water should I use?

- Use distilled water or purified water.
- The use of mineral water or underground water may cause the accumulation of calcium carbonate or water scale deposits inside the appliance.

Note: Since the service life of the appliance may shorten depending on water quality, the use of distilled water is recommended.

Specifications

Product name	Facial Ionic Steamer
Product model	EH2424
Power supply	a.c 220V~50Hz
Power consumption	290W
Steam discharge rate	Approx. 6ml/min (at a distance of approx. 25cm from ion steam outlet)
Place of origin	China
Produce date	See on the commodity to engrave
Execution standard	GB4706.1 GB4706.15 GB4343.1 GB17625.1 Q/(GZ)PEWWBG 7

Panasonic Electric Works Wanbao(Guangzhou)Co., Ltd.
Wanbao Base, Shiguang Road, Panyu District, Guangzhou
Post Code:511495
Tel:020-84770333

Specifications are subject to change without notice.

After service

We pledge our product of the best quality, at the same time, you will enjoy our free of charge after service. In two years from the date of purchase, if the appliance has any damage caused because of the manufacturing technological or raw and processed materials, we will offer the free charge service for you. Please fill in the certificate and ask for invoice or valid purchase voucher, if by any chance when your appliance broken down, no matter during guarantee time or not, you always get a high quality service in our service center or special repair shop.



保修证

保修条款

有关保修期内Panasonic商品的保修（无偿修理），从购入之日起开始实施。

1.保修期内的商品只可在Panasonic认定维修店进行保修；保修时，请出示本保修证及购机发票。

以下两点需特别注意：

- a. 本保修证遗失后不再补发，请妥善保管。
 - b. 本保修证仅限于中华人民共和国国内有效(香港、澳门、台湾三地区暂不可使用)。
- 2.自购入之日起在以下期间内，在正常使用中发生故障的情况下进行保修。

- 整机（除商用产品）.....2年内无偿
- 整机（商用产品）.....6个月
- 内刀头、外刀网、刀头、辅助装置、附件.....有偿提供

3.属下列情况之一者，即使在保修期内，也不能以保修对待，但是可以实行收费修理：

- a. 未按商品使用说明书要求使用、维护、保管而造成损坏的；
- b. 因不正确操作、电源不正常、破损（如：摔落等）而造成损坏的；
- c. 不经Panasonic认定维修店维修人员拆卸造成损坏的；
- d. 不能出示本保修证及有效购机发票的；
- e. 保修证上记录的信息与商品实物标识不符或者涂改的；
- f. 因不可抗力因素（如雷电、地震、火灾、水灾等）造成损坏的。

4.本保修条款只适用于消费者个人为生活消费需要而购买使用的场合，不适用于经营性等使用。

【商品信息】

商品名称: 离子蒸汽美容器 产地: 中国·广州

商品型号: EH2424 制造编号:

【保修回执】以下回执是保修的重要依据，请勿自行撕下

商品型号: EH2424	制造编号:	保修结算 4
商品型号: EH2424	制造编号:	保修结算 3
商品型号: EH2424	制造编号:	保修结算 2
商品型号: EH2424	制造编号:	保修结算 1
商品型号: EH2424	制造编号:	促销员留存

保修证管理编码印刷处:

本保修证内容如有变更恕不另行通知

【销售记录】 未完整记录以下信息将可能无法进行保修

销售日期: 发票号码: 安装调试日期: 销售店
(盖章)

顾客姓名: 联系电话:

顾客地址: 邮 编:

销售店名称: 销售店电话:

销售店地址: 邮 编:

【维修记录】

维修店名称: 联系电话: 送修日:

维修店地址: 邮 编:

故障内容: 故障原因:

维修内容:

维修员签字: 交验日期:

维修店名称: 联系电话: 送修日:

维修店地址: 邮 编:

故障内容: 故障原因:

维修内容:

维修员签字: 交验日期:

维修店名称: 联系电话: 送修日:

维修店地址: 邮 编:

故障内容: 故障原因:

维修内容:

维修员签字: 交验日期:

Panasonic客户咨询服务中心:
400-810-0781; 800-810-0781 (固定电话)
Panasonic官方网站: <http://panasonic.cn>

松下电器(中国)有限公司

松下电工·万宝电器(广州)有限公司 (PEWWBG)
Panasonic Electric Works Wanbao(Guangzhou)Co.,Ltd.

工厂地址 : 广州市番禺区市广路万宝基地

(Address) : Wanbao Base, Shiguang Road, Panyu District, Guangzhou

电话(Tel) : (020)84770333

传真(Fax) : (020)84773033

邮政编码(Post Code) : 511495

原产地: 中国