

Panasonic®

Electric Hair Clipper
电动理发器

Model No. ER510
型号 ER510

Operating Instructions 使用说明书



Before operating this unit, please read these instructions completely.
Thank you for purchasing the Panasonic Electric Hair Clipper
Model No. ER510.

在使用前，请仔细阅读此说明书。

承蒙选购Panasonic ER510型电动理发器，在此谨致谢意。

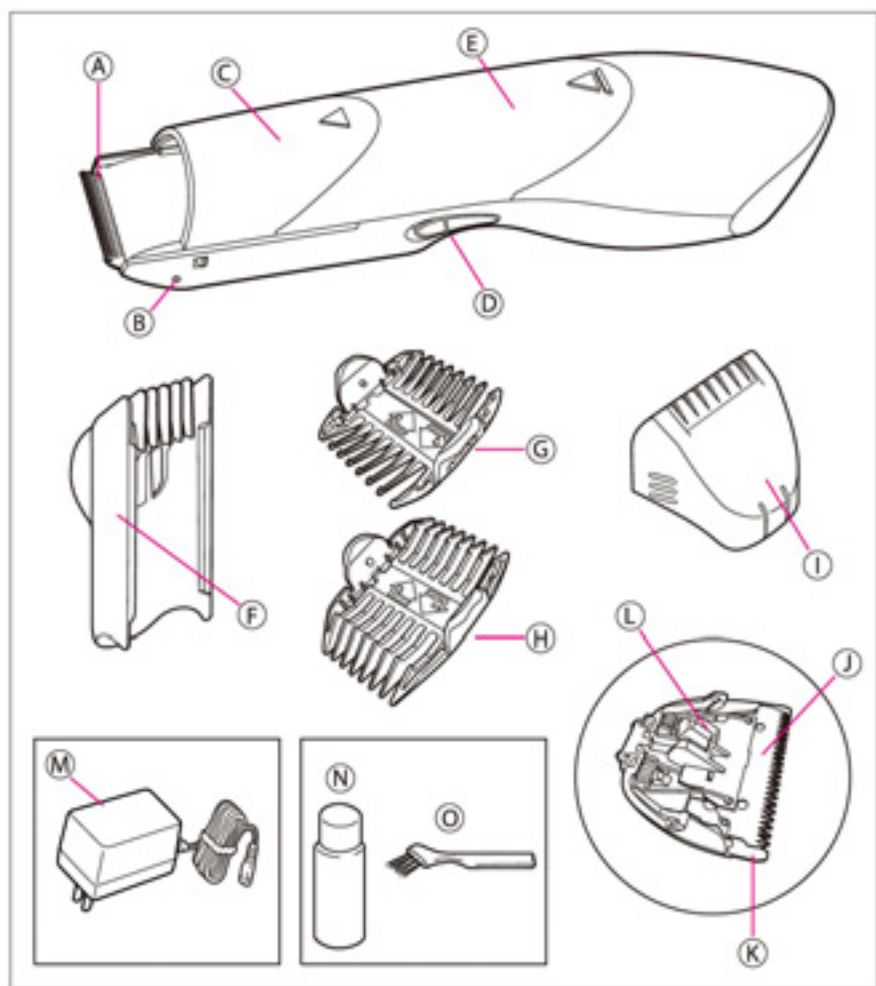

INDEX

ENGLISH

Page 4

中 文

页数 8



Warning

Keep the clipper dry.

Cautions

Do not allow permanent wave lotion, hair restorer or hair spray to come into contact with the main unit of the blades.

- Failure to observe this may result in cracking, discoloring or corrosion.
- Clean the housing using only a cloth slightly dampened with water or a mild soap solution.
- Never use a caustic solution.
- Never submerge the hair clipper in water.
- Keep out of the reach of children.
- Do not use to trim the hair of a pet.
- The hair clipper may become warm during operation and/or charging. This is normal.
- Avoid grabbing the hair clipper by the power cord, as it may become detached, causing damage or injury.
- Never tamper with moving parts.
- If the hair clipper is not working properly, have it inspected at an authorized service center.
- Use the ER510 hair clipper with the RE9-13 adaptor only.
- Do not use the clipper in bathrooms. Failure to observe this may result in electric shocks.
- Keep instructions in a safe place.

<Safety cautions>

Failure to observe the following may result in injuries or physical damage.

- 1) Do not use force to press the blade against the skin, and do not apply excessive pressure to the outer blade.
 - Failure to observe this may result in injuries to the skin or damage to the blades.
- 2) Do not use the clipper for any purpose other than trimming.
- 3) Check that the blades are not damaged or deformed before use.
 - Failure to observe this may result in injuries to the skin.

Parts identification

- Ⓐ Blade
- Ⓑ Attachment mounting
- Ⓒ Slide cover
- Ⓓ Switch
- Ⓔ Dust cover
- Ⓕ 10/20/30/40mm comb attachment
- Ⓖ 3/6mm comb attachment
- Ⓗ 9/12mm comb attachment
- Ⓘ Thinning (1/3) attachment
- Ⓙ Moving blade
- Ⓚ Fixed blade
- Ⓛ Lever for cleaning
- Ⓜ AC adaptor
- Ⓝ Oil
- Ⓞ Cleaning brush

Before use

Before using each time, apply oil at the places marked with arrows in Fig.17.

Operation

- 1) Connect the AC adaptor to the body and set the switch to "1" to use the clipper.
- 2) If the inside of the clipper becomes full of hair during use, the clipper should be cleaned.
- 3) Be sure to set the switch "0" to when finished using the clipper.

10/20/30/40mm 4-Step Comb Attachment

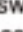
- 1) With the power switch turned off ("0"), lift up slide cover  . (Fig. 3) Adjust the attachment to the desired trimming height by sliding it until a click is felt at one of the 4 steps.

Moving the switch to "1" will lock the attachment so that it cannot slide.





The switch is designed not to work if the attachment is not in the correct position. If the switch will not work, move the attachment up or down to make fine adjustments to its position, while operating the switch.

- 2) Cut hair to the correct height by moving the clipper back against the flow of the hair.
(Actual hair length will be a little

longer than the height you set.) (Fig. 5)
(Do not use the clipper in an inverted position. This can cut hair too deeply.) (Fig. 6)

- 3) Turn off the clipper ("0") before changing the trim height or removing the attachment.

3/6mm, 9/12mm comb attachments

- 1) The cutting heights are indicated on the insides and sides of the attachments, so be sure to look for the height indication in order to mount the attachment correctly for the desired cutting height. (Fig.7)
- 2) Lift up slide cover  . (Fig. 3)
- 3) To mount the comb attachment to the clipper, place one side of the hooks of the comb attachment into the attachment mounting  , then slide the other side to another mounting  in the direction indicated with the arrow. (Fig.8)
- 4) To remove the comb attachment from the clipper, slide one side of the attachment off the mounting  in the direction indicated with the arrow. (Fig.9)

Thinning Attachment

- 1) Lower slide cover  . (Fig. 4)
- 2) To thin hair (1/3 of hair), install the thinning attachment over the trimming blades in the direction of the arrow. (Fig.10)
(Push in until a click is heard.)

- 3) To remove the attachment, push both sides in the directions of the arrow while pulling the attachment. (Fig.11)

Trimming With No Attachments

- 1) Cut hair by placing the clipper head directly on the scalp. (Fig.12)

Cutting without an attachment will trim hair length to 1mm or less.

If slide cover © gets in the way when using the clipper, lower it. (Fig. 4)

Cleaning out hair clippings from inside the clipper

Check if any hair clippings have collected inside the clipper.

If the clipper is full of hair clippings, clean out the clippings.

- 1) 1 Push the bottom of the dust cover.
- 2 Slide the cover forward.
- 3 Lift up the cover by the edge.
- 2) Remove any hair clippings from inside the attachment moulding and the dust cover.
- 3) 1 Place the dust cover onto the clipper.
- 2 Slide the cover until it clicks into place.

Blade care

Hold the handle of the hair clipper firmly with the "Panasonic" name facing upward and push the upper part of the blade away from the housing (see fig.13). Using the brush, clean the blade block and depress the cleaning hook to open the blade in order to remove hair

which may be caught between the blades (see fig.16). Lubricate the space between the stationary and moving blades with 2 or 3 drops of oil after every few uses. To reassemble, first, set the dial ① to "2.0 mm", and reverse the above procedure, pushing the blade block until it clicks firmly into position (see fig.14).

Life of the blade

Blade life will vary according to the frequency and length of use. The life of the blades is expected to be about 6 years when using the clipper twice a month for 20 minutes each time. If cutting efficiency is reduced substantially despite proper maintenance, the blades have exceeded their service life and should be changed.

Specifications

Power source: a.c 220V ~ 50Hz

Weight : 260g

The unit is applied to the Chinese standard GB4706.1 appendix B, GB4706.9 and Q/(GZ)PEWWBG 6.

After service

We pledge our product of the best quality, at the same time, you will enjoy our free of charge after service. In two years from the date of purchase, if the appliance has any damage caused because of the manufacturing technological or raw and processed materials, we will offer the free charge service for you.

Please fill in the certificate and ask for invoice or valid purchase voucher, if by any chance when your appliance broken down, no matter during guarantee time or not, you always get a high quality service in our service center or special repair shop.

警告

本理发器不可水洗

注意事项

请勿让 [烫发液]、[生发药]
[喷发胶] [天那水] [汽油]
[酒精] 接触机身，否则可能会
造成机身变色或损坏。

- 只能用稍微浸有水或中性肥皂水的软布，来清洁机身。
- 绝对勿使用腐蚀性溶液。
- 绝对勿将理发器浸泡在水中。
- 请置于儿童触摸不到的地方。
- 勿用于修剪宠物的毛发。
- 使用或充电期间，理发器可能会变热。这是正常现象。
- 勿让电源线缠住理发器，否则，它可能会分离，从而导致机身损坏或触电危险。
- 请勿擅自移动刀片部件。
- 如果理发器无法正常工作，请拿到指定的维修中心检修。
- 型号RE9-13变压器仅限于与ER510理发器配合使用，禁止用于其它电器。
- 请勿在浴室使用，否则易发生触电。
- 请妥善保管本说明书。

安全事项

若不遵守以下操作将会导致意外伤害或身体损伤。

- 1) 请勿强行将刀片按压于皮肤上，也不要施加过重压力在外部刀片上。
 - 否则，可能会导致皮肤受伤或刀片损坏。
- 2) 请勿将本理发器用于修理头发以外的任何其它用途。
- 3) 在使用前请确认刀刃是否损坏或变形。
 - 否则，可能会导致皮肤受损。

部件名称

- ④ 刀刃

- ⑩ 配件安装槽
- © 滑动盖
- ⑨ 0/1 开关
- ⑪ 发屑储藏盒盖
- ⑦ 10/20/30/40毫米可调节档位配件
- ③ 3/6毫米定长配件
- ⑧ 9/12毫米定长配件
- ① 削发配件(1/3)
- ① 可动刃
- ⑥ 固定刃
- ① 清洁压柄
- ⑧ 变压器
- ⑧ 润滑油
- ⑨ 清洁刷

使用本理发器之前

在每次使用本理发器前，请在固定刃和可动刃之间加入2-3滴润滑油(见图17)。

操作

- 1) 将变压器的电源线连接到本理发器，再将变压器连接至交流电源插座(a.c 220V)，并将开关调至1档以启动本理发器。
- 2) 如果在使用时，本理发器内积满碎发，应及时进行清理。
- 3) 当停止使用本理发器时，请确保开关调至0档后，将变压器拔出。

10/20/30/40毫米 可调节档位配件

- 1) 关闭开关(0档)，推起滑动盖©(图3)，将该配件调整至所需修剪高度，直到感觉4档中的某一档发出[啲]一声。将开关移动至“1档”会锁定该配件使其不能移动。如果该配件没有安置在正确的位置，开关将不能开启。只有关闭开关(0档)，才能将该配件提起或下压，以进行所需调整位置后，再打开开关。
- 2) 逆着头发生长方向移动本理发器，将头发修剪至恰当高度。

(修剪出的实际头发长度将会略长于您所设定的高度。)(图5)

(请勿沿相反方向使用本理发器，这将导致修剪的头发过短)(图6)

- 3)在调整修剪高度或更换配件前请关闭开关(调整至“0档”)。

3/6mm, 9/12毫米定长配件

- 1)定长配件可修剪的长度在定长配件内侧予以标示。请根据所需修剪头发高度正确安装配件(图7)。
- 2)推起滑动盖C(图3)。
- 3)将定长配件一侧的卡口固定进凹槽⑥，顺势滑动定长配件的另一侧，沿箭头所示方向卡入另一侧凹槽⑥(图8)。
- 4)从机身拆卸定长配件时，按箭头所指方向将定长配件一侧划出凹槽⑥(图9)。

削发配件

- 1)下压滑动盖C(图4)。
- 2)削薄头发时(发量的1/3)，请按照箭头所示方向安装削发配件(图10)。(往下推直到听见卡口扣合的声音)
- 3)将削发配件拆离机身时，按箭头所示方向按压配件两侧同时向外拉出削发配件(图11)。

不用配件的修剪方式

将机身顶端直接靠近头皮修剪头发(图12)。不用任何配件修剪头发将会将头发长度修剪为1毫米或更短。如果滑动盖C在修剪时阻碍修剪，请将其下压。

清理碎发

检查本理发器的发屑储藏盒盖内是否积有碎发。如果其内已经积满碎发，请及时清理。

- 1)1、按本理发器右侧标示的箭头相反方向推压发屑储藏盒盖底部(▲)。
- 2、向外滑动盖子。
- 3、拉起盖子的边缘。
- 2)将所有碎发从储藏盒盖到滑动盖全部扫除。

- 3)1、将储藏盒盖和滑动盖右侧标示线对齐理发器标示箭头尾部，并沿箭头方向滑动装入本理发器。
- 2、滑动盖子直至听见[啪]一声。

刀刃保养

- 1)先关闭开关，将本理发器脱离交流变压器。牢固地握住修剪器的机身，使“Panasonic”品牌面朝上，然后推压刀刃，使刀刃与外壳脱离，为防止刀刃飞出，使另外一只手托住(见图13)。
- 2)用刷子清洁刀刃(图15)。为了清除可能夹在刀片之间的碎发，请下压清洁压柄，打开刀片(图16)。
- 3)刀刃安装，将本理发器身上的刀刃口与安装卡口接合，推动直至听到[啪]一声(图14)。

刀片寿命

刀片的寿命依据使用频率和使用时间长短而定。按照使用本理发器的时间为每个月两次，每次20分钟计算，刀片的预期寿命为6年。如果妥善保养刀片依然出现修剪效率大幅下降的情况，此时刀片便已超出使用寿命，请及时更换。

规格

电源方式：交流电
 额定电压：a.c 220V ~ 50Hz
 重量：260g(机身)
 本电动理发器符合GB4706.1附录B、GB4706.9和Q/(GZ)PEWWBG 6标准。

售后服务

在保证本产品品质优良的同时，您将享有我公司的免费服务保证。从购买之日起二年内，若发生任何因制造工艺或原器件造成之损坏，我们将为您提供免费的门市维修服务，请填好保

修证并向购买店索取发票或有效购买凭证，以备万一发生之用。无论在保修期内或保修期后，您皆可在服务中心或特约维修店获得优质的维修服务。如有任何问题，请与我们联系。

Panasonic®

保 修 内 容

有关保修期内Panasonic商品的无偿修理，从购入之日起开始实施。

保修期内所保修的内容具体如下：

1. 保修期内的商品可在松下认定维修店进行保修，保修时，请出示保修证及购机发票。
 - a. 本保修证遗失后不再补发；
 - b. 本保修证仅限于中华人民共和国国内有效(香港、澳门、台湾三地区暂不可使用)。
2. 自购入之日起在以下期间内，在正常使用中发生故障的情况下进行无偿修理。
 - a. 整机……2年内无偿；
 - b. 刀刃……有偿提供；
3. 请注意以下情况，即使在保修期内，也不能以无偿修理对待：
 - a. 不能出示本保修证及购机发票的情况下；
 - b. 保修证的内容未明确记载或未正确记载的情况下；
 - c. 因不正确操作、灾害(地震/火灾/水灾/雷击等)、电源不正常、人为损坏(如：摔落等)所造成故障的情况下；
 - d. 不经松下认定维修店维修人员检查而自行拆修造成故障的情况下；
 - e. 一般家庭以外使用(如工业、商业用)或用于说明书所述的以外使用范围而造成损坏的情况下。
4. 在松下认定维修店以外的地方修理时，即使在保修期内，也为收费修理。

松下电器免费顾客咨询服务中心：8008100781

(未开通800业务地区：010-84713131 / 3232)

松下电器网站：<http://panasonic.cn>

松下电器(中国)有限公司

Panasonic®

电动理发器保修证

销售店记录

商品名称		商品型号	
机身号码		购买日期	
顾客姓名		联系电话	
顾客地址			
销售店名称		销售店电话	
销售店地址			

维修记录

维修店名称		联系电话		送修日	
维修店地址					
故障内容		故障原因			
维修内容		维修员签字			
维修店名称		联系电话		送修日	
维修店地址					
故障内容		故障原因			
维修内容		维修员签字			
维修店名称		联系电话		送修日	
维修店地址					
故障内容		故障原因			
维修内容		维修员签字			

松下电工·万宝电器(广州)有限公司 (PEWWBG)
Panasonic Electric Works Wanbao (Guangzhou) Co.,Ltd.

工厂地址 : 广州市番禺区市广路万宝基地

(Address) : Wanbao Base, Shiguang Road, Panyu District, Guangzhou

电话(Tel) : (020)84770333

传真(Fax) : (020)84773033

邮政编码(Post Code) : 511495