

Panasonic®

使用说明书
Operating Instructions

毛球修剪器
Lint Remover

型号
Model No. ER857

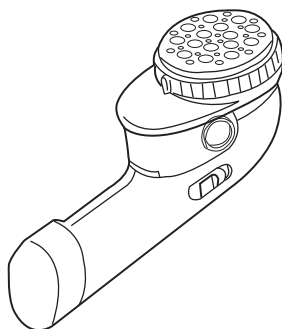

中文	2
English	10

在使用前，请仔细阅读此说明书并妥善保管，以备将来参考。

Before operating this lint remover, please read these instructions completely and save this manual for future use.

各部件名称

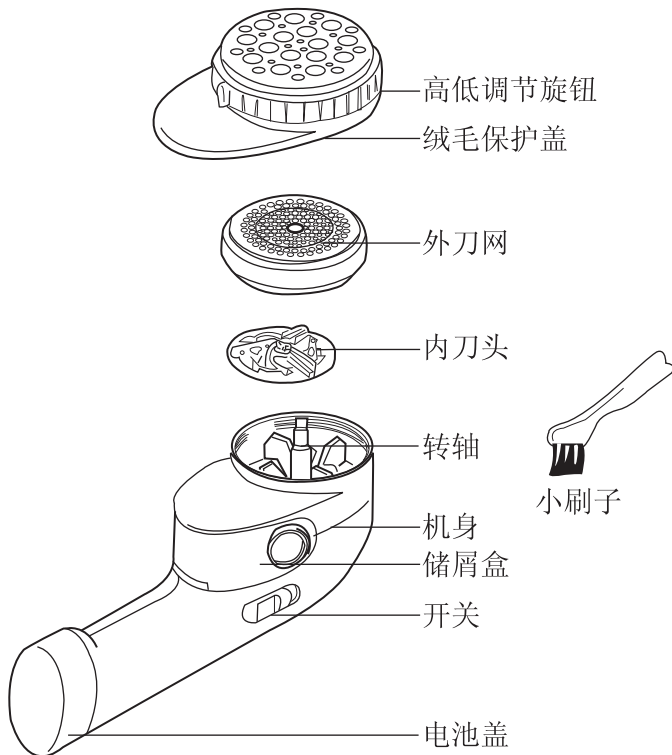

本羽毛球修剪器使用两节LR14(3号)干电池(需另外购买)。

电池的安装

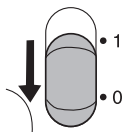

1 关掉电源

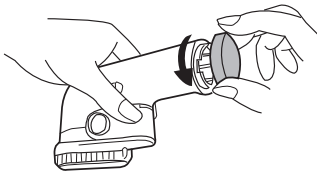

2 拧开电池盖

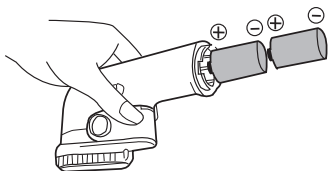

3 装入干电池

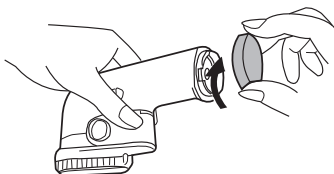

4 拧上电池盖

注意:

- 更换电池前请先关闭电源。
- 不可使用可充电电池。
- 请勿将新旧或不同种类的干电池混合使用，更换电池时建议同时更换。
- 如果长时间不使用本机，请将干电池取出。
- 鼓励消费者在决定废弃本机前，事先征求经销商或 Panasonic 指定维修店的意见，尽量延长本机的使用寿命。
- 电池务必废弃于政府规定的地方或回收处理单位。

使用前

- !** **注意** 禁止使用毛球修剪器处理穿着在身上的衣物，否则可能会造成身体损伤。

防止问题的发生

● 请特别注意以下部位

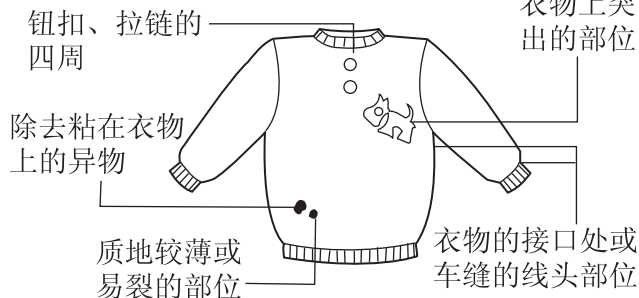

绒毛保护盖的高度调节

● 根据衣物本身绒毛的长度来调节保护盖的高度



- 高 ● 用粗毛线织的衣物
● 手织的较密的毛衣
- 中 ● 较薄且有手感的纯毛编织物
● 用较粗的毛线织的衣物
- 低 ● 薄的编织物
● 夏季针织衣物

- 禁止用于修剪衣物毛球以外的用途。
- 在衣物的不显眼处测试后再使用。
- 当绒毛保护盖调高时，修剪毛球的速度会变慢。

使用方法

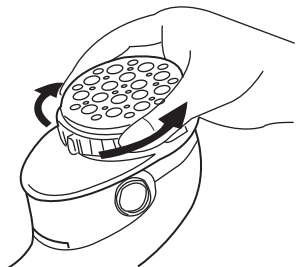

1 调节好绒毛保护盖的高度
用于袜子、运动服请取
下绒毛保护盖

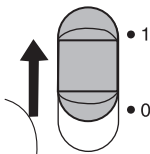

2 打开开关

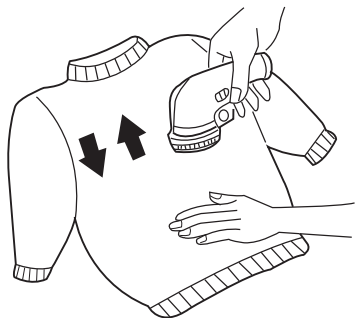

3 将毛球修剪器在摊平的
衣物上来回滑动

- 使用后请装回绒毛保护盖。
- 修剪器有保护功能，请务必拧紧外刀网，否则无法转动。

使用方法

更好地使用修剪器的方法

快速修剪的方法

将机身小幅度在衣物上左右滑动

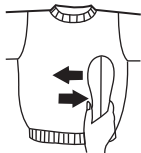

除去顽固的毛球

垂直和平行衣物的纹路滑动

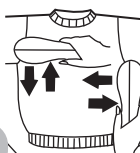

编织花纹的部位

顺着花纹的方向滑动

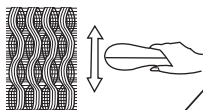

叠成双层并放在烫衣板上修剪毛球

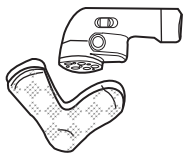

薄质的衣物

滑动时绕过凸出部分

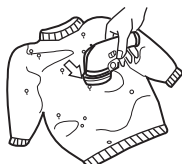

有凸出装饰物的衣物

- 如果不是清洁储屑盒，请不要将其卸下，否则可能会造成身体受伤或机件损坏。
- 不要用于修剪丝袜上的毛球，否则丝袜可能会被吸进刀头而造成损坏。

清洁的方法

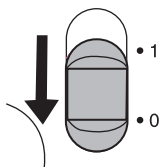

1 关闭开关

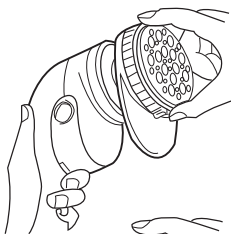

2 取下绒毛保护盖

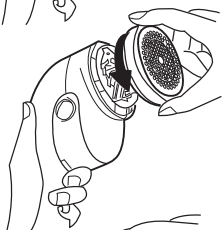

3 拧下外刀网

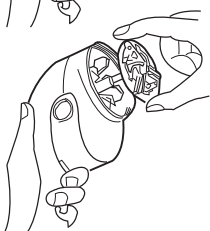

4 取出内刀头

- 取内刀头时注意不要刮伤手。
- 请勿用力压或撞击外刀网。

.....

● 外刀网

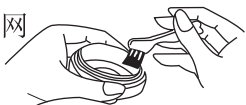

.....

● 内刀头



.....

● 转轴部分



.....

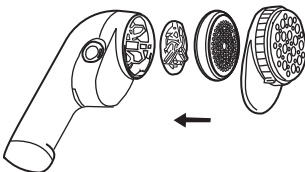
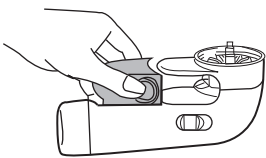

5 用小刷子清扫

6 把储屑盒内的毛屑倒掉

7 按相反顺序装回内刀头、外刀网和绒毛保护盖

- 请用干布擦拭机身。
- 储屑盒请于8成满前清理。
- 外刀网的内侧和内刀头的中央会因藏有毛屑而影响锋利度和转动，请用小刷子清理。

注意事项

- 请妥善处理本产品的包装袋，避免婴幼儿窒息等意外发生；请置于儿童触摸不到的地方。
- 请对儿童进行监督，避免其将本品视为玩具，引发危险。
- 本品不宜供肢体、感官或精神上有残疾者、缺乏经验和知识者（包括儿童）使用，除非有人对此类人加以监督或者对本品的使用加以指导，且对使用者的安全能承担责任。

警告：请保持器具干燥。

规格：

产品名称	毛球修剪器
产品型号	ER857
额定电压	d.c 3V ===
原产地	中国
生产日期	请见商品上刻印
执行标准	Q/SXDGWB 1

规格如有变更，恕不另行通知。

Parts Identification

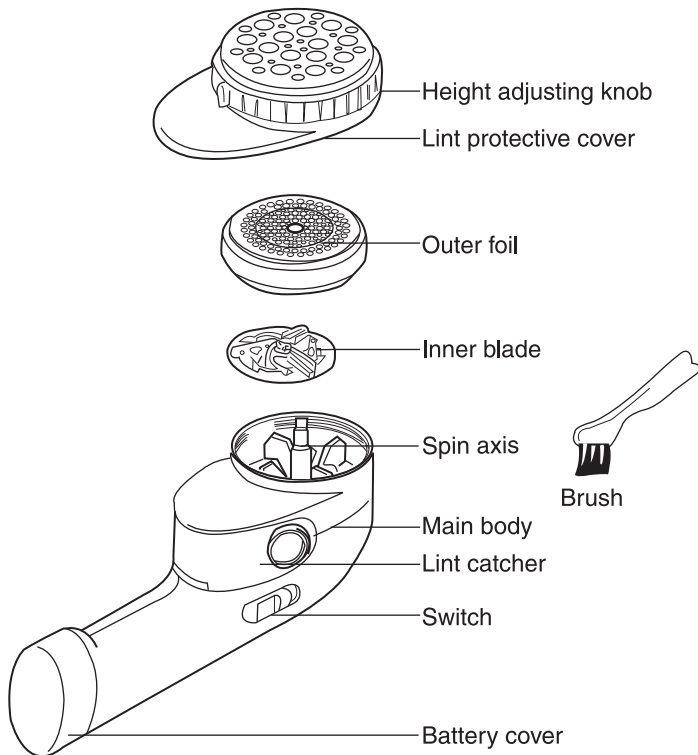

This lint remover uses two C batteries(not included).

Battery Installation

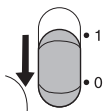

1 Switch off the power

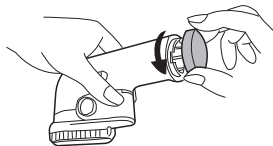

2 Open the battery cover

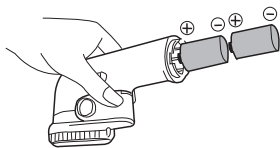

3 Insert the batteries

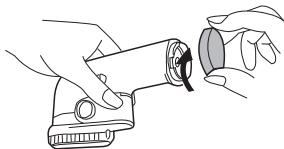

4 Screw on the battery cover

Cautions:

- Turn off the power before replacing the batteries.
- Do not use rechargeable batteries.
- When replacing batteries, we recommend replacing both existing batteries with new batteries at the same time without mixing old and new batteries or batteries of different types.
- If this unit will not be used for a long time, remove the batteries.
- Before deciding to dispose of this unit, we recommend contacting the sales agent or the Panasonic-designated maintenance shop to ask for their comments about extending the machine life of the unit as much as possible.
- When disposing of used batteries, be sure to take them to the local collection place designated by the government.

Before use

Caution: Do not use the lint remover on clothes that you are wearing; otherwise you might be injured.

To prevent problems

• Please pay special attention to the following areas:

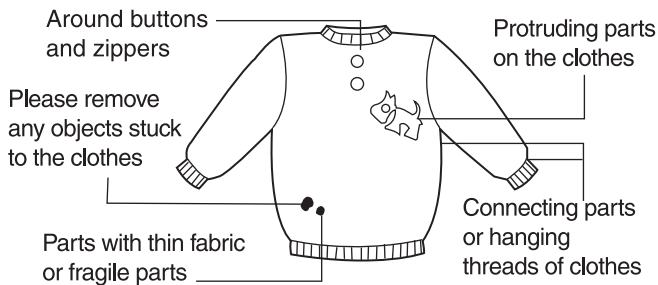

Height adjustment of lint protective cover

● Adjust the height of the protective cover according to the height of the lint of the clothes



- **High(高)** ● Clothes knitted with double knitting wool
- Hand-knit dense sweater
- **Medium(中)** ● Thin and pure wool knitting with hand-made properties
- Clothes knit with comparatively thick knitting wool
- **Low(低)** ● Thin knitwear
- Summer knitwear

- Use of the lint remover for purposes other than to remove lint from clothing is forbidden.
- Test on an inconspicuous part of the clothes before use.
- When the lint protective cover is adjusted higher, the speed of lint removing may be slower.

Use method

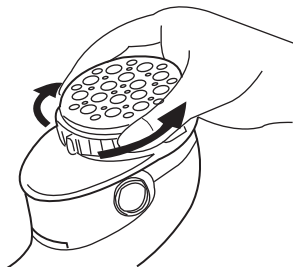

- 1** Adjust the height of the lint protective cover
Take off the lint protective cover when applying it to socks or a sport suit

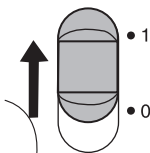

- 2** Turn on the switch

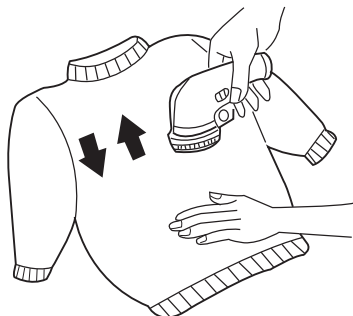

- 3** Slide the lint remover on evenly-spread clothes

-
- Reattach the lint protective cover after use.
 - The remover has a protective function, so please screw the outer foil upward. Otherwise, it cannot rotate.

Use method

A better method to use the remover

Quick clipping method

Slide the main body slightly to the left and right on the clothes

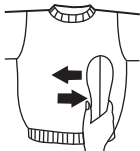

To remove obstinate lint

Slide in parallel and vertical to the grain of the clothes

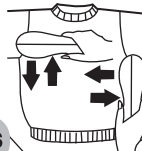

Parts with knit patterns

Slide along the direction of the patterns

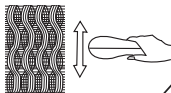

Fold the clothes and put it on the ironing board to remove the lint

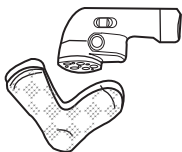

Clothes of thin fabric

Go around protruding parts while sliding

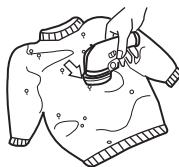

Clothes with protruding decorations

- Do not remove any parts other than the clean lint catcher; otherwise it may cause personal injury or damage to parts of the device.
- Do not use it to remove lint on silk stockings; otherwise the silk stockings may be sucked into the blade and cause damage.

Cleaning method

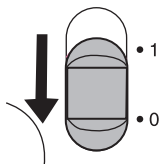

1 Switch off the power

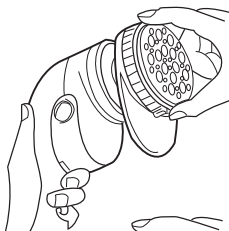

2 Remove the lint protective cover

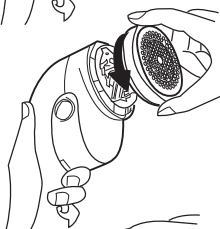

3 Screw out the outer foil

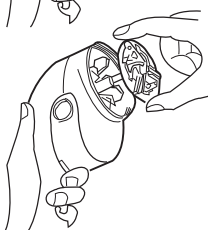

4 Take out the inner blade

- Pay attention not to cut your hand when taking out the inner blade.
- Do not press or strike the outer foil violently.



- Outer foil



5 Use the brush to clean



- Inner blade



6 Empty the lint in the lint catcher



- Spin axis part

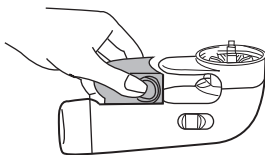

7 Install the inner blade, the outer foil and the lint protective cover according to the reverse sequence.

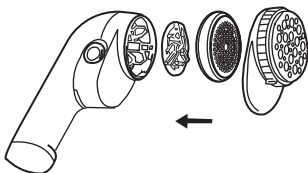

- Please use a dry cloth to clean the main body.
- Empty the lint catcher before it is 80% full.
- The sharpness and rotation can be affected by lint hidden in the inner side of the outer foil and the center of the inner blade, so please use the brush to clean.

Cautions

- Treat the package for this unit properly and store it out of reach of children to prevent sudden accidents such as suffocation of children.
- Monitor children's behavior to prevent children from mistaking this unit for a toy, resulting in a life-threatening accident.
- Do not allow physically or mentally disabled people, and people who lack experience and knowledge (including children) to use this unit unless the person is under the supervision of someone who can instruct the proper use of this unit and take full responsibility for the safety of the user.

Warning: Keep this unit dry.

Specifications

Product name	Lint Remover
Product model	ER857
Rated voltage	d.c 3V 
Place of origin	China
Production date	Please refer to the stamped mark on the product
Executive standard	Q/SXDGWB 1

The specifications are subject to change without prior notice.

Panasonic

保修证

保修条款

有关保修期内Panasonic商品的保修(无偿修理),从购买之日起开始实施。

1.保修期内的商品只可在Panasonic认定维修店进行保修;保修时,请出示本保修证及购机发票。

以下两点需特别注意:

- 本保修证遗失后不再补发,请妥善保管。
- 本保修证仅限于中华人民共和国国内有效(香港、澳门、台湾三地区暂不可使用)。

2.自购入之日起在以下期间内,在正常使用中发生故障的情况下进行保修。

- 整机(除商用产品) ····· 2年内无偿
- 整机(商用产品) ····· 6个月
- 内刀头、外刀网、刀头、辅助装置、附件 ····· 有偿提供

3.属下列情况之一者,即使在保修期内,也不能以保修对待,但是可以实行收费修理:

- 未按商品使用说明书要求使用、维护、保管而造成损坏的;
- 因不正确操作、电源不正常、破损(如:摔落等)而造成损坏的;
- 不经Panasonic认定维修店维修人员拆卸造成损坏的;
- 不能出示本保修证及有效购机发票的;
- 保修证上记录的信息与商品实物标识不符或者涂改的;
- 因不可抗力因素(如雷电、地震、火灾、水灾等)造成损坏的。

4.本保修条款只适用于消费者个人为生活消费需要而购买使用的场合,不适用于经营性等使用。

【商品信息】

商品名称: 羽毛球修剪器 产地: 中国·广州

商品型号: ER857 制造编号:

【保修回执】以下回执是保修的重要依据,请勿自行撕下

商品型号: ER857 制造编号: 保修结算4

商品型号: ER857 制造编号: 保修结算3

商品型号: ER857 制造编号: 保修结算2

商品型号: ER857 制造编号: 保修结算1

商品型号: ER857 制造编号: 促销员留存

保修证管理编码印刷处:

本保修证内容如有变更恕不另行通知

[销售记录] 未完整记录以下信息将可能无法进行保修



销售日期: 发票号码: 安装调试日期:

顾客姓名: 联系电话:

顾客地址: 邮 编:

销售店名称: 销售店电话:

销售店地址: 邮 编:

[维修记录]

维修店名称: 联系电话: 送修日:

维修店地址: 邮 编:

故障内容: 故障原因:

维修内容:

维修员签字: 交验日期:

维修店名称: 联系电话: 送修日:

维修店地址: 邮 编:

故障内容: 故障原因:

维修内容:

维修员签字: 交验日期:

维修店名称: 联系电话: 送修日:

维修店地址: 邮 编:

故障内容: 故障原因:

维修内容:

维修员签字: 交验日期:

Panasonic客户咨询服务中心:
 400-810-0781; 800-810-0781 (固定电话)
 Panasonic官方网站: <http://panasonic.cn>

松下电器(中国)有限公司



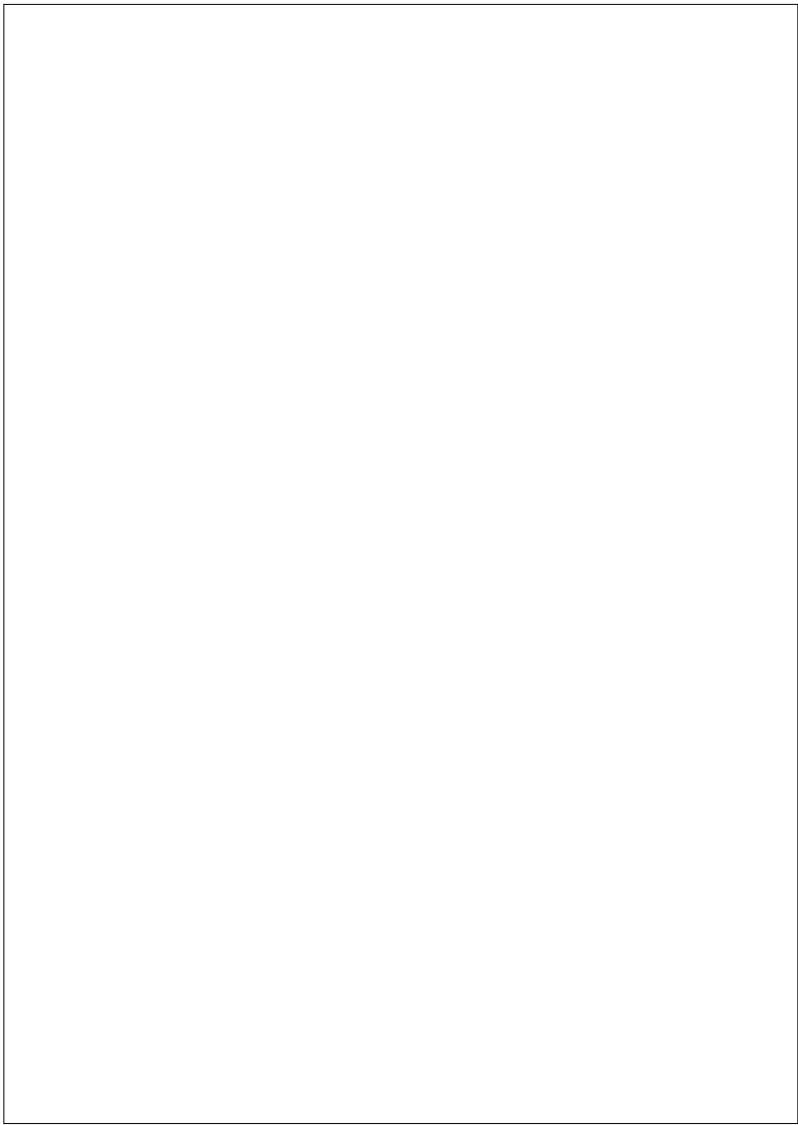

松下电工·万宝电器(广州)有限公司 (PEWWBG)
Panasonic Electric Works Wanbao (Guangzhou) Co., Ltd.

工厂地址：广州市番禺区市广路万宝基地

(Address): Wanbao Base, Shiguang Road, Panyu District, Guangzhou

电话(Tel): (020)84770333

传真(Fax): (020)84773033

邮政编码(Post Code): 511495

原 产 地：中国

中国印刷

Printed in China

ER921085724051 Y0709-11

发行：2009年7月

Ⓜ EN, CH