



# Panasonic®

## 使用说明书 Operating Instructions

### (家用) 女用脱毛器 (Household) Epilator

型号  
Model No. ES-WS20/ES-WS10

中文	2
English	7

在使用前，请仔细阅读此说明书并妥善保管，以备将来参考。

Before operating this unit, please read these instructions completely and save them for future use.

感谢您购买 Panasonic 脱毛器。使用前请仔细阅读说明书所有内容。

## 各部件名称

中文

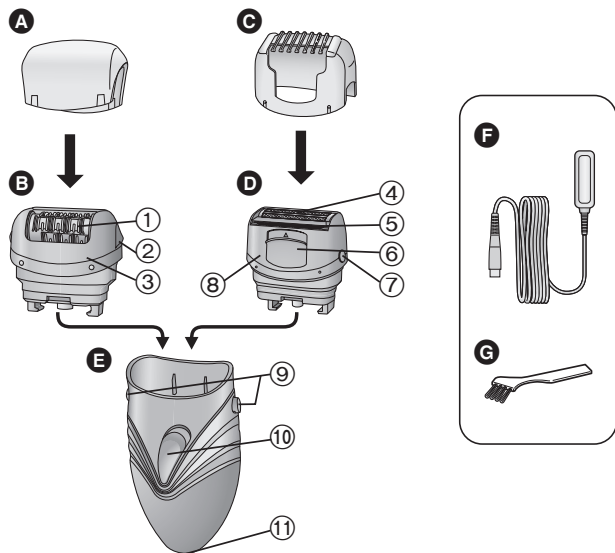

### A 保护盖

### B 手臂 / 腿部脱毛刀头

- ① 脱毛夹轮
- ② 脱毛架装卸按钮
- ③ 脱毛架

### C 比基尼剃毛附件

(▶第 5 页)

### D 剃毛刀头

- ④ 外刀网
- ⑤ 推出式修剪刀
- ⑥ 推出式修剪刀开关
- ⑦ 剃毛架装卸按钮
- ⑧ 剃毛架

### E 本体

- ⑨ 刀头附件装卸按钮
- ⑩ 开关
  - 0 = 关闭
  - 1 = 低速
  - 2 = 正常速度
- ⑪ 充电插口

附属品:

### F 变压器

(请勿使用非本机附送的变压器。)

### G 清洁刷

附件	ES-WS20	ES-WS10
手臂 / 腿部脱毛刀头	√	√
比基尼剃毛附件和剃毛刀头	√	—

## 脱毛的快速步骤

- 1 设置** (▶第 4 页)
- 2 选取刀头** (▶第 4 页)
- 3 脱毛** (▶第 5 页)

## 注意事项

### 警告 - 请保持本产品干燥。

- 使用前请确保皮肤清洁。
- 以下情况，请向您的医生咨询。
  - 患有湿疹或其他皮肤病、皮疹、过敏性皮肤、易受感染、静脉曲张、糖尿病、血友病或凝血不良。
- 以下情况可能会导致细菌侵入皮肤，造成皮肤损伤或发炎。
  - 游泳和体育运动前使用。
  - 与他人共用本产品。
- 打开电源开关时，请务必将脱毛刀头及其脱毛架或剃毛刀头及其剃毛架装到脱毛器上。否则可能会导致手指损伤，毛发卷入转齿轮或发生机械故障。
- 使用时不可让脱毛夹轮接触头发。
- 以下情况可能会导致敏感性皮肤损伤、受伤、发炎、疼痛、流血、剧烈疼痛。
  - 当脱毛夹轮、脱毛架或外刀网损坏时使用本产品。
  - 在脸部、外阴部、疣、丘疹、瘀伤或脱皮处使用本产品。
  - 在色素痣周围使用本产品。
  - 对皮肤施加过大的压力，反复在同一处移动或猛戳皮肤。
  - 在经期前或经期、孕期以及产后约一月内使用。
  - 在生病及晒伤等情况下使用。

### ► 使用变压器

- RE7-46 变压器只能与本产品配合使用，不能用于其它的产品或用途。
- 切勿用湿手将变压器取出或插入插孔。

### ► 使用脱毛器

- 当电源软线或变压器损坏或过热时，或者电源软线插头没有在家用电源插座上插紧时，切勿使用本产品。

- 请勿掉落或重击本产品，否则脱毛架或脱毛夹轮可能会损坏。
- 电源软线不能更换，如果软线损坏，此器具应废弃。
- 请妥善处理本产品的包装袋，避免婴幼儿窒息等意外发生。请置于儿童触摸不到的地方。
- 本品不宜供肢体、感官或精神上有残疾者、缺乏经验和知识者（包括儿童）使用，除非有人对此类人加以监督或者对本品的使用加以指导，且对使用者的安全能承担责任。请对儿童进行监督，避免其将本品视为玩具，引发危险。
- 推荐使用温度为 0-35 °C。  
如果在推荐范围以外的温度下使用本产品，本产品可能停止工作。
- 请勿使用手臂、腿部脱毛刀头进行腋下和比基尼线的脱毛。
- 请勿在入浴或淋浴时使用本产品。

### ► 清洁脱毛器

- 定期清洁电源软线插头，防止落尘。
- 请勿使用洗甲水、汽油、酒精等来清洁本产品。
- 清洁本产品前，请务必将变压器从家用电源插座和本产品中拔出来。
- 仅限用于布擦拭本体。使用酒精等可能导致本体变色或变形。
- 清洁时注意不要损坏脱毛架。
- 请勿对产品进行浸水，淋水或用清水洗，以免可能引起触电或短路。

### ► 存放脱毛器

- 请勿弯折、扭曲、拉扯或改装电源软线。
- 请勿将电源软线紧紧缠绕在本产品上。
- 请将本产品放置在儿童或病人够不着的地方。
- 本产品使用后的放置应远离水池、浴室或其他暴露于水或湿气下的高湿度区域附近。

✕  
✕

- 本产品的放置应远离暴露于高温或直射阳光的地方。
- 存放脱毛器时，请务必给脱毛刀头装上保护盖，给剃毛刀头装上比基尼剃毛附件。

中文



## 有效脱毛的技巧

- 脱毛效果并不能永久保持，因此我们建议第二次使用后，**每两周**手臂和腿部脱毛一次左右。
- 当您初次脱毛，或一段时间内首次使用时，可能会感到相当疼痛。因此我们建议在使用前先温暖皮肤，使皮肤变得柔软。
- 将脱毛器与皮肤表面呈 90° 角。务必确保本产品接触皮肤并轻轻按住皮肤，逆着毛发的生长方向**缓缓**移动。

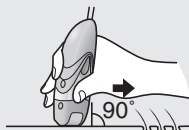

- 使用沐浴棉进行按摩可能有助于防止毛发向皮内生长。
- 使用后可能出现红斑点。如果感到疼痛或出现疱疹，可用冷毛巾进行冷敷。
- 如果脱毛后皮肤变干，我们建议在脱毛后涂抹保湿乳液两天。

## 使用前

### 设置

本产品只能用于“干式脱毛”。使用时，必须将其插入电源插座。

1. 将**变压器**插入**脱毛器** (a) 和**家用电源插座** (b) 中。

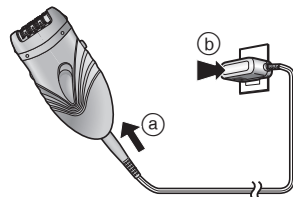

### 更换刀头

- 1 按住刀头装卸按钮，卸下刀头。
- 2 装入刀头直至其“咔嚓”就位。

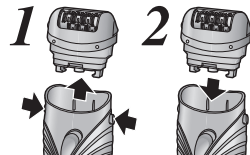

### 适合脱毛的最佳毛发长度

在首次脱毛或者长期未脱毛时请先进行剃毛。毛发长度较短时脱毛更容易，而且疼痛感较少。

< 手臂 / 腿部 >



将毛发长度剪短到 2 mm 到 3 mm 之间。

您可以使用比基尼剃毛附件将毛发长度剪短到 2-3 mm 之间。

(仅限 ES-WS20)

## 使用比基尼剃毛附件

将比基尼剃毛附件安装在剃毛刀头上，并将推出式修剪刀开关向上滑动。

• 请确保比基尼剃毛附件紧贴皮肤。

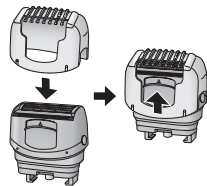

## 脱毛

脱毛前请擦去皮肤上的水渍或汗渍。

脱毛之前，请先铺垫好纸或其他物品，用来接住脱落的毛发。

### 适合脱毛的区域

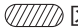
可在  区域上使用脱毛器。

在其他区域上使用脱毛器可能会导致疼痛或皮肤问题。

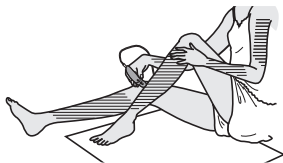

### 不适合脱毛的区域

不应在上臂内侧以及肘部或膝盖等皮肤较松弛的区域使用脱毛器。



**1** 将开关 [ⓐ⑩] 滑动到 1（低速）或 2（正常速度）位置进行脱毛。

• 如果您担心在脱毛过程中会感到疼痛，请使用 1（低速）设置。

### < 手臂或腿部脱毛 >



从下向上移动。  
从外侧向内侧移动。



## 剃毛刀头的使用方法

剃毛前请擦去皮肤上的水渍或汗渍。

**1** 装上剃毛刀头 [ⓐ]。

**2** 卸下比基尼剃毛附件 [ⓐ]。

**3** 确认外刀网没有变形或损坏。

**4** 将开关 [ⓐ⑩] 滑动到 1（低速）或 2（正常速度）位置进行剃毛。

• 轻轻按压，使整个刀头与皮肤紧密接触，这样刀面不会上下移动。

## 清洁方法

使用后必须清洁脱毛架和脱毛夹轮，使其保持清洁。  
清洁前关闭脱毛器电源开关并拔除电源插头。

中文

1. 按住脱毛架装卸按钮【③②】或按下剃毛架装卸按钮【①⑦】两侧，向上提起可取出脱毛架或剃毛架。

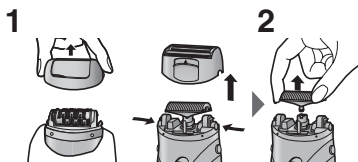

2. 轻按剃毛刀头两侧，垂直向上可取出剃毛刀头。

3. 使用清洁刷【④】清洁脱毛刀头【⑤】、剃毛刀头【⑥】和剃毛内刀头。

- 清扫时，不应用力过大，以免使刀刃破损。
- 推出修剪刀【①⑤】，用清洁刷可以清扫修剪刀上聚集的毛屑。
- 用干布擦拭本体上的毛发。

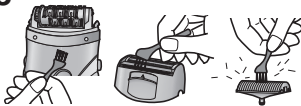

## 更换外刀网

我们建议外刀网【①④】每年更换一次，内刀头每两年更换一次。仅当更换剃毛刀头【①】的外刀网时才可将其卸下。

1. 当用手指轻轻推动外刀网时，用指甲将刀头上的塑料嵌板【②】从刀架内侧的挂钩【③】上脱开。
2. 新的外刀网应稍稍弯曲并推入，直至其挂扣到刀架中。

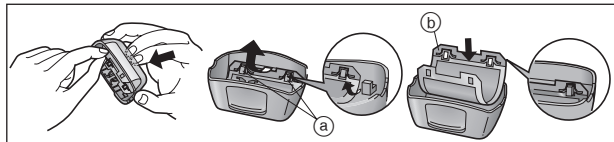

## 规格

产品名称	女用脱毛器	
产品型号	ES-WS20/ES-WS10	
变压器额定输入	100-240 V ~, 180 mA	
变压器额定输出	5.4 V ---, 1.2 A	
马达电压	5.7 V ---	
原产地	中国	
生产日期	请见商品上刻印	
执行标准	中国标准	GB4706.9
	企业标准	Q/SXDGWB 6

规格如有变更，恕不另行通知。  
本产品仅适合家庭使用。

Thank you for choosing a Panasonic epilator. Please read all instructions before use.

## Parts identification

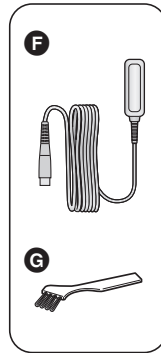
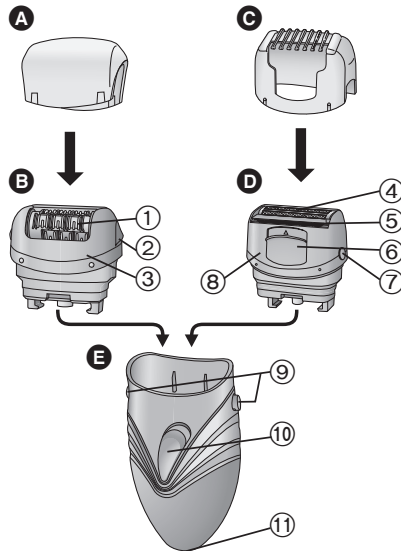

### A Protection cap

### B Epilation head for legs/arms

- ① Epilation discs
- ② Frame release rib
- ③ Frame

### C Bikini comb (➡Page 10)

### D Shaver head

- ④ Outer foil
- ⑤ Trimmer
- ⑥ Pop-up trimmer switch
- ⑦ Frame release button
- ⑧ Frame

### E Main body

- ⑨ Head release button
- ⑩ Switch
  - 0 = off
  - 1 = low speed
  - 2 = normal speed
- ⑪ Socket

Accessories:

**F Adaptor/power cord**  
(Do not use adaptors/  
power cords other than  
the ones provided.)

### G Cleaning brush

Attachments	ES-WS20	ES-WS10
Epilation head for legs/arms	✓	✓
Bikini comb & Shaver head	✓	—

## Quick steps for epilating

- 1 Setting up** (➡Page 10) ▶ **2 Selecting the head** (➡Page 10) ▶ **3 Epilating** (➡Page 10-11)

## Important

WARNING - Keep the appliance dry.

- Make sure skin is clean before and after use.
- In the following cases, please consult your physician.
  - Having eczema, rashes, sensitive skin, proneness to infections, varicose veins, diabetes, hemophilia, poor blood clotting or other skin conditions
- The following might result in bacteria entering the skin and cause damage and inflammation.
  - Using just before swimming and sports activities
  - Sharing with other persons
- Always attach an epilation head and its frame or a shaver head and its frame to the epilator when turning on. Failure to do so might cause finger injury, hair entanglement in the spinning gears or mechanical malfunction.
- When using, do not let the epilation discs touch the hair.
- The following might cause sensitive skin damage, injury, inflammation, pain, bleeding, and severe pain.
  - Using the appliance if the epilation discs, the frame, or the outer foil have been damaged.
  - Using on or near your face, genitals, warts, pimples, bruises, rashes, wounds or loose skin.
  - Using around moles.
  - Applying strong pressure to the skin, repeatedly moving over the same area or using a jabbing motion.
  - Using before or during menstruation, pregnancy, about one month after giving birth.
  - Using when ill, sunburned, etc.

## ► Using the adaptor

- Use the RE7-46 adaptor only for this epilator. Do not use it for other appliances or for other purposes.
- Never remove or insert the adaptor into the socket with wet hands.

## ► Using the epilator

- Never use the appliance if the cord or the adaptor is damaged, overly hot or if the plug fits loosely in a household outlet.
- Do not drop or hit the appliance as the frame or the epilation discs can be damaged.
- The cord is not replaceable. If the cord is damaged, the adaptor should be scrapped.
- Please properly store or dispose of the package of the appliance to avoid any accidents, such as infant suffocation, etc.  
Keep the package away from infants.
- This appliance is not intended for use by persons (including children) with reduced physical, sensory or mental capabilities, or lack of experience and knowledge, unless they have been given supervision or instruction concerning use of the appliance by a person responsible for their safety.  
Children should be supervised to ensure that they do not play with the appliance.
- The recommended use temperature is 0-35 °C.  
If you use the appliance in temperature outside of the recommended range, it may stop functioning.
- Do not use the epilation head for legs/arms to epilate your underarms and bikini-line.



- Do not use the appliance while bathing or being in the shower.

### ► Cleaning the epilator

- Regularly clean the cord connector to prevent dust.
- Do not use nail polish remover, benzene, alcohol, etc. to clean the appliance.
- Always unplug the adaptor from a household outlet and from the epilator before cleaning the appliance.
- Wipe the main body only with a dry cloth. The use of alcohol etc. might cause discoloration or deformation of the main body.
- Take care not to damage the frame during cleaning.
- Do not immerse the appliance in water, spray or clean with water. Otherwise, electric shock or short circuit may occur.

### ► Storing the epilator

- Do not bend, twist, pull, or modify the cord.
- Do not wrap the cord tightly around the appliance.
- Keep the appliance out of the reach of children or invalids.
- Keep the appliance away from sinks, bathrooms or other high-humidity areas where it could be exposed to water and moisture after use.
- Keep the appliance away from where it will be exposed to high temperatures or direct sunlight.
- When storing the epilator, always attach the protection cap for the epilation head and the bikini comb for the shaver head.



### Tips for best epilation results

- The hair removal is not permanent, so after the 2nd use we recommend that you epilate the arms and legs about **once every two weeks**.
- When epilating for the first time, or when using for the first time in a while, you may feel considerable pain. Therefore we recommend warming the skin to soften the skin before use.
- Apply the epilator at a 90° angle to your skin. Always make sure that the appliance is in contact with your skin and press gently while moving it **slowly** against the hair growth.
- Massaging with a body puff may help to prevent ingrown hairs.
- Reddening might appear after use. A cool towel will help if you feel pain or there is a rash.
- If your skin gets dry after epilation, we recommend applying a moisture lotion two days after epilation.

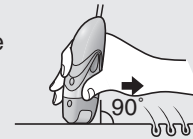

## Before use

### Setting up

This appliance can only be used for Dry Epilation. It must be plugged into an electrical outlet when in use.

1. Plug the adaptor/power cord into the epilator (a) and a household outlet (b).

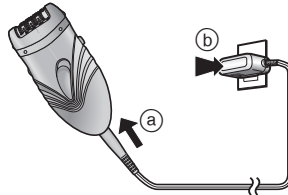

### Changing the head

- 1 Remove the head while holding the head release button.
- 2 Push the head until it clicks.

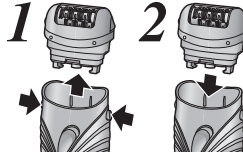

### Best length of hair for epilation

Trim your hair before epilating for the first time or if you have not epilated for a long time. Hair removal is easier and less painful when the hair is short.

<Legs/arms>

English



Cut your hair to between 2 mm and 3 mm long. You can shave hair leaving the length of 2-3 mm by using the bikini comb attached. (ES-WS20 only)

10

## Using the bikini comb

Place the bikini comb onto the shaver head and slide trimmer up.

- When the bikini comb is in place, make sure the comb is in close contact with the skin.

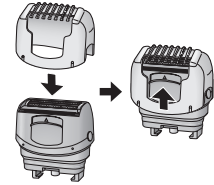

## Epilating

Before epilating, wipe away water or sweat on your skin. Before epilating, spread out paper etc. to catch the falling hairs.

### Areas suitable for epilation

The epilator can be used on the  areas. Using the epilator on other areas may cause pain or skin trouble.

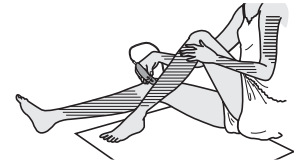

### Areas not suitable for epilation

The epilator should not be used on the inner side of the upper arms and areas such as elbows or knees which are prone to sagging.



# 1 Slide the switch [B10] to the 1 (low speed) or 2 (normal speed) position and carry out epilation.

- If you are concerned about pain during epilation, then please use with 1 (low speed) setting.

## <Epilating legs or arms>



Upwards from the bottom of the leg.  
Inwards from the outside of the arm.



## Shaving

Before shaving, wipe away water or sweat on your skin.

- 1 Attach the shaver head [D].
- 2 Remove the bikini comb [C].
- 3 Check that the outer foil is not deformed or damaged.
- 4 Slide the switch [B10] to the 1 (low speed) or 2 (normal speed) position and carry out shaving.
  - Press gently so that the whole blade is in close contact with the skin and the surface of the blade does not move up and down.

## Cleaning

Always clean the frames and discs after use to keep them in a hygienic state.

Switch off and unplug the appliance before cleaning.

1. While holding the frame release rib [B2] or pressing the sides of the frame release button [D7], lift the frame up to remove it.

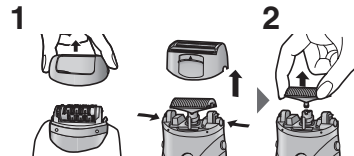

2. Press both sides of the inner blade and lift it up vertically to remove the inner blade.

3. Clean the epilation head [B], the shaver head [D] and the inner blade with the cleaning brush [G].

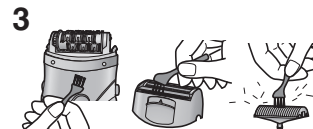

- When cleaning, do not use excessive force as the blade may be damaged.
- Push the trimmer [D5] out, and remove the hairs accumulated on the trimmer with the cleaning brush.
- Wipe the hair off the main body with a dry cloth.

## Replacing the outer foil

We recommend replacing the outer foil **(b)** **every year** and the inner blade **every two years**. Remove the outer foil of the shaver head **(a)** only when replacing it.

**1. While pushing the outer foil gently with the fingers, use a fingernail to release the plastic panel (b) on the blade from the hooks (a) on the inside of the frame.**

**2. The new outer foil should be slightly bent and pushed in until it is hooked in the frame.**

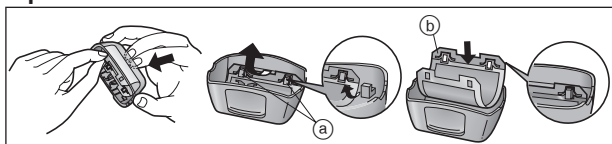

## Specifications

Product name	Epilator	
Product model	ES-WS20/ES-WS10	
Rated input	100-240 V ~, 180 mA	
Rated output	5.4 V ---, 1.2 A	
Motor voltage	5.7 V ---	
Place of origin	China	
Date of production	See engraving on the commodity.	
Execution standard	Chinese standard	GB4706.9
	Company standard	Q/SXDGWB 6

Specifications are subject to change without notice.  
This product is intended for household use only.

Panasonic

# 保修证

## 保修条款

有关保修期内Panasonic商品的保修（无偿修理），从购入之日起开始实施。

1. 保修期内的商品只可在Panasonic认定维修店进行保修；保修时，请出示本保修证及购机发票。  
以下两点需特别注意：

- a. 本保修证遗失后不再补发，请妥善保管。
  - b. 本保修证仅限于中华人民共和国内有效（香港、澳门、台湾三地区暂不可使用）。
2. 自购入之日起在以下期间内，在正常使用中发生故障的情况下进行保修。
- 整机（除商用产品）.....2年内无偿
  - 整机（商用产品）.....6个月
  - 内刀头、外刀网、刀头、辅助装置、附件.....有偿提供

3. 属下列情况之一者，即使在保修期内，也不能以保修对待，但是可以实行收费修理：

- a. 未按商品使用说明书要求使用、维护、保管而造成损坏的；
- b. 因不正确操作、电源不正常、破损（如：摔落等）而造成损坏的；
- c. 不经Panasonic认定维修店维修人员拆卸造成损坏的；
- d. 不能出示本保修证及有效购机发票的；
- e. 保修证上记录的信息与商品实物标识不符或者涂改的；
- f. 因不可抗力因素（如雷电、地震、火灾、水灾等）造成损坏的。

4. 本保修条款只适用于消费者个人为生活消费需要而购买使用的场合，不适用于经营性等使用。

### [商品信息]

商品名称: **女用脱毛器** 产地: 中国·广州  
商品型号: ES-WS20/ES-WS10 制造编号:

**[保修回执]** 以下回执是保修的重要依据，请勿自行撕下

商品型号: ES-WS20/ES-WS10 制造编号: **保修结算4**

商品型号: ES-WS20/ES-WS10 制造编号: **保修结算3**

商品型号: ES-WS20/ES-WS10 制造编号: **保修结算2**

商品型号: ES-WS20/ES-WS10 制造编号: **保修结算1**

商品型号: ES-WS20/ES-WS10 制造编号: **促销员留存**



保修证管理编码印刷处：

本保修证内容如有变更恕不另行通知

**[销售记录]** 未完整记录以下信息将无法进行保修

销售日期：..... 发票号码：.....

安装调试日期：

销售店  
(盖章)

顾客姓名：..... 联系电话：.....

顾客地址：..... 邮 编：.....

销售店名称：..... 销售店电话：.....

销售店地址：..... 邮 编：.....

**[维修记录]**

维修店名称：..... 联系电话：..... 送修日：.....

维修店地址：..... 邮 编：.....

故障内容：..... 故障原因：.....

维修内容：.....

维修员签字：..... 交验日期：.....

维修店名称：..... 联系电话：..... 送修日：.....

维修店地址：..... 邮 编：.....

故障内容：..... 故障原因：.....

维修内容：.....

维修员签字：..... 交验日期：.....

维修店名称：..... 联系电话：..... 送修日：.....

维修店地址：..... 邮 编：.....

故障内容：..... 故障原因：.....

维修内容：.....

维修员签字：..... 交验日期：.....

Parasonic客户咨询服务中心：

400-810-0781；800-810-0781 (固定电话)

Parasonic官方网站：<http://panasonic.cn>

松下电器(中国)有限公司





**松下电工 • 万宝电器(广州)有限公司 (PEWWBG)**  
**Panasonic Electric Works Wanbao (Guangzhou) Co., Ltd.**

工厂地址: 广州市番禺区市广路万宝基地  
(Address): Wanbao Base, Shiguang Road,  
Panyu District, Guangzhou

电话(Tel): (020)84770333

传真(Fax): (020)84773033

邮政编码(Post Code): 511495

原产地: 中国

中国印刷  
Printed in China  
0000000000 X0000-0  
发行: 2010年00月