

Panasonic®

使用说明书

Operating Instructions

无绳蒸汽电熨斗 Electric Cordless Steam Iron

型号/Model No. NI-L88R

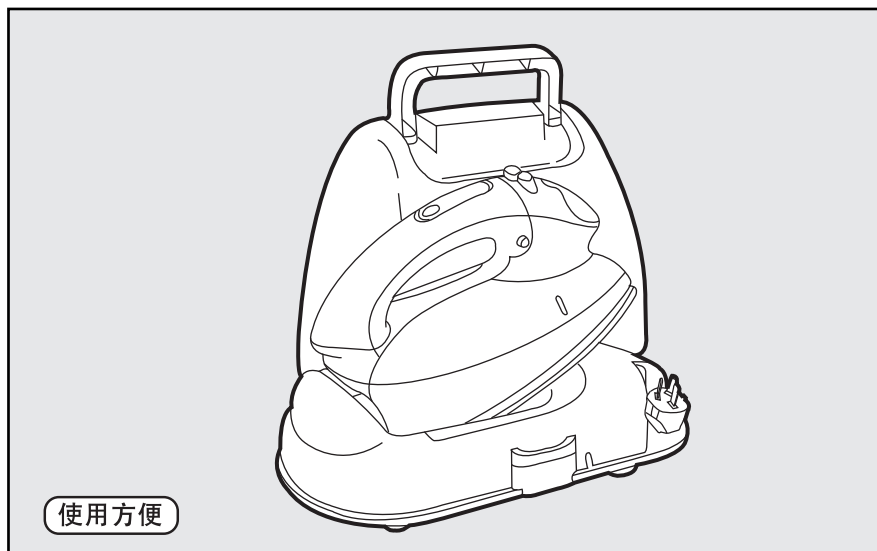

使用方便

衷心感谢使用松下电器蒸汽电熨斗！

为了保证您能正确使用产品，请仔细阅读使用说明书并妥善保管本使用说明书。

Sincerely thanks for using Electric Steam Iron of Matsushita Electric.
Before operating this unit, please read these instructions completely and save these instructions carefully.

松下·万宝（广州）电熨斗有限公司

Panasonic Wanbao Home Appliances Electric Iron (Guangzhou) Co., Ltd.

中国广东省广州市番禺区钟村镇万宝基地 电话：(020) 84773998 84770888
Wanbao Base Zhongcun Town Panyu District Guangzhou City Guangdong Province China

松下电器客户咨询服务热线：800-810-0781

Matsushita Electric customer and service hot line: 800-810-0781

各部位的名称及功能 COMPONENTS IDENTIFICATION

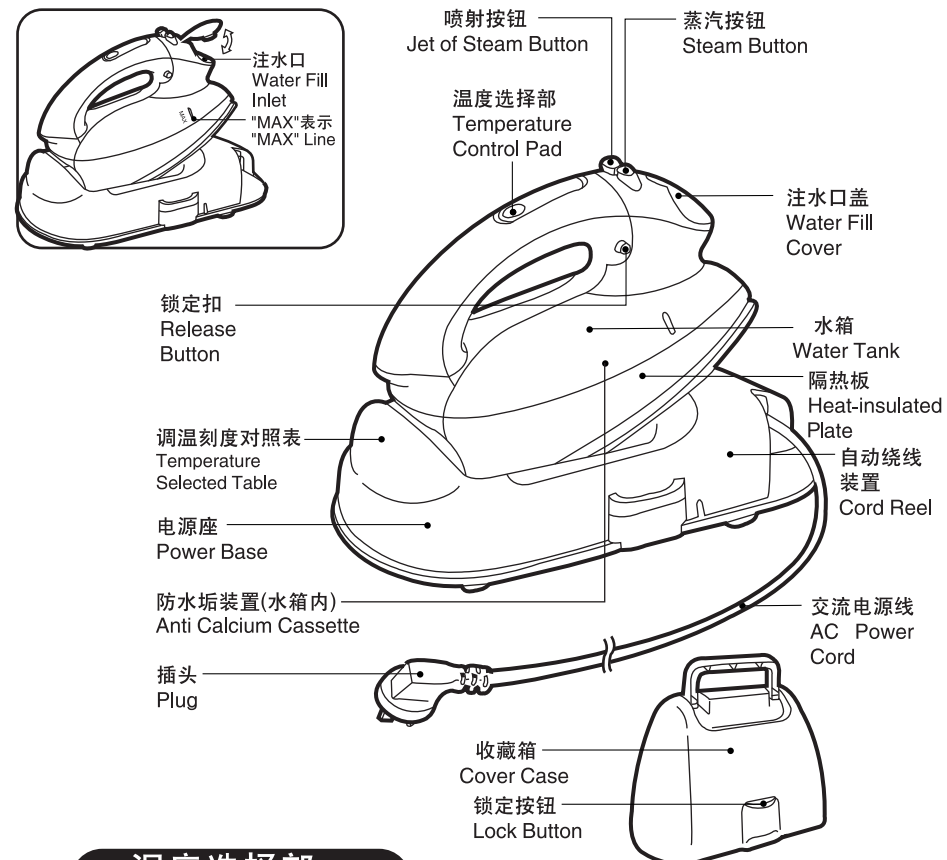

温度选择部 Temperature control pad

1. 温度表示指示灯（红）
Temperature Control Indicator (red)

2. 断开指示灯（绿）
" Off " Indicator (green)

绿灯亮时表示熨斗已断电不再加热，若要再通电，按温度选择按钮至所需要的温度。

The light turns on when the iron has automatically shut itself off, the heater will not work; to reheat your iron, simply push " 设定 " pad until the red light appears at the desired temperature indicator.

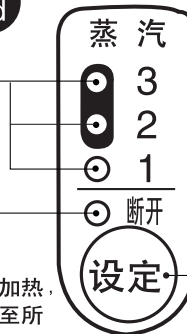

3. 温度选择按钮
Temperature selected button
● 按温度选择按钮时
When push temperature-selected button

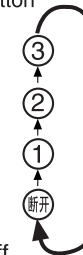

按顺序切换
Regulated as follows

本产品由日本松下电器设计，符合GB4706.2-2003电熨斗标准。

This product is designed by Matsushita Electric in Japan, conforms to GB4706.2-2003 Iron Standard.

规格

额定电源	220V~ 50Hz	功 能	蒸汽/干式熨烫
功 率	1300W	蒸汽产生方式	下滴方式
插头/电源线	单相三极插头/1.6 m活动式	自动温控器	调温范围1-3 (约130℃-200℃)
尺 寸	长约26cm, 宽约17cm, 高约21cm	熨 烫 面 积	约120cm ²
重 量	约1.9kg	贮 水 量	约80ml
放置方式	电源座式	指 示 灯	温控指示灯

安全注意事项

1. 在电熨斗接通电源期间, 使用者不能离开, 并避免让小孩接触熨斗。
2. 不允许用电源线缠绕熨斗底板。
3. 本产品的电源线有任何损坏时, 为了确保安全, 请勿擅自更换电源线, 务必委托本公司的维修站更换。
4. 使用过程中, 应避免底板和隔热板等高温部位接触身体和不耐热物体, 以免烫伤或损坏物体。
5. 给水箱加水时必须拔出插头, 切断电源。
6. 熨斗只能与附送的电源座搭配使用。
7. 本熨斗必须插入带地线连接的电源插座中。
8. 发生异常时(有烧焦、冒烟等)须立即停止使用并拔出插头, 以免造成火灾及触电; 然后向本公司的维修站咨询。
9. 电熨斗损坏或曾经掉落并能看到明显损坏的痕迹或漏水, 用户请不要自行拆机维修, 应送指定维修中心修理, 否则后果自负。
10. 必须用手握住插头进行拉出或收回电线。
11. 电熨斗必须放在稳固的表面。当用电源座放在台面时, 保证下面支撑面是稳固的。
12. 不要在电源线缠结的状态下使用电熨斗, 否则电源线可能会很快被损坏。

警告

不要用手接触高温部(底板表面, 隔热板、水箱下面)。



禁止接触

(会造成烫伤。)



不要让热的蒸汽碰到手或身体其它部位。



(会造成烫伤。)



不熨烫时请将电熨斗放回电源座。

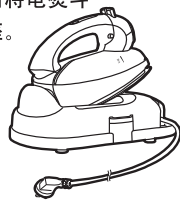

(熨斗倒下会造成受伤、烫伤。)

收线时不要将手放在收线口。



(会被插头夹伤手指。)

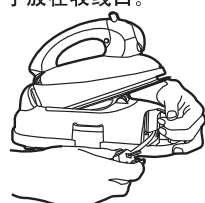

表示警告, 会造成身体受伤、烫伤。



禁止此类情况发生。



请按图示去做。

自动断电功能 当您忘记切断电源时, 可自动断电

- 电熨斗放在底座上静止10分钟后加热电路会自动断电。
- 再通电
 - * 若要再通电, 按温度选择按钮 至所需要的温度。
 - * 在自动断电状态下遇到停电再通电情况时, 电熨斗会处于自动断电状态。

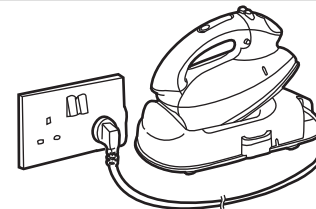

自动断水功能

在底板上面装有自动断水装置, 在使用时, 底板温度低于约110℃时, 自动防漏阀装置就会动作, 将蒸汽水槽封闭, 避免因水滴漏出底板沾污衣物。

此外, 使用后不用通电底板也会自动干燥, 防止底板腐蚀; 电熨斗冷却后即可保存。

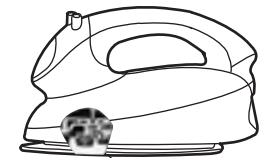

自动断水装置

自动绕线功能

电源座中装有自动绕线装置, 电源线可自动收回。电熨斗使用后, 按下插头, 握住插头将电源线向外拉出约5-10cm; 然后让电线往回卷。此时, 电源线可自动收回。

注意: 收线时, 手不要松开插头, 顺电源线回收方向回送, 以免给插头碰伤。当电源线收不回时, 将电源线向外拉一下再让线往回卷便可收回。

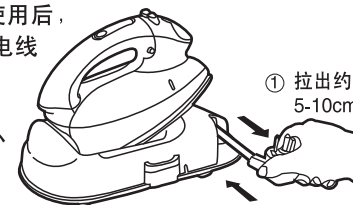

② 慢慢收回

蒸汽电熨斗的使用方法 对于低温, 中温及热敏感布料, 可在衣服不易看到的地方试熨, 必要时垫布熨烫。

- 1 取出收藏箱, 将收藏箱放在桌面上, 往下按住两端的锁定按钮后向上提。



② 取下水箱

- 2 a) 将蒸汽按钮按在“关”位置。
b) 按下锁定扣, 取下水箱。

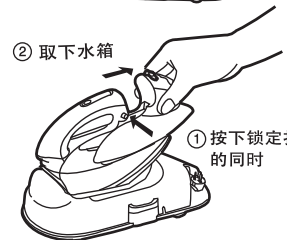

① 按下锁定扣的同时

- 3** a) 打开注水口盖。
b) 注入水至“MAX”刻度。
注意：① 加水时，注意竖立水箱观察水量。加水不要超过“MAX”刻度。
② 要使用干净的自来水。



- 4** a) 关闭注水口盖。
b) 装上水箱。



- 5** 将熨斗确实放入电源座，取下插头保护套，用手握住插头，将电源线从电源座中拉出适当长度，将插头插入电源插座，接通电源。按动温度选择按钮调至蒸汽范围。
注意：拉电源线时，拉出电源线不要超过红色标记。使用喷射蒸汽时，应选择蒸汽刻度范围的“3”位置。低档温度会漏水。

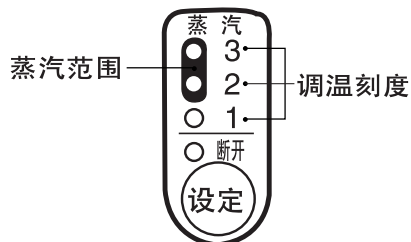

- 6** a) 温度指示灯从闪烁变为常亮后(熨斗在使用过程中，温度下降再加热时，灯不闪烁)。
b) 按蒸汽按钮，选择蒸汽档，即可开始熨衣。
注意：使用过程中，不熨衣时请将熨斗放回电源座加热；以保持所选温度。

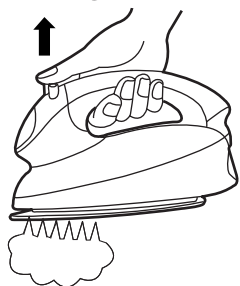

蒸汽按钮（每按一次如下图切换）

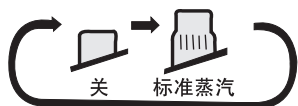

标准蒸汽：适用于蒸汽熨烫的衣物。

7 四倍蒸汽的使用

- ① 适用于特厚布料及难于消除皱折的布料。在使用的同时清洗蒸汽孔。
- ② 开始使用时可能不出蒸汽，空打喷射按钮几次直到蒸汽出来。
- ③ 为了防止热水从底板滴出，按动喷射按钮的间隔不应小于2秒。
- ④ 使用垂直四倍蒸汽时，可将衣物挂在衣架上。将熨斗离开身体远一些，使其靠近衣物但不接触它。熨烫多皱纹的衣物时，用空的手拉紧衣物并隔2秒按动喷射按钮。

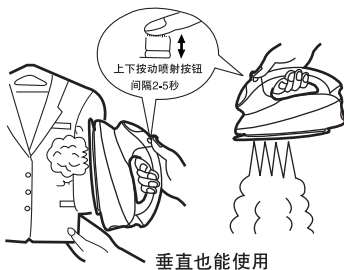

- 注：a) 使用四倍蒸汽功能时，应将蒸汽按钮切换至“关”位置，并将温度选择按钮调至第“3”档，否则可能有水滴出。
b) 不要对人身身体部分和穿在身上的衣服使用四倍蒸汽。

- 8** 无论电熨斗水平或竖立都能清楚观察水量。当水箱中的水较少时，拔出电源插头，取下水箱重新加水，其操作按2-4步骤进行。
- 9** a) 熨衣完毕，按动温度选择按钮至“断开”灯点亮。请拔出插头。
b) 先将蒸汽按钮按在“关”位置，然后按下锁定扣取下水箱。
c) 彻底倒空水箱中的水。
d) 装好水箱，应将蒸汽按钮保持在“关”位置。

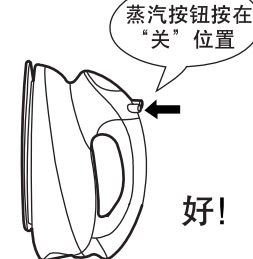

- 10** 电熨斗使用后，在冷却和保管时，应将蒸汽按钮保持“关”位置，将熨斗放回电源座，电源线收回电源座中，插脚向上，盖好插头保护套，将收藏箱垂直压入电源座后放于安全处保管。

注意：收线时，为防止被插头碰伤，请握住插头收线且不要让手碰到电源线。收不进时，将电源线再稍微拉出一点，再让线往回卷便可收回。

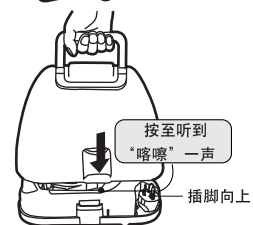

● 即使熨斗是热的也可收藏。

干式电熨斗的使用方法

- 1、如蒸汽熨斗的使用方法1—2步骤一样取出收藏箱，将蒸汽按钮按在“关”位置。
- 2、在熨斗已确实放入电源座的情况下，将插头插入电源插座，接通电源。
- 3、根据自立底座上的《调温刻度对照表》，按动温度选择按钮调至适当的温度位置，待温度指示灯从闪烁变为常亮后，即可开始熨衣。
- 4、熨衣完毕，请即拔出插头，将熨斗放回电源座，电源线收回电源座中，盖好插头保护套，将收藏箱垂直压入电源座后放于安全处保管。

衣物纤维及熨衣方式

- 注意：1. 对于热敏感的布料，应垫布在衣物上熨烫，以免变形或损坏。
2. 熨烫纺织品时，应根据耐热性较差的纤维来选择温度。
3. 熨不同布料的衣物时，先熨烫耐热性较差的衣物。

衣物纤维	温度设定	较好的熨衣方式
腈纶 醋酸纤维	1	干熨衣物里面或垫布在衣物上熨烫。
尼龙 丝绸		干熨衣物里面
涤纶 人造丝	2	干熨衣物背面；熨衣领、衣袖、口袋时，可轻轻地熨烫衣物正面。
羊毛 绒		轻轻地熨烫衣物正面。
棉布 亚麻	3	宜采用蒸汽熨烫，对黑色衣物应熨背面，以免出现“镜面”现象。

保养方法

拔出插头，待电熨斗充分冷却后

- 用软布擦拭电熨斗底板及其他部份。
- 出现较严重的污渍时，可用软布沾中性洗涤剂擦拭。

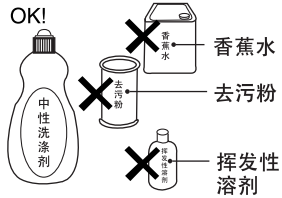

自动清洗

- 利用四倍蒸汽清洗底板和蒸汽孔。参照P4的《四倍蒸汽的使用》，多次按动喷射按钮直到蒸汽喷出。

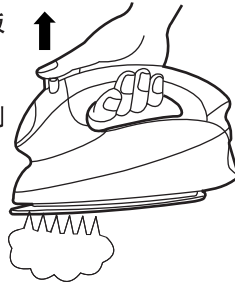

常见故障及处理方法一览表

(请参照本表格进行检查)

检查部位	插头	温度选择部	蒸汽按钮	喷射按钮	蒸汽孔	排水方法	调温指示对照表
故障							
不出蒸汽	○	○	○		○		
蒸汽量太小		○	○		○		
蒸汽孔漏水	○	○		○			
熨烫表面腐蚀						○	
不发热	○	○					
布料烧焦萎缩		○					○
处理方法 (不能处理时与销售店联系)	是否插好熨斗是否确实插入电源座	确认位置是否正确	来回2-3次按蒸汽按钮、回复到蒸汽位置。保管时按在干式位置。	按按钮的间隔在2-3秒	参考<保养方法>进行清洁处理	冷却前未进行排水	根据指示适当设定温度。垫布在衣物上熨烫。

售后服务

关于售后服务等，如有不明白之处，请向销售店或致电800-810-0781咨询

① 保修证 (另附)	在购买本产品时从销售店领取，阅读完后，妥善保管。必须确认保修证上是否记载了 [购买日期、销售店名] 等。
② 需要修理时	按上述表格自我检查后仍然不能处理时，请与销售店或维修店联系。
保修期内	按保修证规定，向销售店提交需修电熨斗及保修证。
超过保修期内	向销售店要求修理，按规定进行收费修理。如不在销售店修理，请向附近的松下修理站联系。

SPECIFICATION

Rated voltage	220V~ 50Hz	Function	steam / dry iron
Power	1300W	Steam generation way	drop
Plug/Cords	single-phase three pole plug(1.6m long)	Thermostat	temperature range:1-3(130℃-200℃)
Dimensions	26cm long 17cm width 21cm height	Iron surface	about 120cm ²
Weight	about 1.9kg	Reservoir capacity	about 80ml
Stand mode	power base	Lamp	temp-control lamp

SAFETY NOTICE

1. Do not leave the iron unattended while it is connected to the electrical source. Keep it away from children.
2. Do not loop cord around iron soleplate.
3. If the supply cord is damaged it must be replaced by our service agent in order to avoid a hazard.
4. During operating, should prevent such high-temperature parts as the soleplate or heat-insulated plate etc., from contacting body and thermo-labile objects so as not to avoid scald or damage of objects.
5. Should unplug and cut off the power supply before you add in or empty out water from water tank.
5. This iron must be filled or emptied only when the power plug is disconnected.
6. This iron must be used with its Power Base.
7. This iron must use the electrical outlet with earth connection.
8. Should stop using and pull out the plug immediately while abnormal occurs (such as scorch, smoke etc.) to avoid fire or electric shock, then contact with our service agent.
9. If the iron was damaged or has been dropped and there are visible signs of damage or if it is leaking. Do not repair the iron by yourself, it should be repaired by the designated service center ; otherwise the user should take all responsibilities of damage.
10. Always hold the plug while pulling or retracting the power cord.
11. The iron must be used and rested on a stable surface. When placing the iron on its power base, ensure that the surface under the power base is stable.
12. Do not use the appliance with the cord in tangled condition .The supply cord might be damaged soon.

Warning

Don't touch the high temperature parts(such as soleplate surface, heat-insulated plate, underside of the water tank).



Don't touch.
(May be scalded.)



Don't touch the hot steam with your hands or other parts of your body.



(May be scalded.)



Please put the iron back to Power Base while not ironing.

(To avoid scratch on the surface or hurt by the dropped iron.)



Don't put the hand inside the rewind inlet.



(Finger may be hurt by plug.)

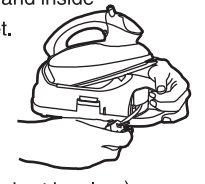

Warning: May be scalded or hurt.



Prohibit such accident occurring.



Operating according to the drawing.

AUTOMATIC SHUT-OFF

When you forget shutting off power, it will automatically shut off.

- The iron will automatically shut itself off if the iron has been left on the Power Base more than 10 minutes.
- Turn iron back on
 - * To turn the iron back on to resume ironing, simply push "设定" pad until the red light appears at the desired temperature indicator.
 - * At the situation of Auto Shut-off, if the supply power shuts off, after electricity resume, the iron will at the situation of shut off.

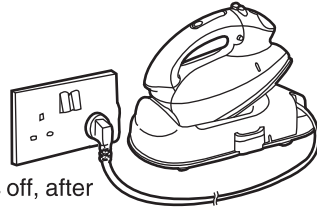

AUTOMATIC WATER SEAL

Auto-valve system built-in the soleplate, when the temperature of the soleplate drops below 110°C, the valve for the vaporizing chamber in the iron automatically closes and stops the water from going in further. This prevents from water spitting out the soleplate, staining the cloth.

Besides it is unnecessary for you to heat the soleplate again and it will automatically dry, store the iron when it cools down.

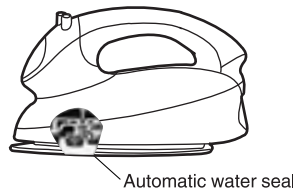

Automatic water seal

HOW TO RETRACT POWER CORD

The automatically retracted cord device built-in the Power Base, Power cord can be retracted automatically, when after ironing, hold the plug and pull the cord out about 5-10 cm, let the cord rewind itself; then power cord can be retracted totally.

Notice: When retracting power cord, always grasp the plug as this may cause the cord to " whip " and cause injury. If the power cord seems hard to rewind pull it out slightly and wind it again while guiding it into Power Base.

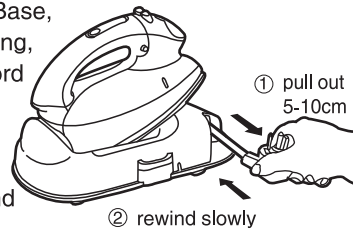

HOW TO USE AS A STEAM IRON

(For low, medium temperature and heat-sensitive fabric, try to iron invisible place of fabric; If necessary use a press cloth on top of fabric.)

- 1 Remove the cover case, place the unit on a firm and stable place. Press the lock button down, lift the cover case to open.
- 2 a) Press the steam button down to "关" position.
b) Press the water tank release button; take out the water tank.

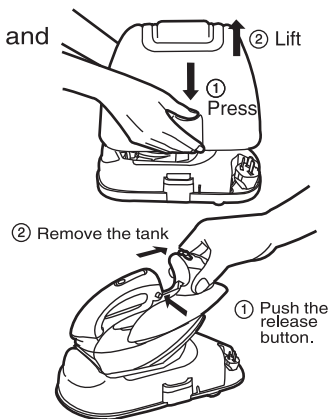

- 3 a) Open the water fill cover.
b) Fill the tank up to " MAX " line.

Notice: ① Observe the volume of water at upright position, do not overfill above " MAX " indication.

② Using pure tap water.

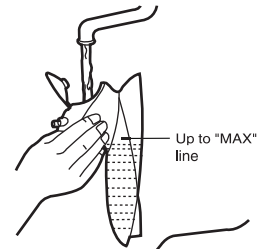

- 4 a) Close the water fill cover.
b) Re-install the water tank to the main unit.

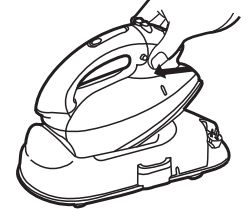

- 5 Set the iron on the Power Base securely take out plug protector. Plug the AC cord into electrical outlet; connect to power supply.

Push the " 设定 " pad until the red light for steam zone starts blinking.

Notice: While pulling out cord, do not exceed the " red " mark on the cord. When use jet of steam, please set the temperature selector dial to " 3 " zone.

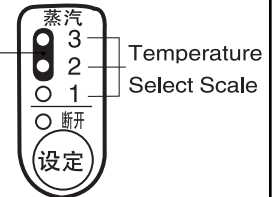

- 6 a) Preheat the iron until the indicator light change from blink to illumination while the iron being use, it reheat itself when the temperature decline, the light doesn't blink.

b) Press steam button, select steam function; and start to iron.
Notice: During operating please set the iron back to power base while you don't iron clothes, the power base will keep the temperature of the iron at the selected level.

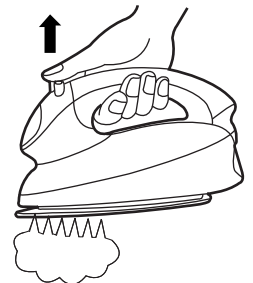

Steam button (switch as the following)

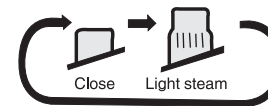

Light steam: For ironing fabrics requiring steam.

- 7 How to use the jet of steam feature

- ① For fabrics thick materials or with stubborn wrinkles, and cleaning the steam vents at the same time.
- ② Pump the jet of steam button several times before using for the first time at each ironing session.
- ③ The interval should not less than 2 seconds when using the jet of steam, to avoid the hot water dripping from the soleplate.
- ④ When using vertical steam, hang the garment on a clothes hanger. Hold the iron away from your body close to but not touching the fabric. Pull the fabric tight with your free hand

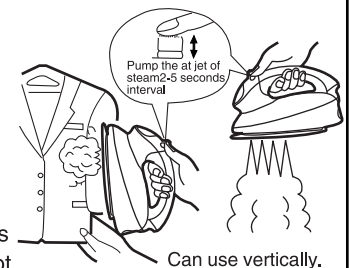

and after 2 seconds press the jet of steam button .

Notice: a) When using jet of steam, keep the steam button in the close position, and set the temperature selector dial to " 3 " zone, or some water will drop from iron.

b) Never iron clothes on the body or point your iron at anyone when steaming.

8 The water volume can be observed very clearly whatever in vertical or horizontal position. Please pull out the plug when the volume of water is low, and refill the iron according to the step 2-4.

9 a) After ironing, push the " 设定 " pad until the " 断开 " light turns on, pullout plug.

b) Depress the steam button down into the close position, press the water tank release button, take out the water tank.

c) Empty water from water tank.

d) Re-install water tank, keep the steam button in the close position.

10 After ironing, while cool down and store; always keep the steam button in the close position; set the iron back to Power Base, rewind the cord into Power Base.

11 Cover the plug protector, press the cover case vertically until heard the sound clicks; then store the iron at safe place.

Notice: When retracing power cord, for preventing from injury by plug, always grasp the plug and do not touch the cord.

If the power cord seems hard to rewind pull it out slightly and wind it again.

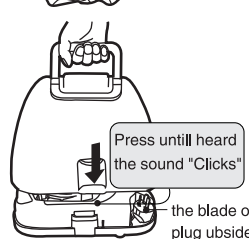
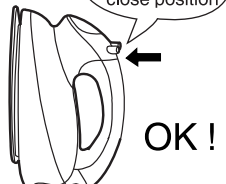
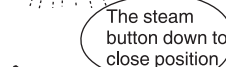
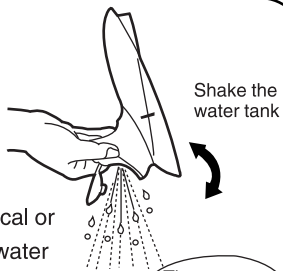

HOW TO USE AS A DRY IRON

1. Remove the cover case same as step 1-2 of " How to use as a steam iron ". Press the steam button down to "close" position.
2. Set the iron on the Power Base securely, plug the AC cord into electrical outlet; connect to power supply.
3. According to <temperature selected table> push temperature selected button to the desired position. Preheat the iron until the indicator light change from blink to illumination, and start to iron.
4. After ironing, pullout plug, set the iron back to Power Base, rewind cord into Power Base, cover plug protector, push the cover case vertically until heard the sound clicks; then store the iron at safe place.

FABRIC AND IRONING RECOMMENDATIONS

- Notes : 1. For heat-sensitive fabric, try to iron using a press cloth on top of fabric, otherwise it will ruin or damage.
 2. Iron belended fabrics, setting temperature for lower-temperature fiber.
 3. Iron clothes with worse heat resistance first while ironing the different kinds of cloth.

Fabric	Temperature setting	Ironing recommendations
ACRYLIC	1	Dry iron on reverse side, or use a press cloth on top of fabric.
ACETATE		
NYLON	2	Dry iron on reverse side.
SILK		
POLYESTER	3	Dry iron on reverse side. To touch-up collars, cuffs, pockets, etc., iron lightly on right side.
RAYON		
WOOL		
VELVET	3	Iron lightly on right side.
COTTON		
LINEN	3	Steam ironing is suggested, iron dark fabrics on reverse side to avoid unwanted sheen.

MAINTENANCE

Unplug iron, wait until iron cools completely.

- Wipe off iron soleplate and other part with a damp and soft cloth.
- For serious stain, use a neutral detergent.

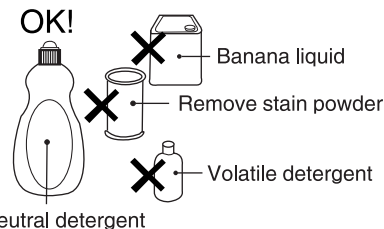

Self-cleaning

- Cleaning the steam chamber of soleplate and steam vents with jet of steam, according to 《How to use the jet of steam feature》 (P9), pump the jet of steam button several times until steam is invisible.

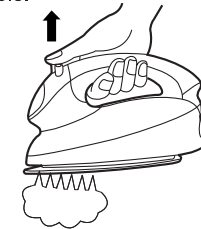

GENERALLY MALFUNCTION AND TACKLING METHOD (please check with this table)

Check	Plug	Temperature control pad	Steam button	Jet of steam button	Steam hole	The way of drainage	Temperature select indicator
Malfunction							
No steam	○	○	○		○		
Too small steam		○	○		○		
Dripping	○	○		○			
Corroding						○	
No heat	○	○					
Scorch		○					○
Dealing method (Contact with sales agent if can't deal with)	Connect well?	Position is correct?	Press steam button 2-3 times, reset to steam position, keep on close position while storing.	The interval time of pressing button should be 2-3 seconds.	Cleaning according to "MAIN-TENANCE".	Drainage before the iron cooling.	Select temperature accord indication or use a press cloth.

AFTER SERVICE

For after service, if there are any questions, please inquiry to shop or telephone 800-810-0781.

① Warranty card (append)	Get the warranty card from shop when purchases this product. Read completely and store carefully, confirm the warranty card have been recorded [purchased date, name of the shop etc.].
② Require repairing	Contact with sales agent if can't deal according to above table.
Warranty period	According to the warranty card, provide the shop with the electric iron and warranty card.
Exceed Warranty period	Repair by sales agent, it will be charged according to regulations, if repair by others, please contact with the nearby service agent.